



203 SERIES

TGW

CARBON STEEL & SS316

TECHNICAL SPECIFICATIONS

Features: Designed for high pressure and impulse applications.

Working Pressure: Up to 950 Bar

Materials: Body: Carbon Steel EN -10277-3
Stainless Steel 316

O-rings: NBR / VITON / EPDM

Back-up-ring: PTFE

Springs: EN-10270-1/SH

Balls: -

Available Threads: BSP / NPTF*

Closing System: Poppet Valve or ball

Connection/Disconnection: Screw on / off both parts

Connection Under Pressure: Residual Pressure

Available Size: 1/4" a 2"

Working Temperature (O-rings)

NBR	Viton	EPDM
+100°C	+200°C	+150°C
-30°C	-10°C	-40°C

Sectors: Industrial



Applications: Designed for Hydraulic Oil (Group II-2014/68/EU)

Interchange: GROMELLE 6000 / EATON W6000

*Others on request and minimum quantity.

MODEL REFERENCE

Example:

203.11115 AF

Series	Material	Part	Closing	O-rings	Size (S)	Thread
203.	1 Carbon St.	1 Male	0 Without	0 Without	1 6	1/4"
	2 SS316	2 Female	1 Poppet	1 NBR	2 10	3/8"
			2 Ball	2 VITON	3 13	1/2"
				3 EPDM	4 20	3/4"
					5 25	1"
					6 32	1 1/4"
					7 40	1 1/2"
					8 50	2"

2 letters (see Thread Table on page 999-1)



203 SERIES TGW

CARBON STEEL

INTEVA

(S) 6 - 1/4"

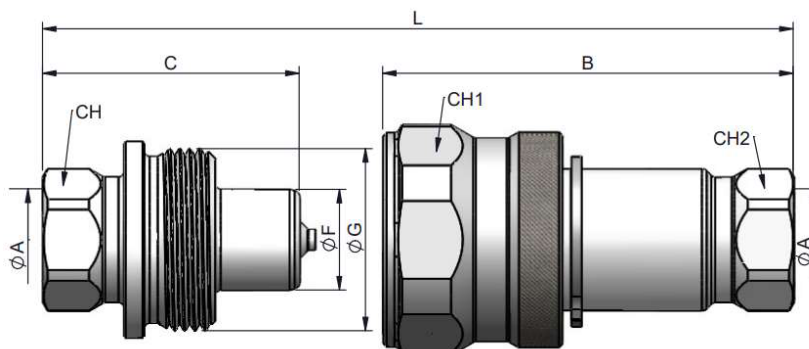

STANDARD MALE MODELS

(S)	ØA	REF.		CH	C	ØF	ØG	L
6	1/4" BSP	203.11111AB		19	40	20	M27x1.5	80
	1/4" NPTF	203.11111BB						

STANDARD FEMALE MODELS

(S)	ØA	REF.		CH2	B	CH1	L
6	1/4" BSP	203.12111AB		19	63	32	80
	1/4" NPTF	203.12111BB					

(S) 10 - 3/8"

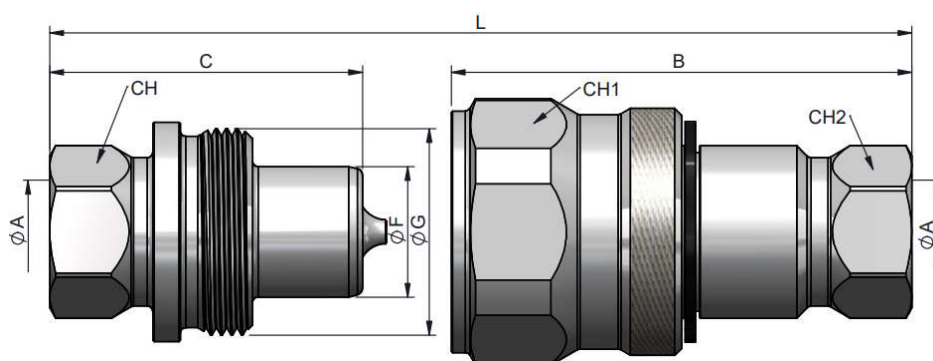

STANDARD MALE MODELS

(S)	ØA	REF.		CH	C	ØF	ØG	L
10	3/8" BSP	203.11112AC		22	45.50	20	M30x1.5	81
	3/8" NPTF	203.11112BC						

STANDARD FEMALE MODELS

(S)	ØA	REF.		CH2	B	CH1	L
10	3/8" BSP	203.12112AC		22	67	36	81
	3/8" NPTF	203.12112BC					



203 SERIES TGW

CARBON STEEL



(S) 13 - 1/2"

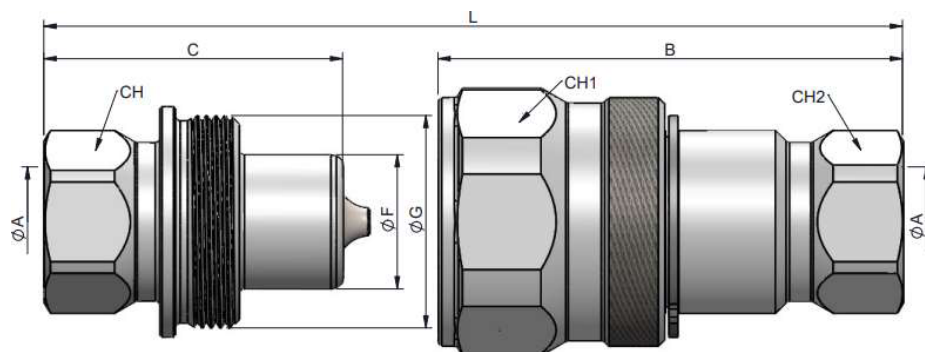

STANDARD MALE MODELS

(S)	ØA	REF.		CH	C	ØF	ØG	L
13	1/2" BSP	203.11113AD		38	49	20	M35x1.5	98
	1/2" NPTF	203.11113BD						

STANDARD FEMALE MODELS

(S)	ØA	REF.		CH2	B	CH1	L
13	1/2" BSP	203.12113AD		27	76	41	98
	1/2" NPTF	203.12113BD					

(S) 20 - 3/4"

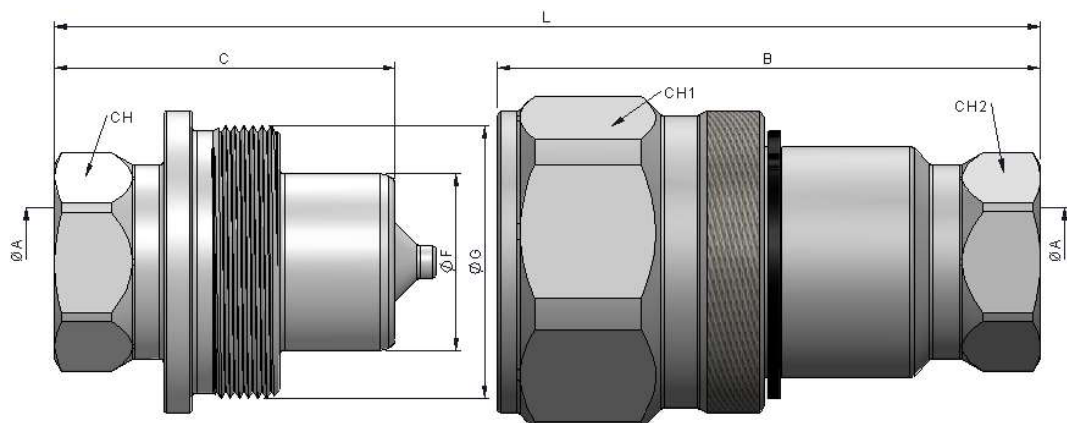

STANDARD MALE MODELS

(S)	ØA	REF.		CH	C	ØF	ØG	L
20	3/4" BSP	203.11114AE		32	56	29	M45x1.5	112
	3/4" NPTF	203.11112BE						

STANDARD FEMALE MODELS

(S)	ØA	REF.		CH2	B	CH1	L
20	3/4" BSP	203.12114AE		32	89	50	112
	3/4" NPTF	203.12114BE					



203 SERIES TGW

CARBON STEEL



(S) 25 - 1"

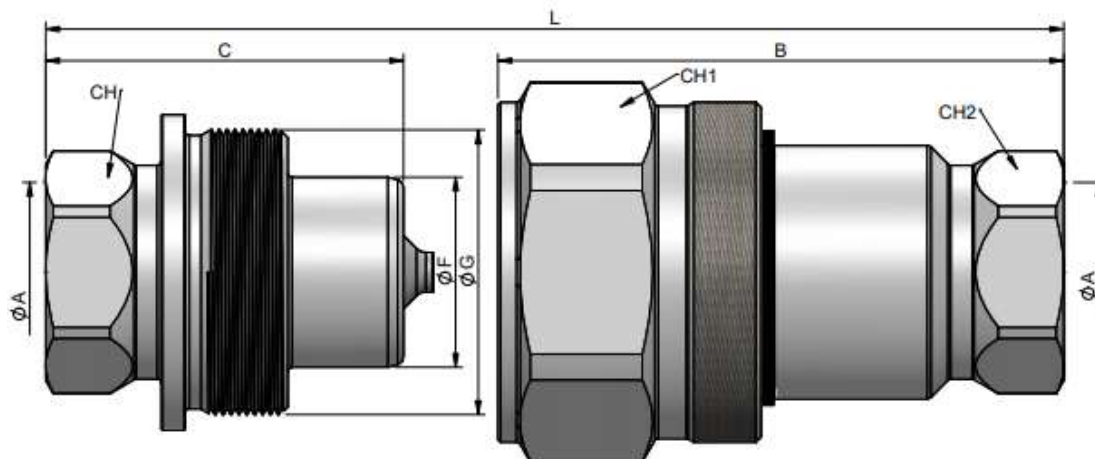

MALE STANDARD MODELS

(S)	ØA	REF.		CH	C	ØF	ØG	L
25	1" BSP	203.11115AF	450	41	68	36	M54x1.5	136
	1" NPTF	203.11115BF						

FEMALE STANDARD MODELS

(S)	ØA	REF.		CH2	B	CH1	L
25	1" BSP	203.12115AF	450	41	107.5	65	136
	1" NPTF	203.12115BF					

(S) 32 - 1 1/4"

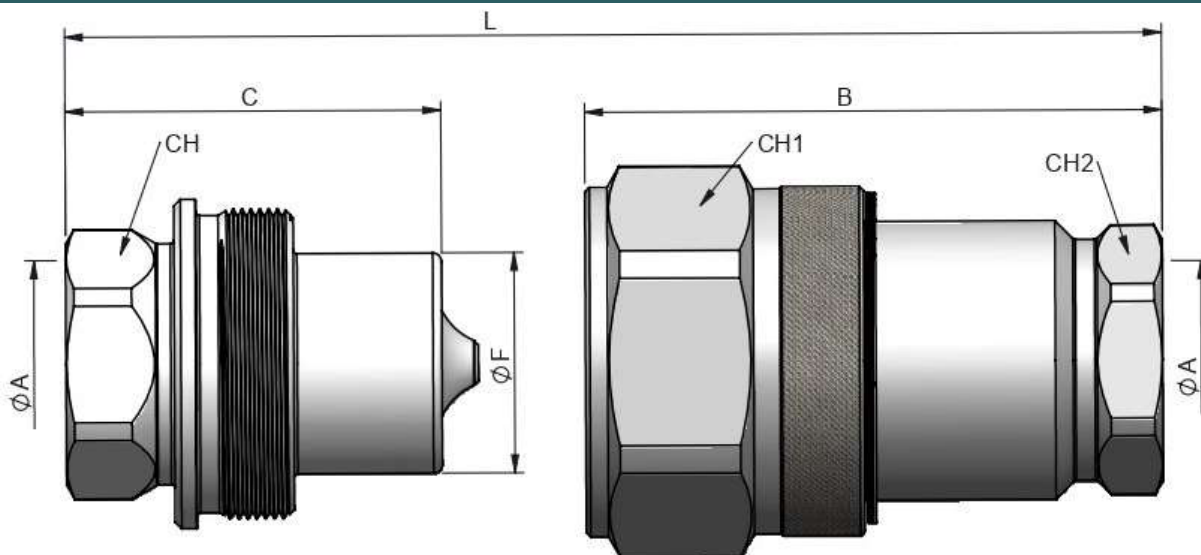

MALE STANDARD MODELS

(S)	ØA	REF.		CH	C	ØF	ØG	L
32	1 1/4" BSP	203.11116AG	450	75	85	50	M70x2	160
	1 1/4" NPTF	203.11116BG						

FEMALE STANDARD MODELS

(S)	ØA	REF.		CH2	B	CH1	L
32	1 1/4" BSP	203.12116AG	450	55	130.5	80	160
	1 1/4" NPTF	203.12116BG					



203 SERIES TGW

CARBON STEEL



(S) 40 - 1 1/2"

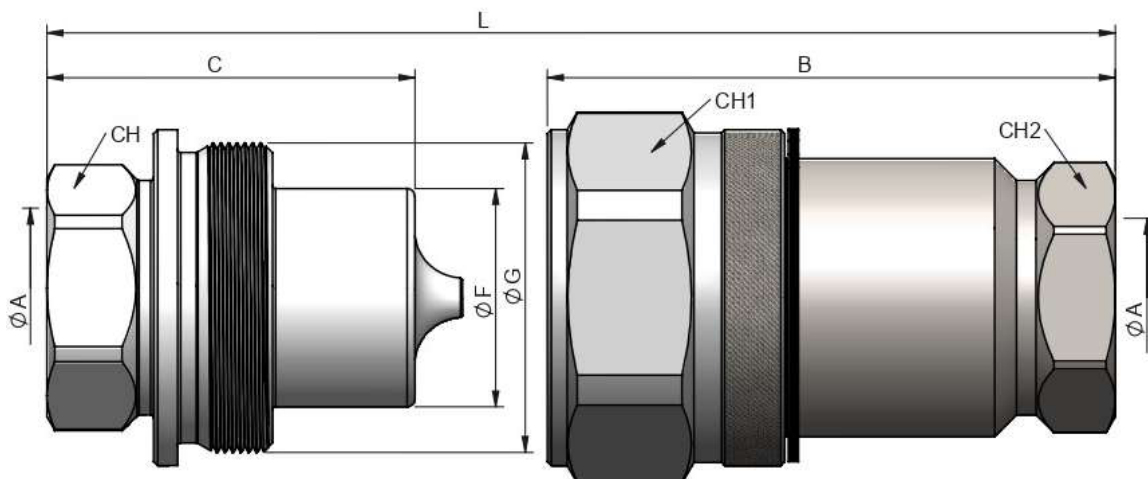

STANDARD MALE MODELS

(S)	ØA	REF.		CH	C	ØF	ØG	L
40	1 1/2" BSP	203.11117AH		60	93	55	M78x1.5	176.5
	1 1/2" NPTF	203.11117BH						

STANDARD FEMALE MODELS

(S)	ØA	REF.		CH2	B	CH1	L
40	1 1/2" BSP	203.12117AH		60	143.5	85	176.5
	1 1/2" NPTF	203.12117BH					

(S) 50 - 2"

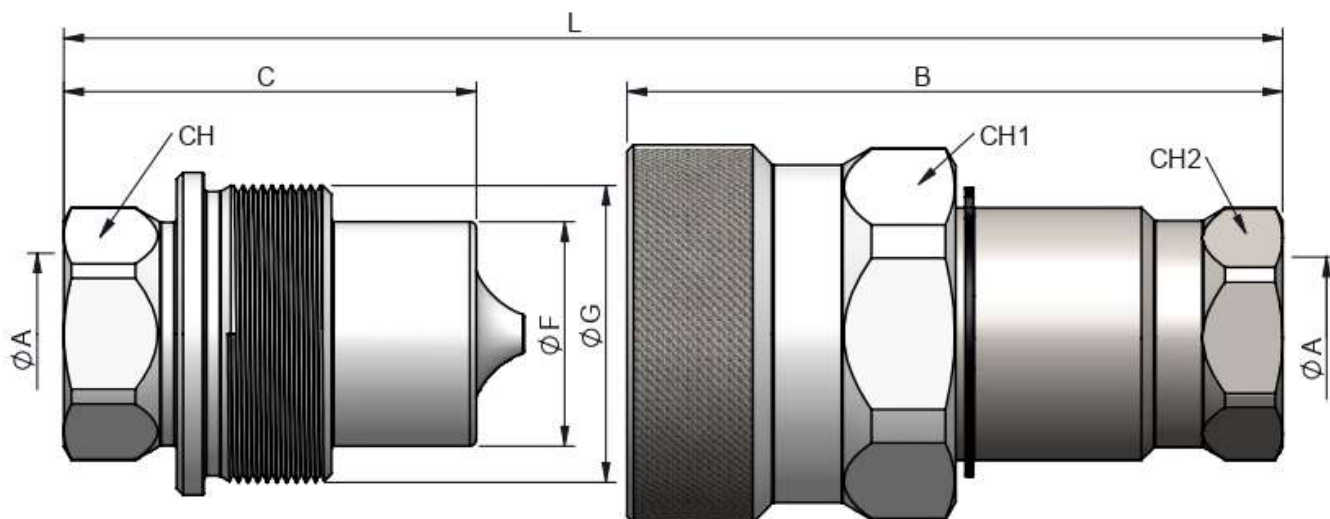

STANDARD MALE MODELS

(S)	ØA	REF.		CH	C	ØF	ØG	L
50	2" BSP	203.11118AI		70	128	69.5	M93x3	247
	2" NPTF	203.11118BI						

STANDARD FEMALE MODELS

(S)	ØA	REF.		CH2	B	CH1	L
50	2" BSP	203.12118AI		70	203.5	105	247
	2" NPTF	203.12118BI					



203 SERIES TGW

CARBON STEEL

TECHNICAL DATA

(S)	Rated Flow	Min. Burst Pressure (bar)			Max. Working Pressure
		Male	Female	Connected	
6	18 l/m	1960	1960	1960	980
10	38 l/m	1500	1500	1500	750
13	62 l/m	1500	1500	1500	750
20	116 l/m	1300	1300	1300	650
25	194 l/m	900	900	900	450
32	290 l/m	900	900	900	450
40	450 l/m	600	600	600	300
50	630 l/m	600	600	600	300

Test performed according to ISO 18869

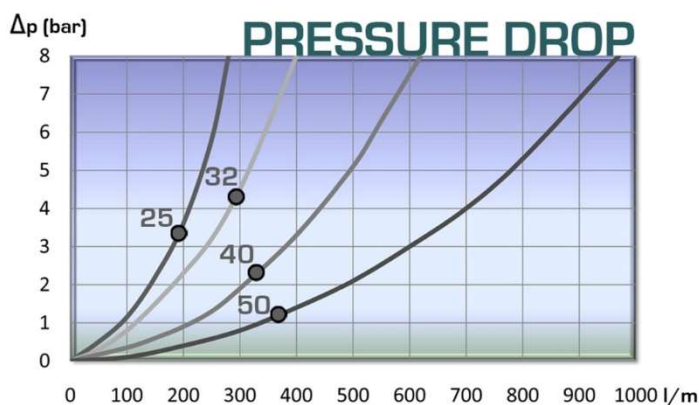
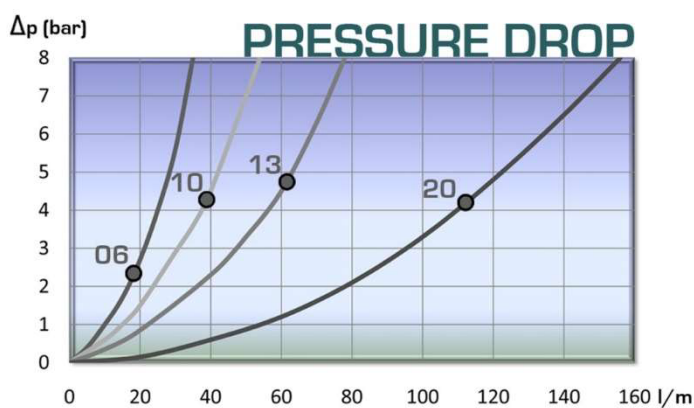



203 SERIES TGW SS316



(S) 6 - 1/4"

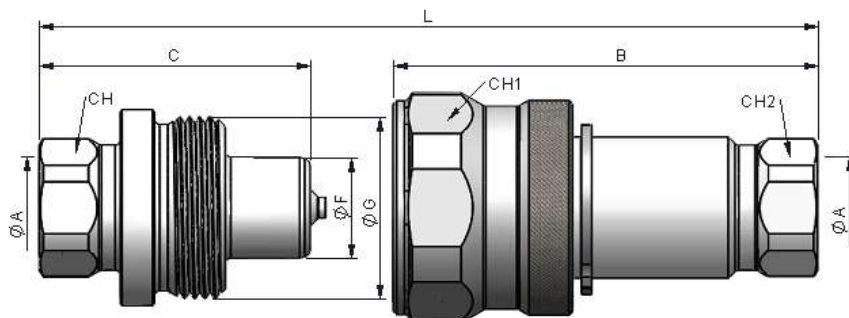

MALE STANDARD MODELS

(S)	ØA	REF.		CH	C	ØF	ØG	L
6	1/4" BSP	203.21121AB		19	40	20	M27x1.5	80
	1/4" NPTF	203.21121BB						

FEMALE STANDARD MODELS

(S)	ØA	REF.		CH2	B	CH1	L
6	1/4" BSP	203.22121AB		19	63	32	80
	1/4" NPTF	203.22121BB					

(S) 10 - 3/8"

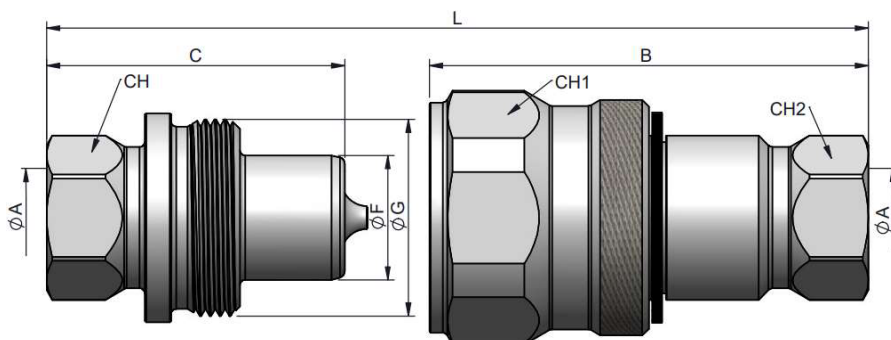

MALE STANDARD MODELS

(S)	ØA	REF.		CH	C	ØF	ØG	L
10	3/8" BSP	203.21122AC		22	40.5	20	M30x1.5	81
	3/8" NPTF	203.21122BC						

FEMALE STANDARD MODELS

(S)	ØA	REF.		CH2	B	CH1	L
10	3/8" BSP	203.22122AC		22	67	36	81
	3/8" NPTF	203.22122BC					



203 SERIES TGW SS316



(S) 13 - 1/2"

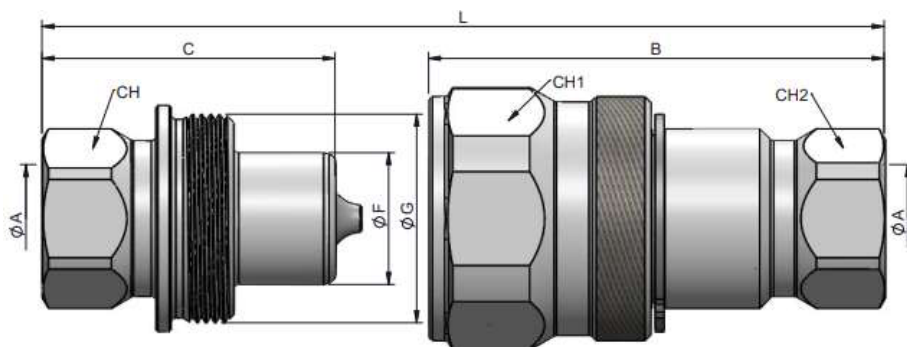

STANDARD MALE MODELS

(S)	ØA	REF.		CH	C	ØF	ØG	L
13	1/2" BSP	203.21123AD		38	49	20	M35x1.5	98
	1/2" NPTF	203.21123BD						

STANDARD FEMALE MODELS

(S)	ØA	REF.		CH2	B	CH1	L
13	1/2" BSP	203.22123AD		27	76	41	98
	1/2" NPTF	203.22123BD					

(S) 20 - 3/4"

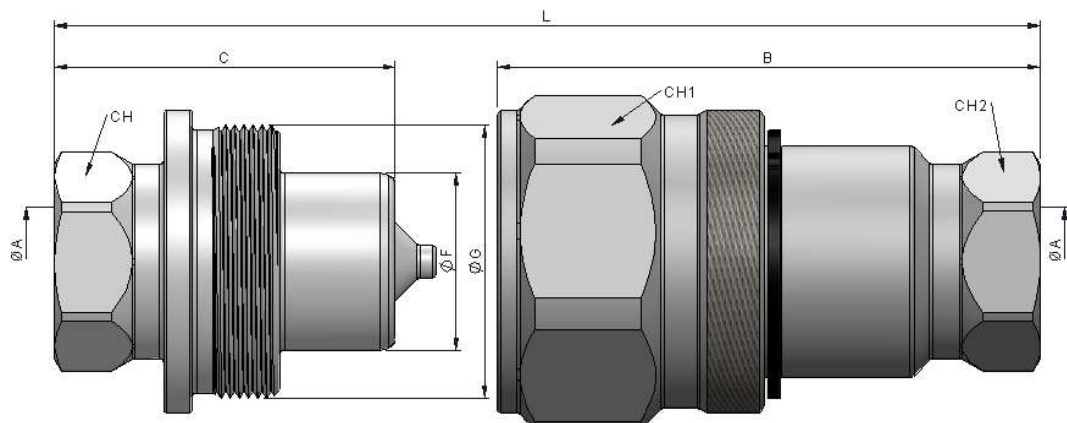

STANDARD MALE MODELS

(S)	ØA	REF.		CH	C	ØF	ØG	L
20	3/4" BSP	203.21124AE		32	56	29	M45x1.5	112
	3/4" NPTF	203.21124BE						

STANDARD FEMALE MODELS

(S)	ØA	REF.		CH2	B	CH1	L
20	3/4" BSP	203.22124AE		32	89	50	112
	3/4" NPTF	203.22124BE					



203 SERIES TGW

SS316



(S) 25 - 1"

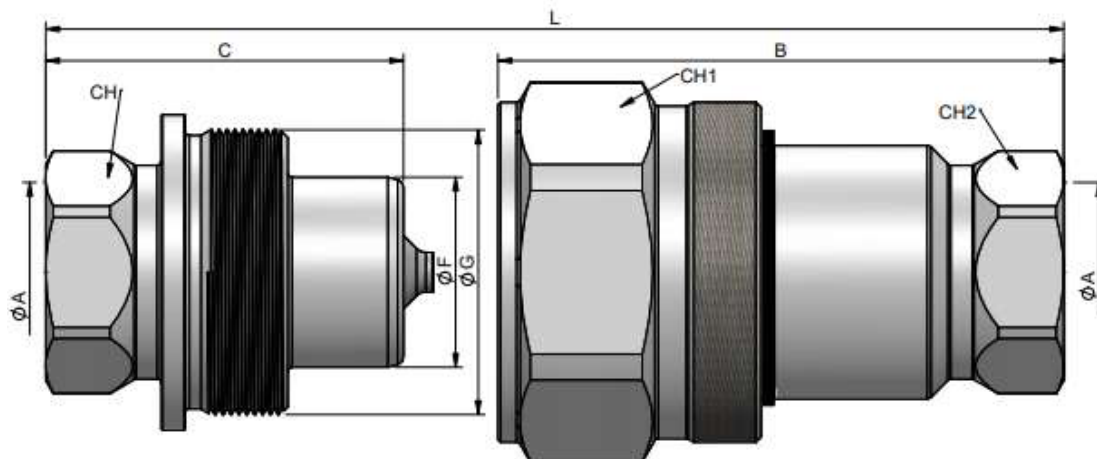

STANDARD MALE MODELS

(S)	ØA	REF.		CH	C	ØF	ØG	L
25	1" BSP	203.21125AF	450	41	68	36	M54x1.5	136
	1" NPTF	203.21125BF						

STANDARD FEMALE MODELS

(S)	ØA	REF.		CH2	B	CH1	L
25	1" BSP	203.22125AF	450	41	107.5	65	136
	1" NPTF	203.22125BF					

(S) 32 - 1 1/4"

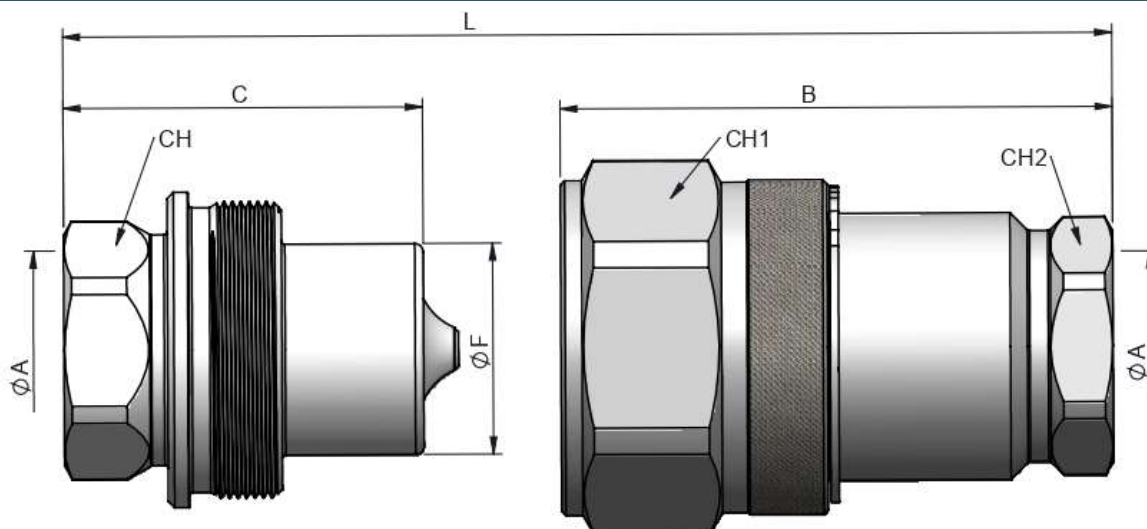

STANDARD MALE MODELS

(S)	ØA	REF.		CH	C	ØF	ØG	L
32	1 1/4" BSP	203.21126AG	450	75	85	50	M70x2	160
	1 1/4" NPTF	203.21126BG						

STANDARD FEMALE MODELS

(S)	ØA	REF.		CH2	B	CH1	L
32	1 1/4" BSP	203.22126AG	450	55	130.5	80	160
	1 1/4" NPTF	203.22126BG					



203 SERIES TGW



SS316

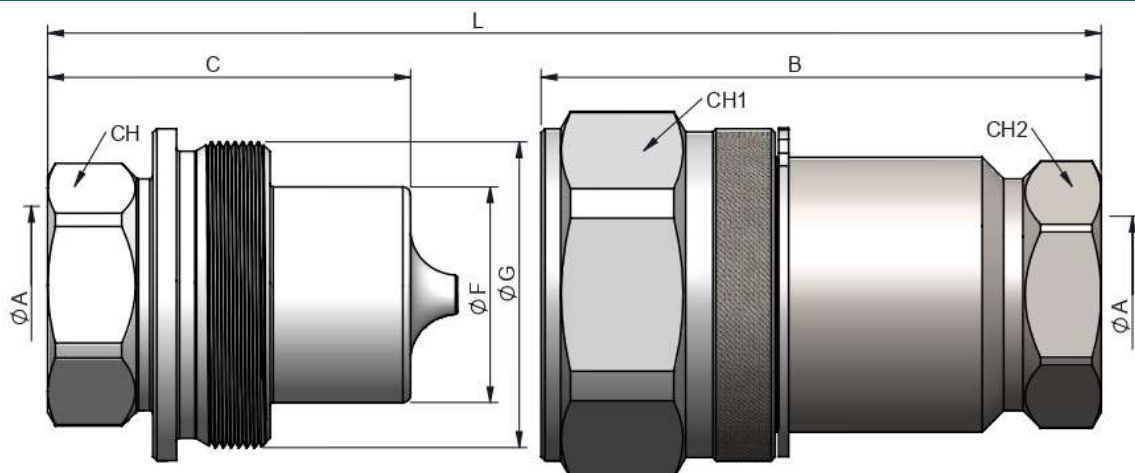

(S) 40 - 1 1/2"



STANDARD MALE MODELS

(S)	ØA	REF.		CH	C	ØF	ØG	L	
40	1 1/2" BSP	203.21127AH		300	60	93	55	M78x1.5	176.5
	1 1/2" NPTF	203.21127BH							



STANDARD FEMALE MODELS

(S)	ØA	REF.		CH2	B	CH1	L
40	1 1/2" BSP	203.22127AH	300	60	143.5	85	176.5
	1 1/2" NPTF	203.22127BH					

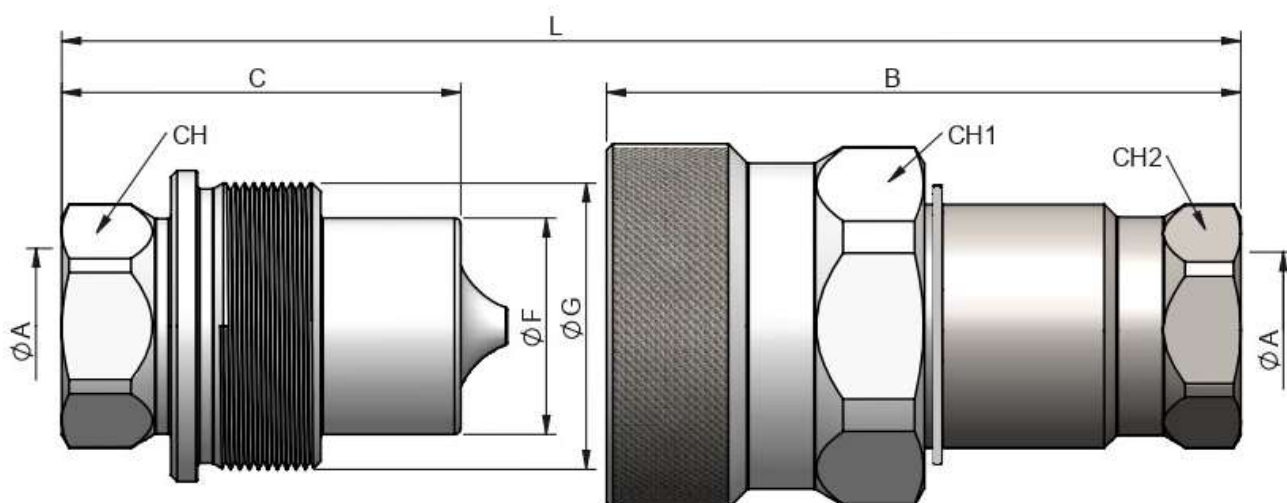
(S) 50 - 2"



STANDARD MALE MODELS

(S)	ØA	REF.		CH	C	ØF	ØG	L	
50	2" BSP	203.21128AI		300	70	128	69.5	M93x3	247
	2" NPTF	203.21128BI							

STANDARD FEMALE MODELS

(S)	ØA	REF.		CH2	B	CH1	L
50	2" BSP	203.22128AI	300	70	203.5	105	247
	2" NPTF	203.22128BI					

203-10

INTEVA reserves the right to make modifications to its products without prior notice. Any external or internal alterations to our products will automatically void the warranty.





203 SERIES TGW

SS316



TECHNICAL DATA

(S)	Rated Flow	Min. Burst Pressure (bar)			Max. Working Pressure
		Male	Female	Connected	
6	18 l/m	1960	1960	1960	980
10	38 l/m	1500	1500	1500	750
13	62 l/m	1500	1500	1500	750
20	116 l/m	1300	1300	1300	650
25	194 l/m	900	900	900	450
32	290 l/m	900	900	900	450
40	450 l/m	600	600	600	300
50	630 l/m	600	600	600	300

Test performed according to ISO 18869

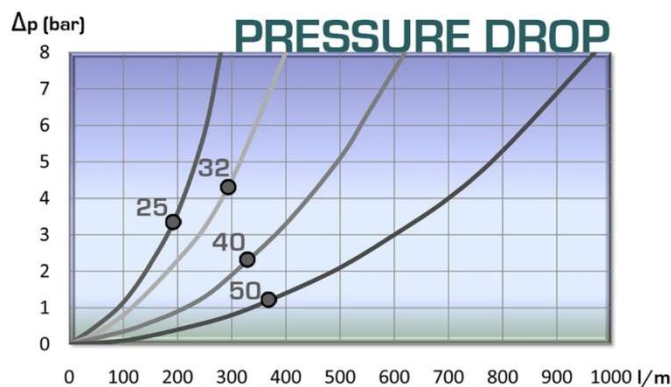
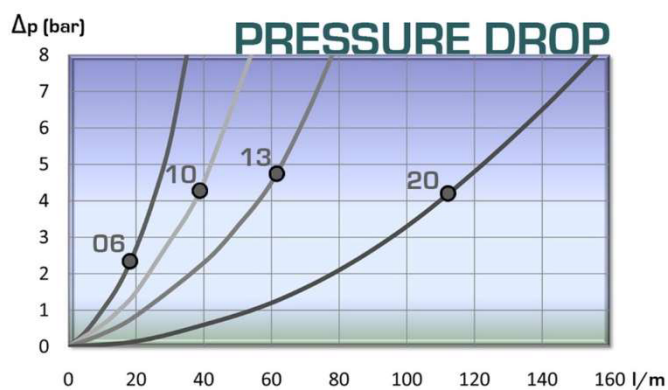



203 SERIES TGW

CAPS &
PLUGS

INTEVA

Designed to protect the female (coupler) and male (nipple) parts while disconnected.

MODEL REFERENCE

Example:

203.6404 AA

Series	Material	Part	Color	Size (S)	Standard
203.	6 Aluminum	3 Cap 4 Plug	0 Metal	1 6 2 10 3 13 4 20 5 25 6 32 7 40 8 50	1/4" 3/8" 1/2" 3/4" 1" 1 1/4" 1 1/2" 2" AA

(S) 6 - (S) 50 - ALUMINUM

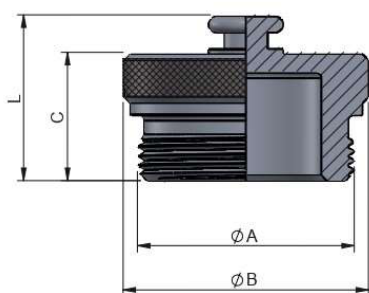

PLUG

(S)	REF.	ØA	ØB	L
6	203.6301AA	M27x1.5	32	24.5
10	203.6302AA	M30x1.5	35	26.5
13	203.6303AA	M35x1.5	40	26.5
20	203.6304AA	M45x1.5	50	32
25	203.6305AA	M54x1.5	60	38
32	203.6306AA	M70x2	75	45
40	203.6307AA	M78x2	84.5	47
50	203.6308AA	M92x3	117	61

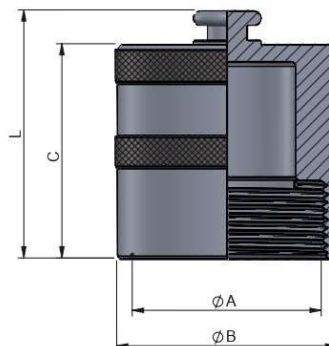

CAP

(S)	REF.	ØA	ØB	L
6	203.6401AA	M27x1.5	32	40
10	203.6402AA	M30x1.5	35	43
13	203.6403AA	M35x1.5	40	41
20	203.6404AA	M45x1.5	50	52
25	203.6405AA	M54x1.5	60	61
32	203.6406AA	M70x2	75	80
40	203.6407AA	M78x2	85	83
50	203.6408AA	M92x3	102	116