



136 SERIES DRF



Manufactured according to ISO 15171-1 & SAE J1502.

TECHNICAL SPECIFICATIONS

Features:		Facilitates maintenance of hydraulic systems by providing easy connection at multiple pressure checkpoints.
		Connector designed for pressure checking at different points of a circuit.
		No air inclusion in the circuit.
Operating pressure:	Up to 500 Bar	
Materials:	Body:	Carbon Steel EN -10277-3
	O-rings:	NBR / VITON / EPDM
	Back-up-ring:	PTFE
	Springs:	EN 10270-1/SH
Available Threads:	Balls:	AISI 1010/1015
	BSP / NPTF / ISO 9974-2 (DIN 3852-11)	
	ISO 11926 (J1926) / ISO 8434-2 (J514/JIC)	
	ISO 6149-2 / ISO 8434-1 (DIN 2353)	
	ISO 8134-3 (J1453)*	
Closing System:	Flat	
Connection / Disconnection:	Push to Connect / Sleeve Retraction	
Connection Under Pressure:	Not Allowed	

Available Size: 1/8"

Working Temperature (O-rings)

NBR	Viton	EPDM
+100°C	+200°C	+150°C
-30°C	-10°C	-40°C

Sectors: Industrial /Building Machinery



Applications: Designed for Hydraulic Oil (Group II-2014/68/EU)

Interchange: PARKER PD / FASTER DF

**Others upon request.*

MODEL STRUCTURE

Example:

136.12110 BB

Series	Material	Part	Closing	O-rings	Size (S)	Thread
136.	1 Carbon St.	1 Male 2 Female	1 Flat	1 NBR 2 VITON 3 EPDM	0 04 1/8"	2 letters (see Table of Threads page 999-1)

136-1

INTEVA reserves the right to make modifications to its products without prior notice. Any external or internal alterations to our products will automatically void the warranty.







136 SERIES DRF

MALE THREAD

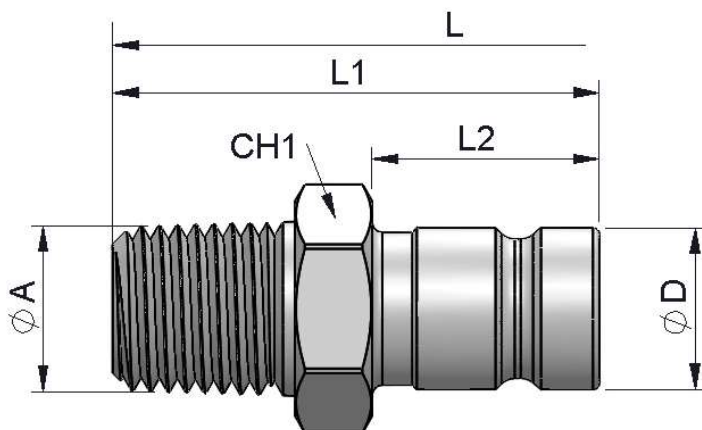
(S) 04 - 1/8" MALE THREAD



(S)	ØA	STANDARD	REF.		L	L1	L2	CH1	ØD
04	1/8" NPTF	ANSI B1.20.3	136.11110BL	420	81	46	17.8	19	12.6
	1/4" NPTF		136.11110BM						
	M14x1.5	ISO 6149-2 (ORB)	136.11110OF						
	3/8" – 24h UNF	SAE J1926-2 ISO 11926 (ORB)	136.11110HA						
	7/16"- 20h UNF		136.11110HB						
	1/2"- 20h UNF		136.11110HC						
	9/16"- 18h UNF		136.11110HD						
	9/16"- 18h UNF	ISO 8434-3 SAE J1453 (ORFS)	136.11110ZD						
	11/16"- 16 UN		136.11110ZE						
	13/16" – 16h UN		136.11110ZG					22	
	7/16"- 20h UNF	ISO 8434-2 SAE 37° (JIC) SAE J514	136.11110YB					19	
	1/2"- 20h UNF		136.11110YC						
	9/16"- 18h UNF		136.11110YD						
	M12x1.5	ISO 9974-2	136.11110QE						
	M14x1.5		136.11110QF						
	1/8" BSP	BS5200	136.11110AL						
	1/4" BSP		136.11110AM						

136-2

INTEVA reserves the right to make modifications to its products without prior notice. Any external or internal alterations to our products will automatically void the warranty.







136 SERIES DRF

MALE THREAD

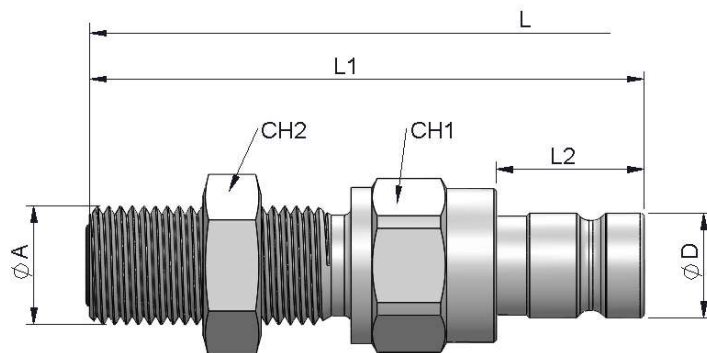
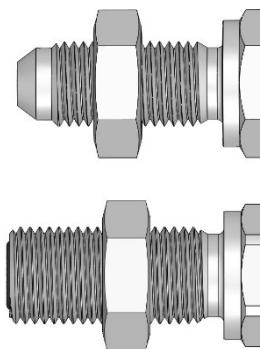
(S) 04 - 1/8" BULKHEAD MALE THREAD



(S)	ØA	STANDARD	REF.		L	L1	L2	CH1	CH2	ØD
04	9/16"- 18h UNF	ISO 8434-3 SAE J1453 (ORFS)	136.11110ZDP	420	106	67	17.8	19	19	12.6
	11/16"- 16 UN		136.11110ZEP		107	68				
	13/16" – 16h UN		136.11110ZGP		110	71		22	22	
	7/16"- 20h UNF	ISO 8434-2 SAE 37° (JIC) SAE J514	136.11110YBP		103	64		19	19	
	1/2"- 20h UNF		136.11110YCP		101	62				
	9/16"- 18h UNF		136.11110YDP		103	64				

(S) 04 - 1/8" BULKHEAD MALE THREAD

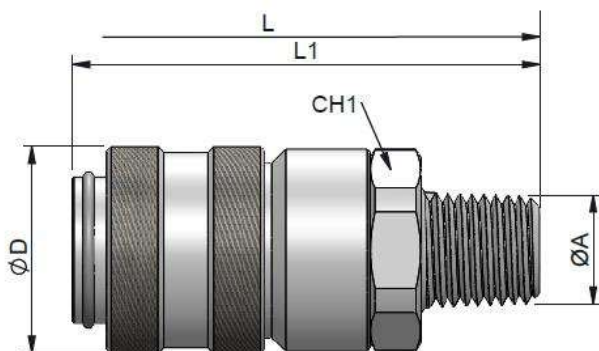

(S)	ØA	STANDARD	REF.		L	L1	CH1	ØD
04	1/8" NPTF	ANSI B1.20.3	136.12110BL	420	81.25	55	22	24.3
	1/4" NPTF		136.12110BM					
	1/8" BSP	BS5200	136.12110AL					
	1/4" BSP		136.12110AM					

136-3

INTEVA reserves the right to make modifications to its products without prior notice. Any external or internal alterations to our products will automatically void the warranty.





136 SERIES

DRF

FEMALE THREAD

(S) 04 - 1/8" FEMALE THREAD

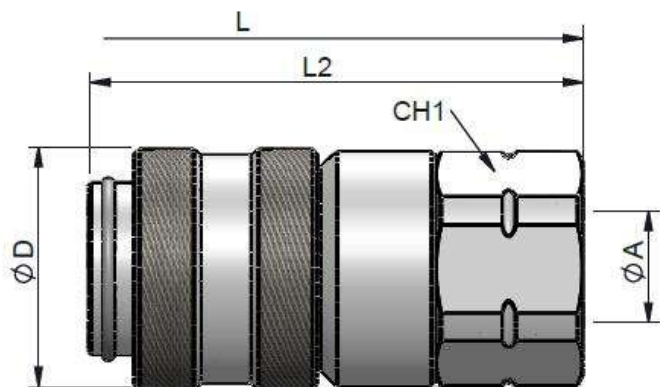
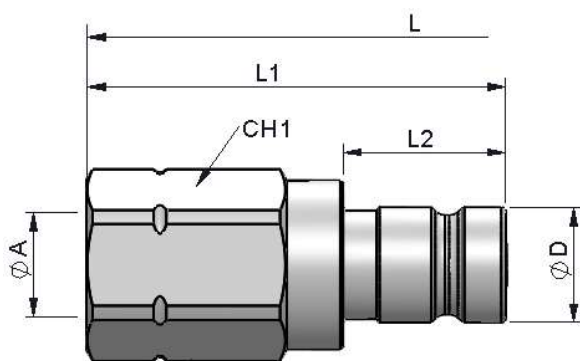

STANDARD MALE MODELS

STANDARD FEMALE MODELS

(S)	ØA	STANDARD		REF.	L	L1	L2	CH1	ØD	REF.	L2	CH1	ØD
04	1/8" BSP	BS5200	420	136.11110AA	81	42	17.8	19	12.6	136.12110AA	54	22	24.3
	1/4" BSP			136.11110AB						136.12110AB			
	1/8" NPTF	ANSI B1.20.3		136.11110BA						136.12110BA			
	1/4" NPTF			136.11110BB						136.12110BB			
	M14x1.5	ISO 6149-1		136.11110EF						136.12110EF			
	7/16" UNF	SAE J1926-1		136.11110GB						136.12110GB			
	9/16" UNF			136.11110GD						136.12110GD			
	9/16" UNF	ISO 8434-3		136.11110VD						136.12110VD			
	11/16" UN			136.11110VE						136.12110VE			
	13/16" UN			136.11110VG						136.12110VG			
	7/16" UNF	ISO 8434-2		136.11110UB						136.12110UB			
	1/2" UNF			136.11110UC						136.12110UC			
	9/16" UNF			136.11110UD						136.12110UD			
	3/4" UNF			136.11110UF						136.12110UF			



136 SERIES DRF

TECHNICAL DATA

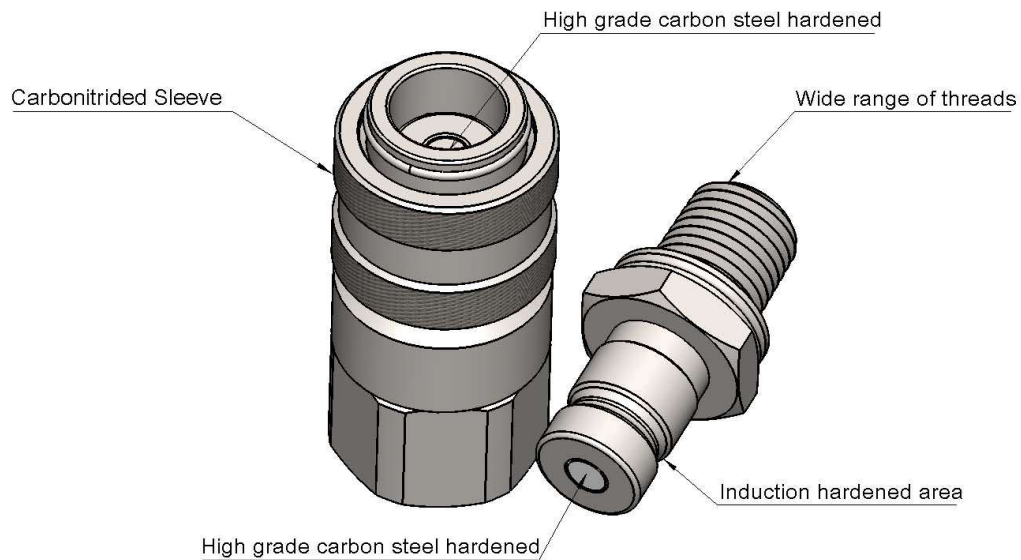

(S)	Max. Flow	Connection Force	Min. Burst Pressure (bar)			Max. Working Pressure	Fluid Spillage
	l/m	N	Male	Female	Coupled	Bar	ml
04	2	50	1450	1400	1400	350	Max. 0.02

Test performed according to ISO 18869

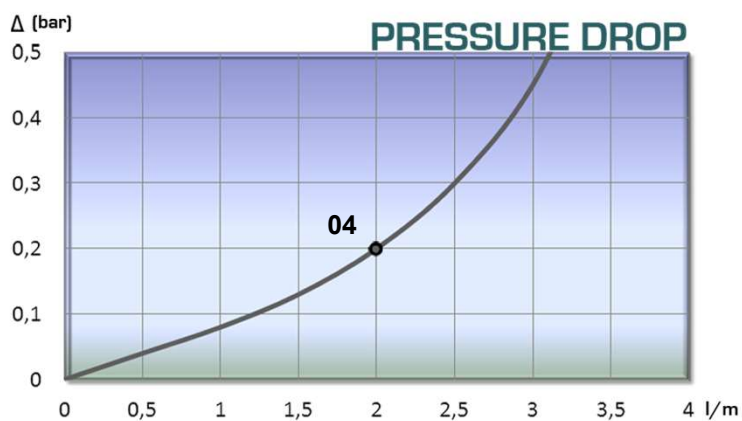

DUST CAP – 136.5450AA

136-5

INTEVA reserves the right to make modifications to its products without prior notice. Any external or internal alterations to our products will automatically void the warranty.

