



# 131 SERIES

## CPR

CARBON STEEL

Manufactured according to ISO 16028.

### TECHNICAL SPECIFICATIONS

#### Features:

Its internal design and high strength material used, provide high operating characteristics and circuit efficiency.  
Minimal fluid spillage to environment.  
Resistant to pressure impulses

C.U.R.P. – Connect Under Residual Pressure male couplings available.

<b>Operating pressure:</b>	Up to 500 Bar	
<b>Materials:</b>	Body:	Carbon Steel EN -10277-3
	O-rings:	NBR / VITON / EPDM
	Back-up-ring:	PTFE
	Springs:	EN 10270-1/SH
	Balls:	AISI 1010/1015
<b>Available Threads:</b>	BSP / NPTF / ISO 11926 (J1926) ISO 8434-1 (DIN 2353)*	
<b>Closing System:</b>	Flat Face / C.U.R.P.**	
<b>Connection / Disconnection:</b>	Press to connect / Sleeve Retraction	
<b>Connection Under Pressure:</b>	Not Allowed / only C.U.R.P. model	

**Available Size:** 1/8" a 2"

#### Working Temperature (O-rings)

	NBR	Viton	EPDM
	+100°C	+200°C	+150°C
	-30°C	-10°C	-40°C

**Sectors: Industrial, Building Machinery**



**Applications:** Designed for Hydraulic Oil (Group II-2014/68/EU)

**Interchange:** FASTER FFH / PARKER FEM  
AEROQUIP FD89 / SNAP-TITE 74

\*Others upon request.

### MODEL STRUCTURE

Example:

**131.11113 AD**

Series	Material	Part	Closing	O-rings	Size (S)	Thread
131.	1 Carbon St.	1 Male	1 Flat	1 NBR	0 4	1/8"
	3 Carbon St. Ni.	2 Female	3 C.U.R.P.	2 VITON	1 6.3	1/4"
				3 EPDM	2 10	3/8"
					3 12.5	1/2"
					4 16	3/4"
					5 19	1"
					6 25	1 1/4"
					7 30	1 1/2"
					8 45	2"

\*\*C.U.R.P. Is available in male part only

**131-1**

INTEVA reserves the right to make modifications to its products without prior notice. Any external or internal alterations to our products will automatically void the warranty.



v11



# 131 SERIES CPR

CARBON STEEL  
FEMALE THREAD  
BSP / NPTF / ISO 11926 (J1926)

(S) 4 - 1/8"

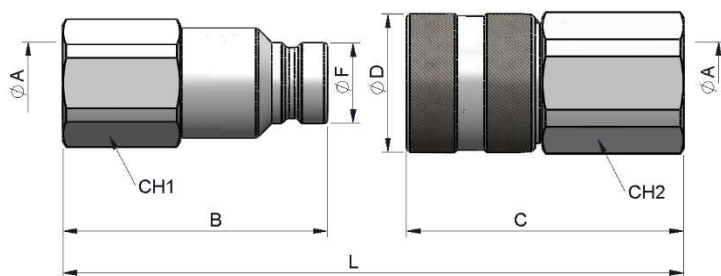

STANDARD MALE MODELS

(S)	ØA	REF.		CH1	B	ØF	L
4	1/8" BSP	131.11110AA		17	38.35	11.65	70.50
	1/8" NPTF	131.11110BA					

STANDARD FEMALE MODELS

(S)	ØA	REF.		CH2	C	ØD	L
4	1/8" BSP	131.12110AA		19	40.2	20	70.50
	1/8" NPTF	131.12110BA					

(S) 6.3 - 1/4"

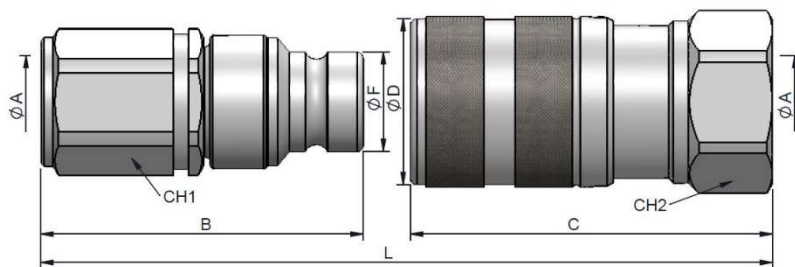

STANDARD MALE MODELS

(S)	ØA	REF.		CH1	B	ØF	L
6.3	1/4" BSP	131.11111AB		22	52.5	16.20	103
	1/4" NPTF	131.11111BB					
	9/16"- 18h UNF	131.11111GD					
	M16X1.5	131.11111ND					
	M18X1.5	131.11111NE					

STANDARD FEMALE MODELS

(S)	ØA	REF.		CH2	C	ØD	L
6.3	1/4" BSP	131.12111AB		27	62	28	103
	1/4" NPTF	131.12111BB					
	9/16"- 18h UNF	131.12111GD					
	M16X1.5	131.12111ND					
	M18X1.5	131.12111NE					



# 131 SERIES CPR

CARBON STEEL  
FEMALE THREAD  
BSP / NPTF / ISO 11926 (J1926)

(S) 10 - 3/8"

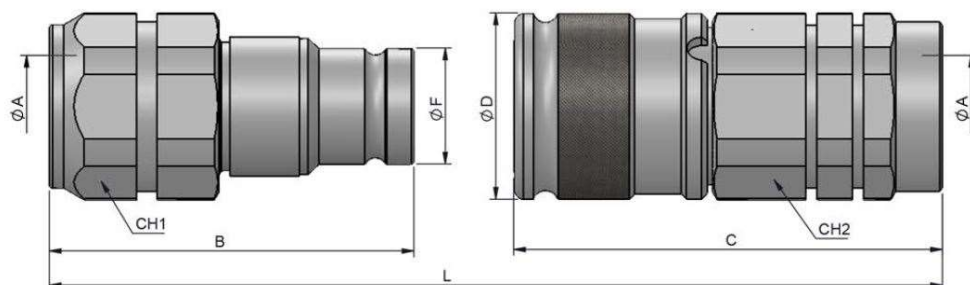

STANDARD MALE MODELS

(S)	ØA	REF.		CH1	B	ØF	L
10	3/8" BSP	131.11112AC		350	30	62.5	120
	3/8" NPTF	131.11112BC					
	1/2" BSP	131.11112AD					
	1/2" NPTF	131.11112BD					
	3/4"- 16h UNF	131.11112GF					
	7/8"- 14h UNF	131.11112GH					

STANDARD FEMALE MODELS

(S)	ØA	REF.		CH2	C	ØD	L
10	3/8" BSP	131.12112AC		350	30	73.5	120
	3/8" NPTF	131.12112BC					
	1/2" BSP	131.12112AD					
	1/2" NPTF	131.12112BD					
	3/4"- 16h UNF	131.12112GF					
	7/8"- 14h UNF	131.12112GH					

(S) 12.5 - 1/2"

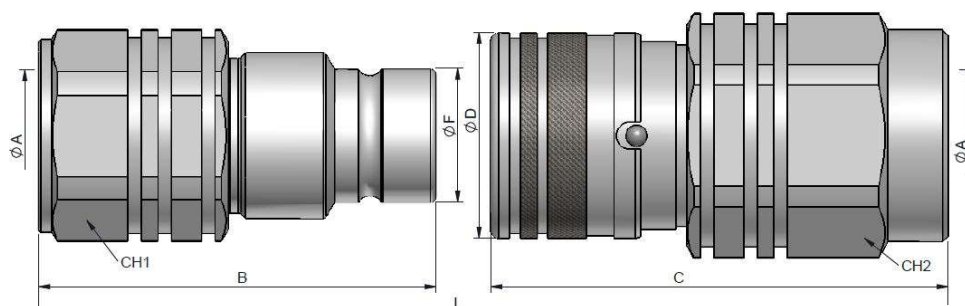

STANDARD MALE MODELS

(S)	ØA	REF.		CH1	B	ØF	L
12.5	1/2" BSP	131.11113AD		330	36	73	140
	1/2" NPTF	131.11113BD					
	3/4" BSP	131.11113AE					
	3/4" NPTF	131.11113BE					
	7/8"- 14h UNF	131.11113GH					
	1 1/16"- 12 UN	131.11113GK					

STANDARD FEMALE MODELS

(S)	ØA	REF.		CH2	C	ØD	L
12.5	1/2" BSP	131.12113AD		330	41	87	140
	1/2" NPTF	131.12113BD					
	3/4" BSP	131.12113AE					
	3/4" NPTF	131.12113BE					
	7/8"- 14h UNF	131.12113GH					
	1 1/16"- 12 UN	131.12113GK					

131-3

INTEVA reserves the right to make modifications to its products without prior notice. Any external or internal alterations to our products will automatically void the warranty.



v11



# 131 SERIES CPR

CARBON STEEL  
FEMALE THREAD  
BSP / NPTF / ISO 11926 (J1926)

(S) 16 - 3/4"

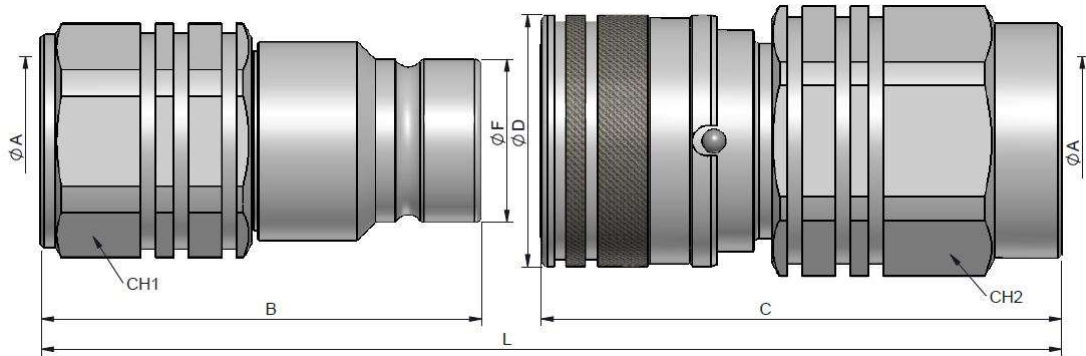

STANDARD MALE MODELS

(S)	ØA	REF.		CH1	B	ØF	L
16	3/4" BSP	131.11114AE		330	36	73	27
	3/4" NPTF	131.11114BE					
	1 1/16" -12h UN	131.11114GK					

STANDARD FEMALE MODELS

(S)	ØA	REF.		CH2	C	ØD	L
16	3/4" BSP	131.12114AE		330	41	86	42
	3/4" NPTF	131.12114BE					
	1 1/16" -12h UN	131.12114GK					

(S) 19 - 1"

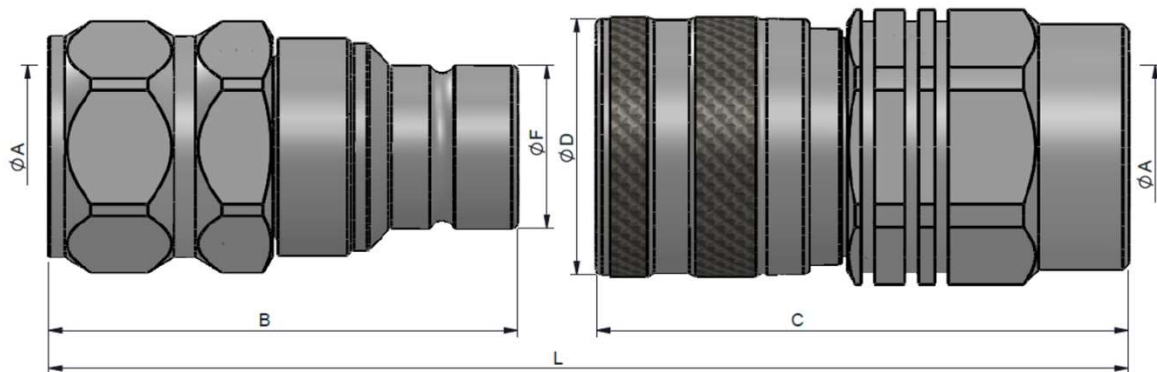

STANDARD MALE MODELS

(S)	ØA	REF.		CH1	B	ØF	L
19	1" BSP	131.11115AF		330	41	86	30
	1" NPTF	131.11115BF					
	1 5/16" - 12h UN	131.11115GO					

STANDARD FEMALE MODELS

(S)	ØA	REF.		CH2	C	ØD	L
19	1" BSP	131.12115AF		330	46	97.50	48
	1" NPTF	131.12115BF					
	1 5/16" - 12h UN	131.12115GO					

131-4

INTEVA reserves the right to make modifications to its products without prior notice. Any external or internal alterations to our products will automatically void the warranty.





# 131 SERIES CPR

CARBON STEEL  
FEMALE THREAD  
BSP / NPTF / ISO 11926 (J1926)

(S) 25 - 1 1/4"

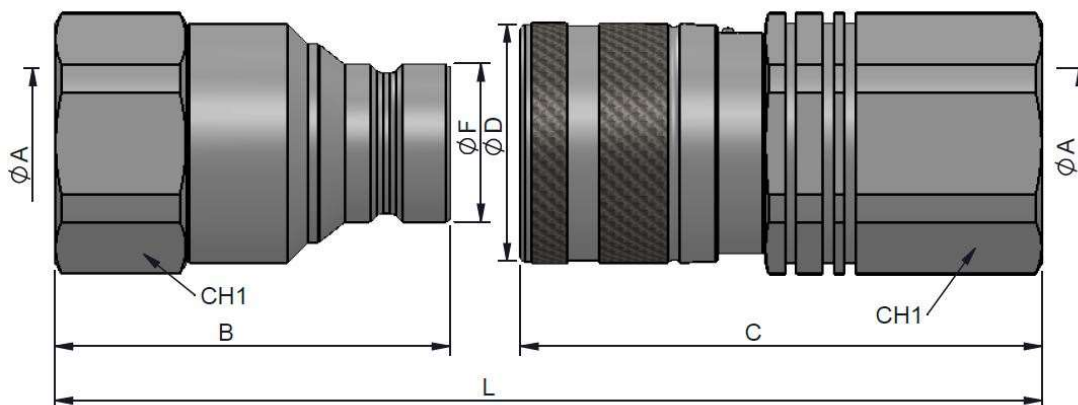

STANDARD MALE MODELS

(S)	ØA	REF.		CH1	B	ØF	L
25	1 1/4" BSP	131.11116AG		300	55	90	36
	1 1/4" NPTF	131.11116BG					

STANDARD FEMALE MODELS

(S)	ØA	REF.		CH2	C	ØD	L
25	1 1/4" BSP	131.12116AG		300	55	119	54
	1 1/4" NPTF	131.12116BG					

(S) 30 - 1 1/2"

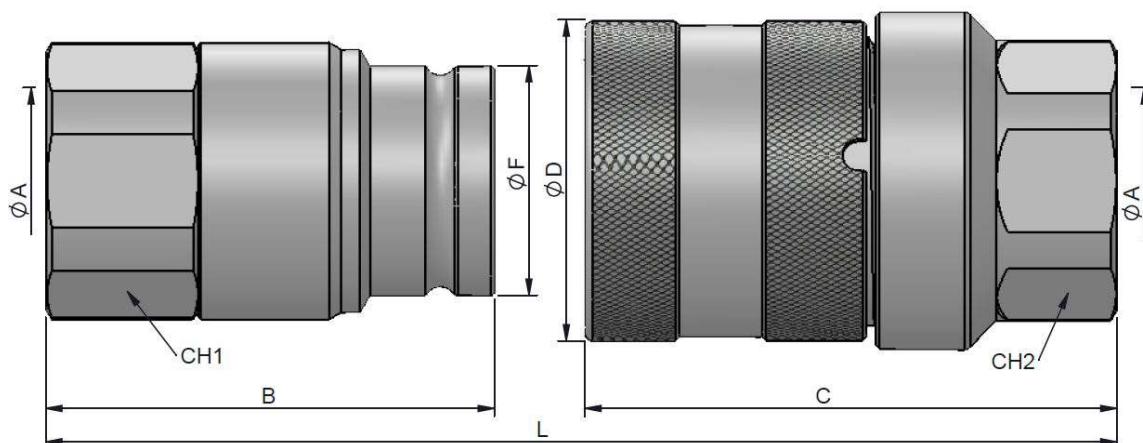

STANDARD MALE MODELS

(S)	ØA	REF.		CH1	B	ØF	L
30	1 1/2" BSP	131.11117AH		280	65	111.5	57
	1 1/2" NPTF	131.11117BH					

STANDARD FEMALE MODELS

(S)	ØA	REF.		CH2	C	ØD	L
30	1 1/2" BSP	131.12117AH		280	65	132.20	80
	1 1/2" NPTF	131.12117BH					

131-5

INTEVA reserves the right to make modifications to its products without prior notice. Any external or internal alterations to our products will automatically void the warranty.



v11



# 131 SERIES CPR

CARBON STEEL  
FEMALE THREAD  
BSP / NPTF / ISO 11926 (J1926)

(S) 45 - 2"

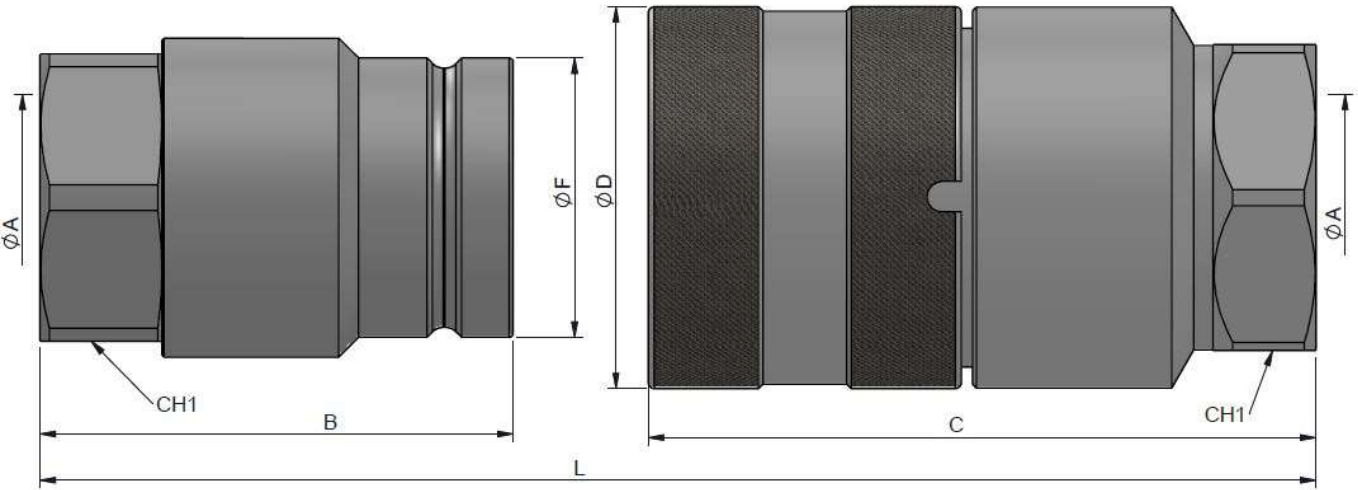

## STANDARD MALE MODELS

(S)	ØA	REF.		CH1	B	ØF	L
45	2" BSP	131.11118AI	250	75	124	73	260

## STANDARD FEMALE MODELS

(S)	ØA	REF.		CH2	C	ØD	L
45	2" BSP	131.12118AI	250	80	175	100	260





# 131 SERIES CPR

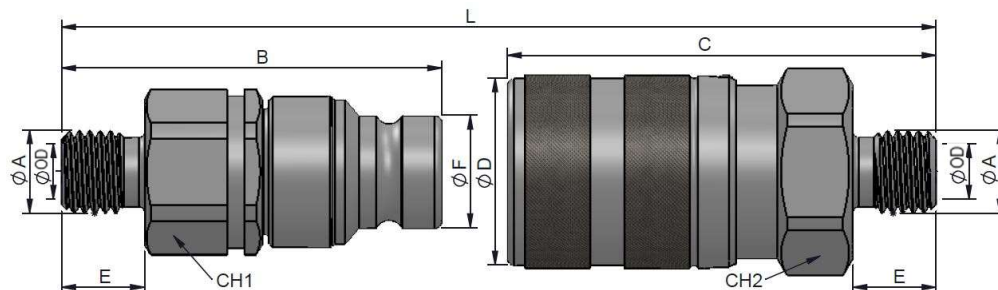

CARBON STEEL  
MALE THREAD  
DIN 2353 (ISO 8434-1)

(S) 6.3 - 1/4"



STANDARD MALE MODELS

STANDARD FEMALE MODELS

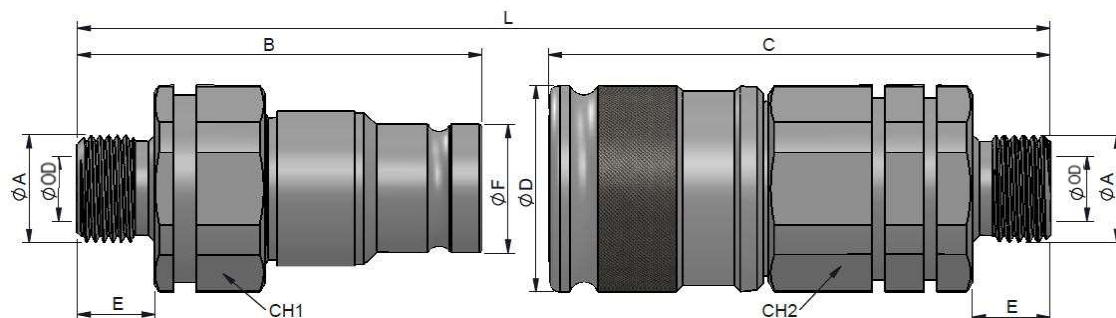

(S)	ØA	OD		L	REF.		CH1	B	ØF	E	REF.		CH2	C	ØD	E
6.3	M12x1.5	LIGHT	6L	106	131.11111JB	500	22	55	16.2	12	131.12111JB	500	27	62	27.5	12
	M14x1.5		8L	104	131.11111JC	500	22	54	16.2	11	131.12111JC	500	27	63	27.5	11
	M16x1.5		10L	104	131.11111JD	500	22	54	16.2	11	131.12111JD	500	27	63	27.5	11
	M16x1.5	HEAVY	8S	104	131.11111KD	500	22	54	16.2	11	131.12111KD	500	27	63	27.5	11
	M18x1.5		10S	104	131.11111KE	500	22	54	16.2	11	131.12111KE	500	27	63	27.5	11

(S) 10 - 3/8"



STANDARD MALE MODELS

STANDARD FEMALE MODELS

(S)	ØA	OD		L	REF.		CH1	B	ØF	E	REF.		CH2	C	ØD	E
10	3/8" BSP	LIGHT	*	125	131.11112AN	350	30	63	19.79	12	131.12112AN	350	30	78	33	12
	M14x1.5		8L	122	131.11111JC	350	30	62	19.79	11	131.12112JC	350	30	77	33	11
	M16x1.5		10L	125	131.11112JD	350	30	63	19.79	12	131.12112JD	350	30	78	33	12
	M16x1.5	HEAVY	8S	125	131.11112KD	350	30	63	19.79	12	131.12112KD	350	30	78	33	12
	M18x1.5		10S	125	131.11112KE	350	30	63	19.79	12	131.12112KE	350	30	78	33	12
	M20x1.5		12S	125	131.11112KF	350	30	63	19.79	12	131.12112KF	350	30	78	33	12

131-7

INTEVA reserves the right to make modifications to its products without prior notice. Any external or internal alterations to our products will automatically void the warranty.



v11



# 131 SERIES CPR

CARBON STEEL  
MALE THREAD  
DIN 2353 (ISO 8434-1)

(S) 12.5 - 1/2"

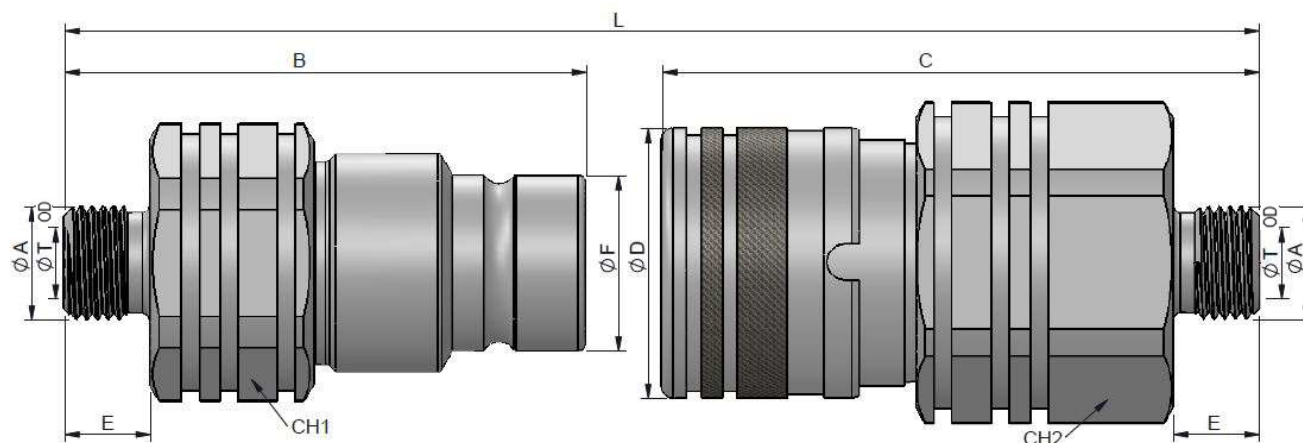

STANDARD MALE MODELS

STANDARD FEMALE MODELS

(S)	ØA	OD		L	REF.		CH1	B	ØF	E	REF.		CH2	C	ØD	E
12.5	M14x1.5	LIGHT	8L	135	131.11113JC	330	36	73	24,58	11	131.12113JC	330	41	79.5	38.5	11
	M16x1.5		10L	137	131.11113JD	330	36	74	24,58	12	131.12113JD	330	41	80.5	38.5	12
	M18x1.5		12L	137	131.11113JE	330	36	74	24,58	12	131.12113JE	330	41	80.5	38.5	12
	M22x1.5		15L	137	131.11113JG	330	36	74	24,58	12	131.12113JG	330	41	80.5	38.5	12
	M26x1.5		18L	137	131.11113JI	330	36	74	24,58	12	131.12113JI	330	41	80.5	38.5	12
	M18x1.5	HEAVY	10S	137	131.11113KE	330	36	74	24,58	12	131.12113KE	330	41	80.5	38.5	12
	M20x1.5		12S	137	131.11113KF	330	36	74	24,58	12	131.12113KF	330	41	80.5	38.5	12
	M22x1.5		14S	137	131.11113KG	330	36	74	24,58	12	131.12113KG	330	41	80.5	38.5	12
	M24x1.5		16S	137	131.11113KH	330	36	74	24,58	12	131.12113KH	330	41	80.5	38.5	12





# 131 SERIES CPR

CARBON STEEL  
MALE THREAD  
DIN 2353 (ISO 8434-1)

(S) 16 - 3/4"

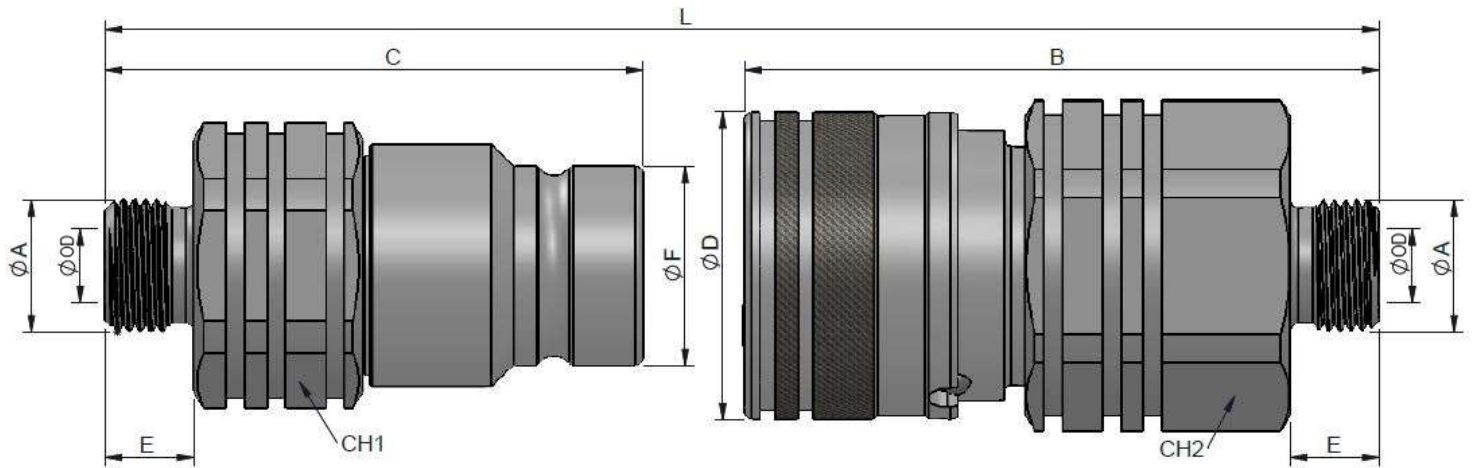

STANDARD MALE MODELS

STANDARD FEMALE MODELS

(S)	ØA	OD		L	REF.		CH1	B	ØF	E	REF.		CH2	C	ØD	E
16	M18x1.5	LIGHT	12L	139.5	131.11114JE	330	36	74	27.08	12	131.12114JE	330	41	83	42	12
	M22x1.5		15L	139.5	131.11114JG	330	36	74	27.08	12	131.12114JG	330	41	83	42	12
	M26x1.5		18L	139.5	131.11114JI	330	36	74	27.08	12	131.12114JI	330	41	83	42	12
	M30x2		22L	151.5	131.11114JJ	330	36	80	27.08	18	131.12114JJ	330	41	89	42	18
	M22x1.5	HEAVY	14S	139.5	131.11114KG	330	36	74	27.08	12	131.12114KG	330	41	83	42	12
	M24x1.5		16S	139.5	131.11114KH	330	36	74	27.08	12	131.12114KH	330	41	83	42	12
	M30x2		20S	151.5	131.11114KJ	330	36	80	27.08	18	131.12114KJ	330	41	89	42	18



# 131 SERIES CPR

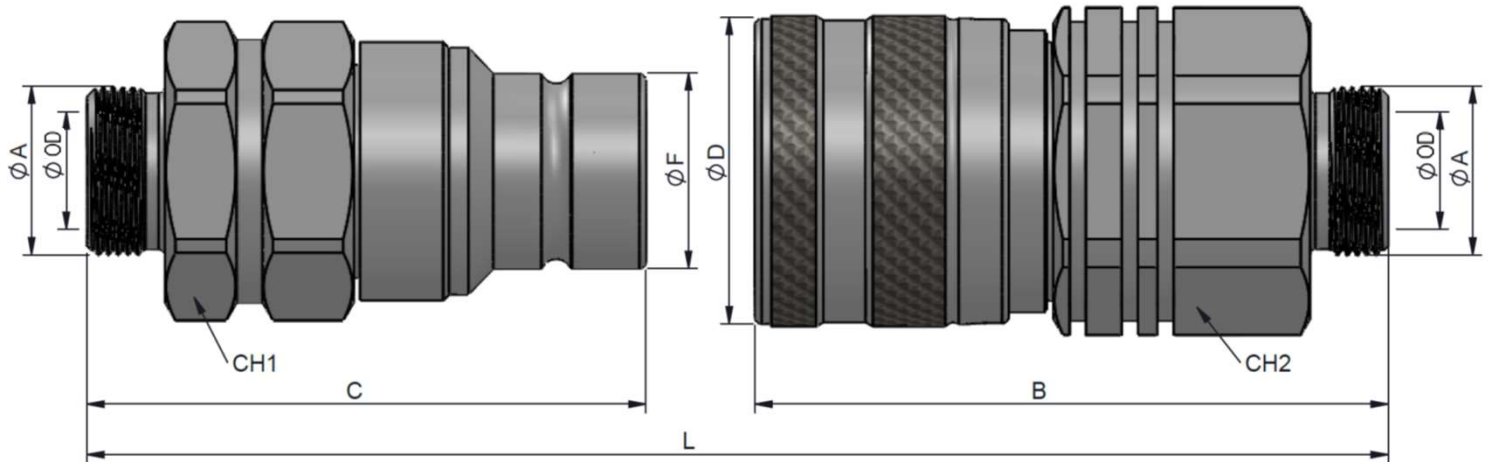

CARBON STEEL  
MALE THREAD  
DIN 2353 (ISO 8434-1)

(S) 19 - 1"



STANDARD MALE MODELS

STANDARD FEMALE MODELS

(S)	ØA	OD		L	REF.		CH1	B	ØF	E	REF.		CH2	C	ØD	E
19	M26x1.5	LIGHT	18L	152	131.11115JI	330	41	82	30	12	131.12115JI	330	46	92	30	12
	M30x2		22L	164	131.11115JJ	330	41	88	30	18	131.12115JJ	330	46	98	30	18
	M36x2		28L	157	131.11115JK	330	41	81	30	18	131.12115JK	330	46	98	30	18
	M45x2		35L	151	131.11115JM	330	46	81	30	16	131.12115JM	330	46	92	30	16
	M30x2	HEAVY	20S	163	131.11115KJ	330	41	86	30	18	131.12115KJ	330	46	99	30	18
	M36x2		25S	155	131.11115KK	330	41	86	30	18	131.12115KK	330	46	99	30	18
	M42x2		30S	155	131.11115KL	330	46	81	30	18	131.12115KL	330	46	96	30	18
	M52x2		38S	153	131.11115KN	330	55	81	30	20	131.12115KN	330	46	94	30	20

131-10

INTEVA reserves the right to make modifications to its products without prior notice. Any external or internal alterations to our products will automatically void the warranty.





# 131 SERIES CPR

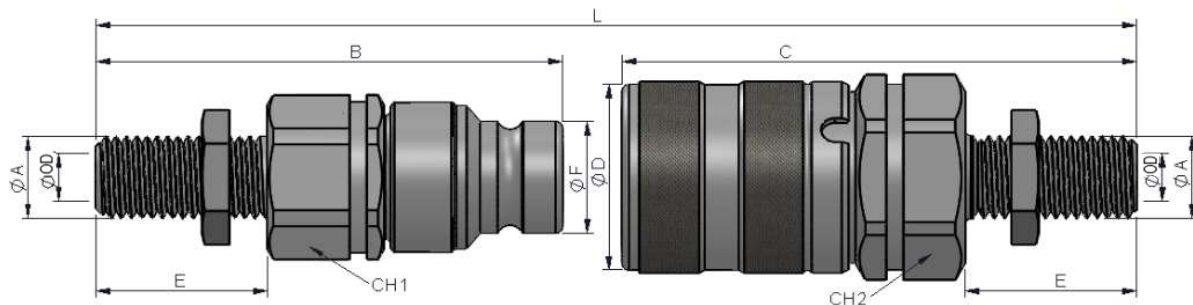

CARBON STEEL  
MALE THREAD BULKHEAD 24° CONE  
DIN 2353 (ISO 8434-1)

(S) 6.3 - 1/4"



STANDARD MALE MODELS

STANDARD FEMALE MODELS

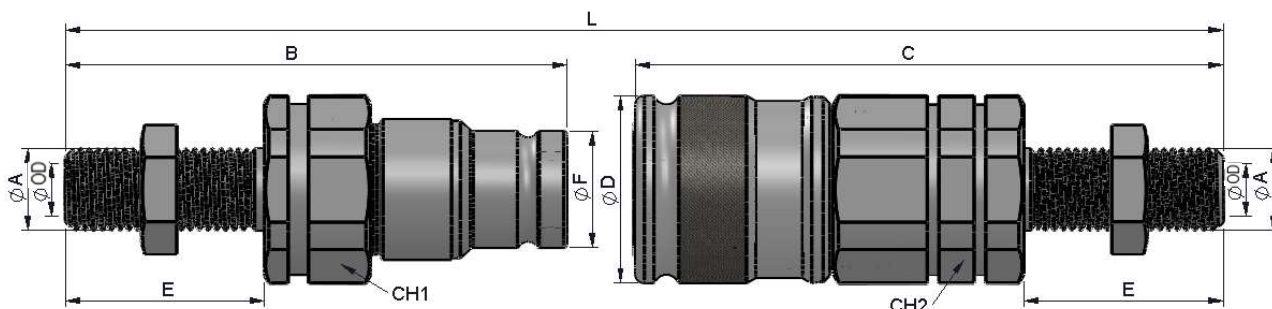

(S)	ØA	OD		L	REF.		CH1	B	ØF	E	REF.		CH2	C	ØD	E
6.3	M12x1.5	LIGHT	6L	132	131.11111LB	500	22	68	16.2	25	131.12111LB	500	27	75	27.5	25
	M14x1.5		8L	150	131.11111LC	500	22	77	16.2	34	131.12111LC	500	27	84	27.5	24
	M16x1.5		10L		131.11111LD	500	22		16.2		131.12111LD	500	27	63	27.5	35
	M16x1.5	HEAVY	8S	87	131.11111MD	500	22	43	16.2	26	131.12111MD	500	27	55	27.5	26
	M18x1.5		10S		131.11111ME	500	22		16.2		131.12111ME	500	27		27.5	

(S) 10 - 3/8"



STANDARD MALE MODELS

STANDARD FEMALE MODELS

(S)	ØA	OD		L	REF.		CH1	B	ØF	E	REF.		CH2	C	ØD	E
10	M14x1.5	LIGHT	8L	168	131.11112LC	350	30	84.5	19.79	34	131.12112LC	350	30	99.5	33	34
	M16x1.5		10L	170	131.11112LD	350	30	85.5	19.79	35	131.12112LD	350	30	100.5	33	35
	M16x1.5	HEAVY	8S	152	131.11112MD	350	30	76.5	19.79	26	131.12112MD	350	30	91.5	33	26
	M18x1.5		10S	154	131.11112ME	350	30	77.5	19.79	27	131.12112ME	350	30	92.5	33	27
	M20x1.5		12S	170	131.11112MF	350	30	85.5	19.79	35	131.12112MF	350	30	100.5	33	35

131-11

INTEVA reserves the right to make modifications to its products without prior notice. Any external or internal alterations to our products will automatically void the warranty.





# 131 SERIES CPR

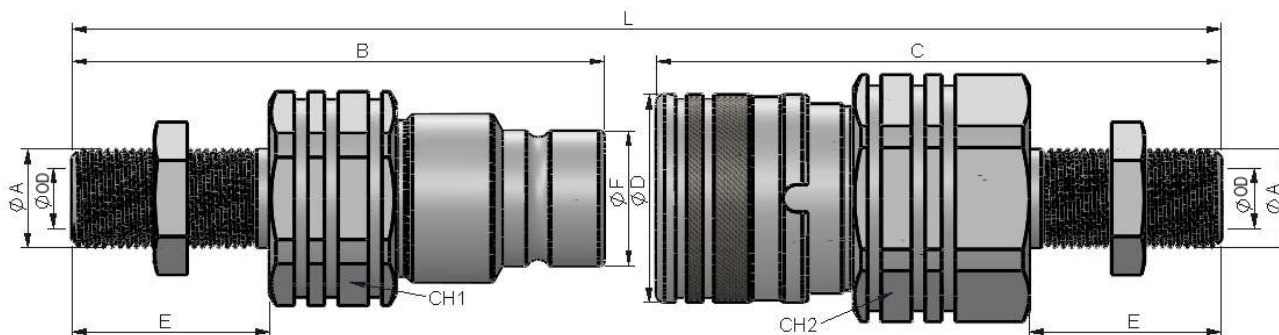

CARBON STEEL  
MALE THREAD BULKHEAD 24° CONE  
DIN 2353 (ISO 8434-1)

(S) 12.5 - 1/2"



STANDARD MALE MODELS

STANDARD FEMALE MODELS

(S)	ØA	OD		L	REF.		CH1	B	ØF	E	REF.		CH2	C	ØD	E
12.5	M14x1.5	LIGHT	8L	182	131.11113LC	330	36	97	24.58	34	131.12113LC	330	41	102.5	38,5	182
	M16x1.5		10L	183	131.11113LD	330	36	97	24.58	35	131.12113LD	330	41	103.5	38,5	183
	M18x1.5		12L	183	131.11113LE	330	36	97	24.58	35	131.12113LE	330	41	103.5	38,5	183
	M22x1.5		15L	181	131.11113LG	330	36	96	24.58	35	131.12113LG	330	41	102.5	38,5	181
	M26x1.5		18L	181	131.11113LI	330	36	96	24.58	35	131.12113LI	330	41	102.5	38,5	181
	M18x1.5	HEAVY	10S	183	131.11113ME	330	36	97	24.58	35	131.12113ME	330	41	103.5	38,5	183
	M20x1.5		12S	182	131.11113MF	330	36	97	24.58	35	131.12113MF	330	41	103.5	38,5	182
	M22x1.5		14S	182	131.11113MG	330	36	97	24.58	35	131.12113MG	330	41	103.5	38,5	182
	M24x1.5		16S	182	131.11113MH	330	36	97	24.58	35	131.12113MH	330	41	103.5	38,5	182

131-12

INTEVA reserves the right to make modifications to its products without prior notice. Any external or internal alterations to our products will automatically void the warranty.



v11



# 131 SERIES CPR

CARBON STEEL  
MALE THREAD BULKHEAD 24° CONE  
DIN 2353 (ISO 8434-1)

(S) 16 – 3/4"

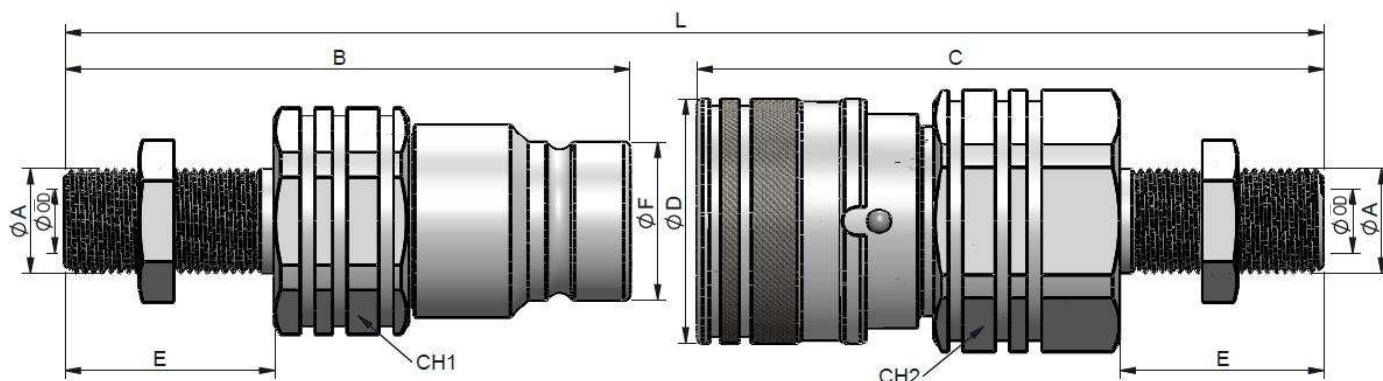

STANDARD MALE MODELS

STANDARD FEMALE MODELS

(S)	ØA	OD		L	REF.		CH1	B	ØF	E	REF.		CH2	C	ØD	E
16	M18x1.5	LIGHT	12L	185.5	131.11114LE	330	36	97	27.08	35	131.12114LE	330	41	106	42	35
	M22x1.5		15L	183.5	131.11114LG	330	36	97	27.08	35	131.12114LG	330	41	105	42	35
	M26x1.5		18L	183.5	131.11114LI	330	36	96	27.08	35	131.12114LI	330	41	105	42	35
	M30x2	HEAVY	22L	183.5	131.11114LJ	330	36	97	27.08	35	131.12114LJ	330	41	105	42	35
	M24x1.5		16S	184.5	131.11114MH	330	36	97	27.08	35	131.12114MH	330	41	105	42	35
	M30x2		20S	184.5	131.11114MJ	330	36	97	27.08	35	131.12114MJ	330	41	105	42	35

131-13

INTEVA reserves the right to make modifications to its products without prior notice. Any external or internal alterations to our products will automatically void the warranty.



v11





# 131 SERIES CPR

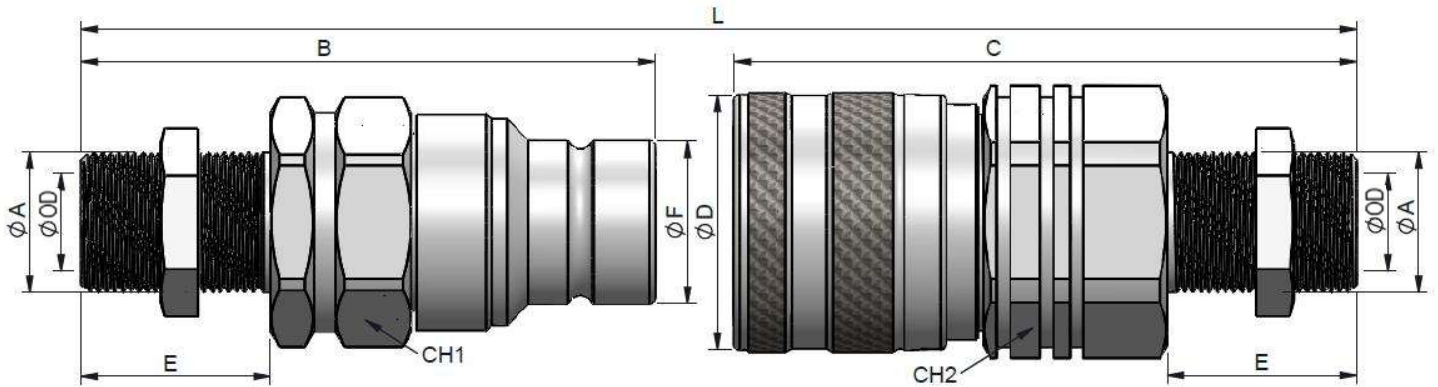

CARBON STEEL  
MALE THREAD BULKHEAD 24° CONE  
DIN 2353 (ISO 8434-1)

(S) 19 - 1"



STANDARD MALE MODELS

STANDARD FEMALE MODELS

(S)	ØA	OD		L	REF.		CH1	B	ØF	E	REF.		CH2	C	ØD	E
19	M26x1.5	LIGHT	18L	199	131.11115LI	330	41	106	30	35	131.12115LI	330	46	115	48.5	35
	M30x2		22L	199	131.11115LJ	330	41	106	30	35	131.12115LJ	330	46	114	48.5	35
	M36x2		28L	190	131.11115LK	330	41	98	30	34	131.12115LK	330	46	108	48.5	34
	M45x2		35L	186	131.11115LM	330	46	100	30	36	131.12115LM	330	46	114	48.5	36
	M30x2	HEAVY	20S	198	131.11115MJ	330	41	106	30	34	131.12115MJ	330	46	118	48.5	34
	M36x2		25S	205	131.11115MK	330	41	109	30	38	131.12115MK	330	46	117	48.5	38
	M42x2		30S	199	131.11115ML	330	46	104	30	40	131.12115ML	330	46	117	48.5	40
	M52x2		38S	196	131.11115MN	330	55	104	30	40	131.12115MN	330	55	114	48.5	40

131-14

INTEVA reserves the right to make modifications to its products without prior notice. Any external or internal alterations to our products will automatically void the warranty.





# 131 SERIES CPR

CARBON STEEL

## TECHNICAL DATA

(S)	Rated Flow	Min. Burst Pressure (Bar)			Max. Working Pressure
	l/m	Male	Female	Coupled	Bar
4	5 l/m	1450	1400	1400	500
6.3	18 l/m	1450	1400	1400	500
10	45 l/m	1020	1100	1000	350
12.5	75 l/m	1000	980	1000	330
16	150 l/m	950	970	1000	330
19	200 l/m	950	940	1000	330
25	220 l/m	930	900	1000	300
30	240 l/m	890	890	1000	280

Test performed according to ISO 18869

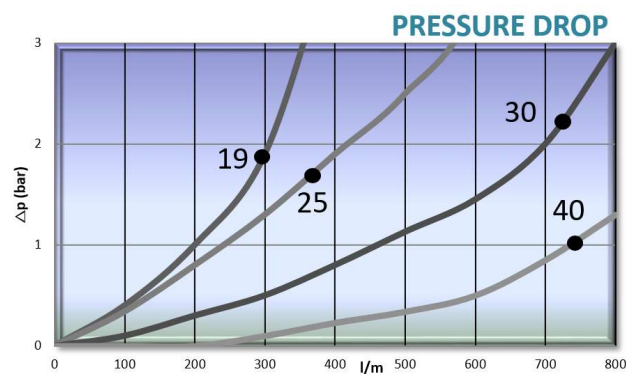
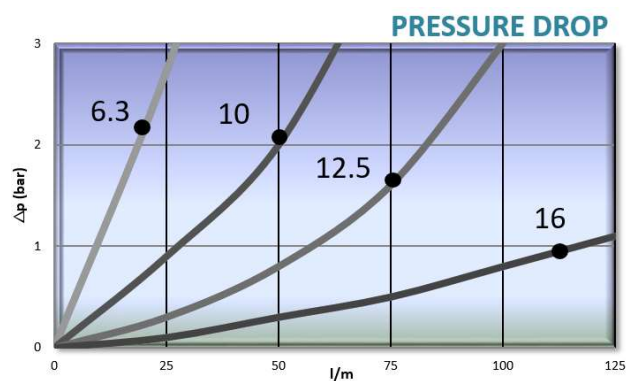

131-15

INTEVA reserves the right to make modifications to its products without prior notice. Any external or internal alterations to our products will automatically void the warranty.





# 131 SERIES CPR C.U.R.P.

## TECHNICAL SPECIFICATIONS

### Features:

Its internal design and high strength material used, provide high operating characteristics and circuit efficiency.  
Minimal fluid spillage to environment.  
Resistant to pressure impulses  
C.U.R.P. valve allows connection under Residual Pressure.  
Interchangeable with all ISO 16028 female 131 SERIES.

<b>Operating pressure:</b>	Up to 400 Bar	
<b>Materials:</b>	Body:	Carbon Steel EN -10277-3
	O-rings:	NBR / VITON / EPDM
	Back-up-ring:	PTFE
	Springs:	EN 10270-1/SH
	Balls:	AISI 1010/1015
<b>Available Threads:</b>	BSP / NPTF / ISO 11926	
<b>Closing System:</b>	C.U.R.P.	
<b>Connection / Disconnection:</b>	Press to connect / Sleeve Retraction	
<b>Connection Under Pressure:</b>	Residual Pressure	

**Available Size:** 1/4" a 1 1/4"

### Working Temperature (O-rings)

	NBR	Viton	EPDM
	+100°C -30°C	+200°C -10°C	+150°C -40°C

### Sectors: Industrial, Building Machinery



**Applications:** Designed for Hydraulic Oil (Group II-2014/68/EU)  
**Interchange:** FASTER 3FFH / PARKER FEM AEROQUIP FD89 / SNAP-TITE 74

## MODEL STRUCTURE

Example:

**131.11313 AD**

Series	Material	Part	Closing	O-rings	Size (S)	Thread
131.	1 Carbon St.	1 Male	3 C.U.R.P.	1 NBR 2 VITON 3 EPDM	1 6 2 10 3 13 4 16 5 19 6 25	1/4" 3/8" 1/2" 3/4" 1" 1 1/4"
						2 letters (see Table of Threads page 999-1)

**131-16**

INTEVA reserves the right to make modifications to its products without prior notice. Any external or internal alterations to our products will automatically void the warranty.







# 131 SERIES

## CPR C.U.R.P.

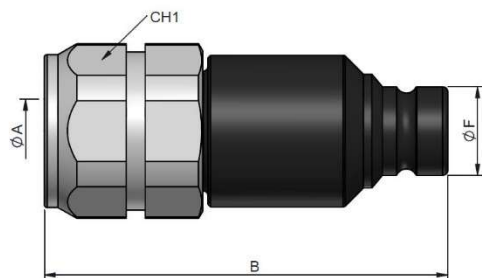
### (S) 6.3 - 1/4"





#### STANDARD MALE MODELS

(S)	ØA	REF.		CH1	B	ØF	L
6.3	1/4" BSP	131.11311AB		30	74	16.20	121
	1/4" NPTF	131.11311BB					

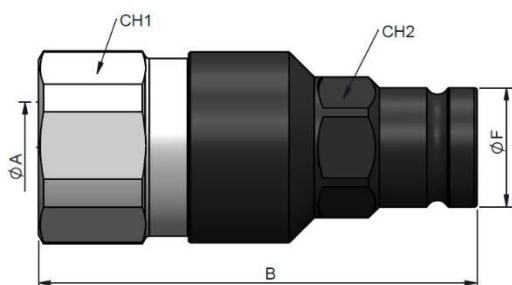
### (S) 10 - 3/8"





#### STANDARD MALE MODELS

(S)	ØA	REF.		CH1	B	ØF	L
10	3/8" BSP	131.11312AC		30	21	73	20
	3/8" NPTF	131.11312BC					
	1/2" BSP	131.11312AD					
	1/2" NPTF	131.11312BD					
	3/4"- 16h UNF	131.11312GF					
	7/8"- 14h UNF	131.11312GH					

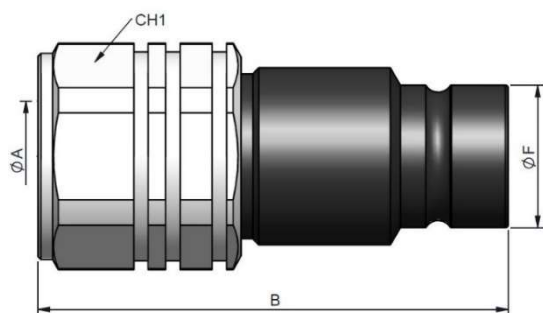
### (S) 12.5 - 1/2"



#### STANDARD MALE MODELS

(S)	ØA	REF.		CH1	B	ØF	L
12.5	1/2" BSP	131.11313AD		36	81	24.5	150
	1/2" NPTF	131.11313BD					
	3/4" BSP	131.11313AE					
	3/4" NPTF	131.11313BE					
	7/8"- 14h UNF	131.11313GH					
	1 1/16"- 12h UN	131.11313GK					



# 131 SERIES

## CPR C.U.R.P.

### (S) 16 - 5/8"

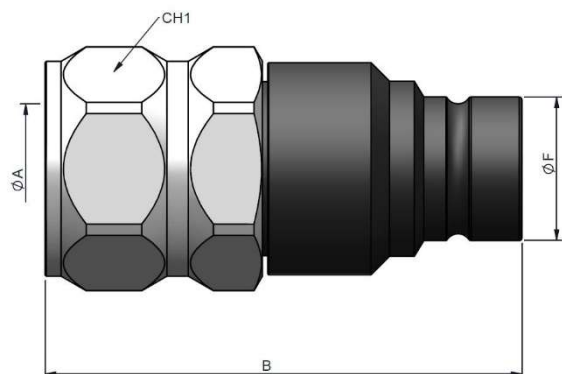

#### STANDARD MALE MODELS

(S)	ØA	REF.		CH1	B	ØF	L
16	3/4" BSP	131.11314AE	330	41	90	27.1	157.5
	3/4" NPTF	131.11314BE					
	1 1/16" - 12h UN	131.11314GK					

### (S) 19 - 3/4"

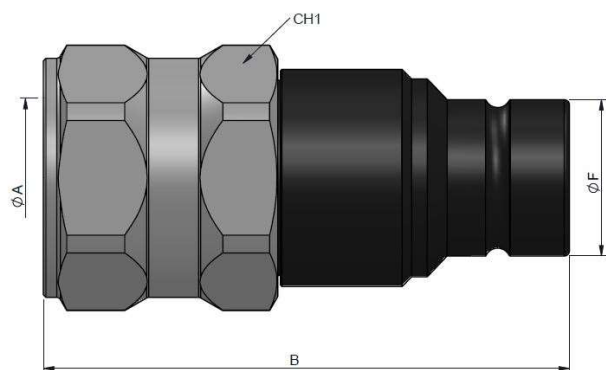

#### STANDARD MALE MODELS

(S)	ØA	REF.		CH1	B	ØF	L
19	1" BSP	131.11315AF	330	46	101	30	175
	1" NPTF	131.11315BF					
	1 5/16" - 12h UN	131.11315GO					

### (S) 25 - 1"

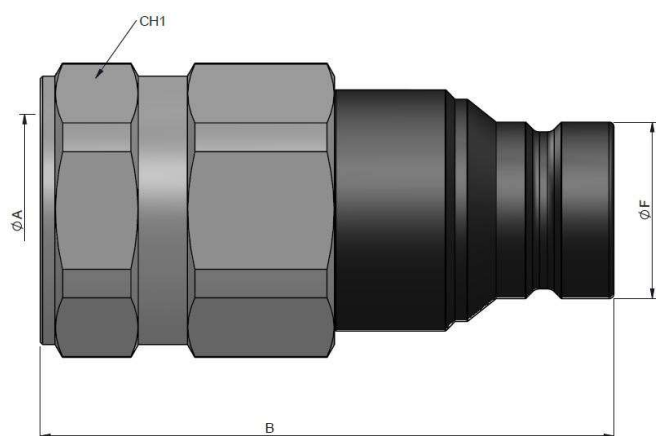

#### STANDARD MALE MODELS

(S)	ØA	REF.		CH1	B	ØF	L
25	1 1/4" BSP	131.11316AG	300	55	117	36	212
	1 1/4" NPTF	131.11316BG					





# 131 SERIES

## CPR C.U.R.P.

### TECHNICAL DATA

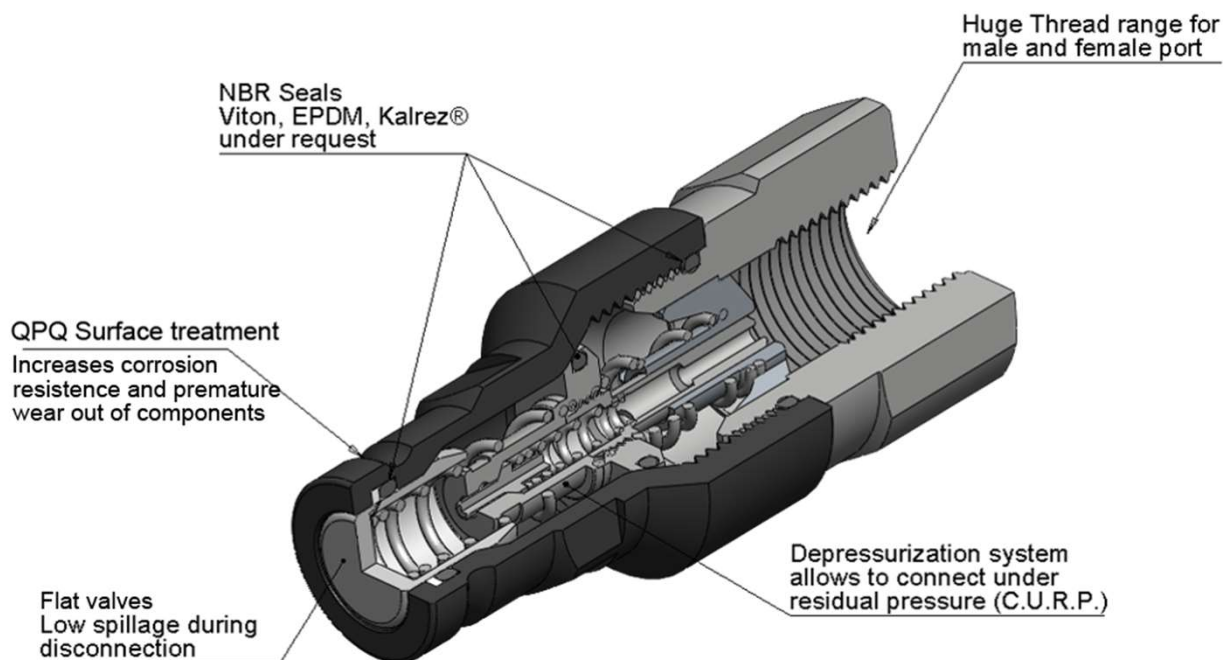

(S)	Rated Flow	Min. Burst Pressure (Bar)		Max. Working Pressure
		Male	Coupled	
6.3	18 l/m	1200	1100	400
10	45 l/m	1200	1000	350
12.5	75 l/m	1200	1000	330
16	150 l/m	1200	1000	330
19	200 l/m	1000	800	330
25	380 l/m	1000	800	300

Test performed according to ISO 18869

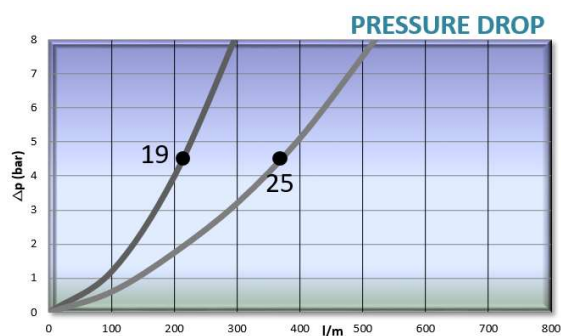
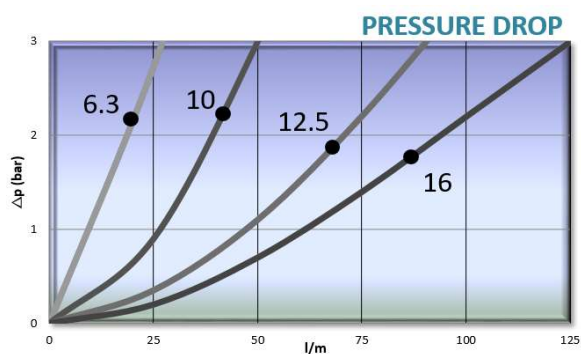

## 131-19

INTEVA reserves the right to make modifications to its products without prior notice. Any external or internal alterations to our products will automatically void the warranty.





# 131 SERIES

## CPR

### STAINLESS STEEL

Manufactured according to ISO 16028.

#### TECHNICAL SPECIFICATIONS

<b>Features:</b>	Its internal design and high strength material used, provide high operating characteristics and circuit efficiency. Minimal fluid spillage to environment. Resistant to pressure impulses C.U.R.P. – Connect Under Residual Pressure male couplings available.	
<b>Operating pressure:</b>	Up to 350 Bar	
<b>Materials:</b>	Body:	Stainless Steel SS316
	O-rings:	NBR / VITON / EPDM
	Back-up-ring:	PTFE
	Springs:	EN 10270-1/SH
	Balls:	SS316
<b>Available Threads:</b>	BSP / NPTF / ISO 11926 (J1926) ISO 8434-1 (DIN 2353)*	
<b>Closing System:</b>	Flat Face / C.U.R.P.**	
<b>Connection / Disconnection:</b>	Press to connect / Sleeve Retraction	
<b>Connection Under Pressure:</b>	Not Allowed	

**Available Size:** 1/8" a 2"

#### Working Temperature (O-rings)

NBR	Viton	EPDM
+100°C	+200°C	+150°C
-30°C	-10°C	-40°C

#### Sectors: Industrial, Building Machinery



<b>Applications:</b>	Designed for Hydraulic Oil (Group II-2014/68/EU)
<b>Interchange:</b>	Stucchi: Series AX / Faster: Series 2FFI stainless steel / Voswinkel: FH Edelstahl

\*Others upon request.

#### MODEL STRUCTURE

Example:

## 131.21113 AD

Series	Material	Part	Closing	O-rings	Size (S)	Thread
131.	2 SS316	1 Male 2 Female	1 Flat 3 C.U.R.P.	1 NBR 2 VITON 3 EPDM	0 4 1 6.3 2 10 3 12.5 4 16 5 19 6 25 7 30 8 45	1/8" 1/4" 3/8" 1/2" 5/8" 3/4" 1" 1 1/2" 2"
						2 letters (see Table of Threads page 999-1)

\*\*C.U.R.P. Is available in male part only

## 131-20

INTEVA reserves the right to make modifications to its products without prior notice. Any external or internal alterations to our products will automatically void the warranty.



v11



# 131 SERIES CPR

STAINLESS STEEL  
FEMALE THREAD  
BSP / NPTF / DIN 3852

(S) 4 - 1/8"

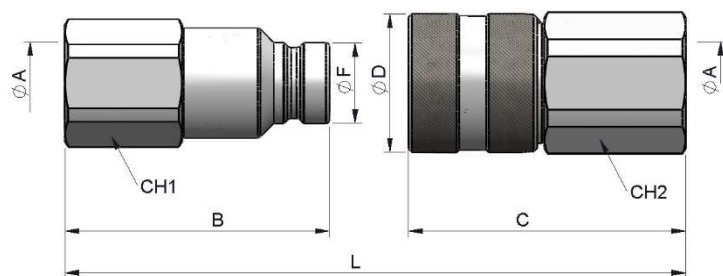

STANDARD MALE MODELS

(S)	ØA	REF.		CH1	B	ØF	L
4	1/8" BSP	131.21120AA		17	38.35	11.65	70.50
	1/8" NPTF	131.21120BA					

STANDARD FEMALE MODELS

(S)	ØA	REF.		CH2	C	ØD	L
4	1/8" BSP	131.22120AA		19	40.2	20	70.50
	1/8" NPTF	131.22120BA					

(S) 6.3 - 1/4"

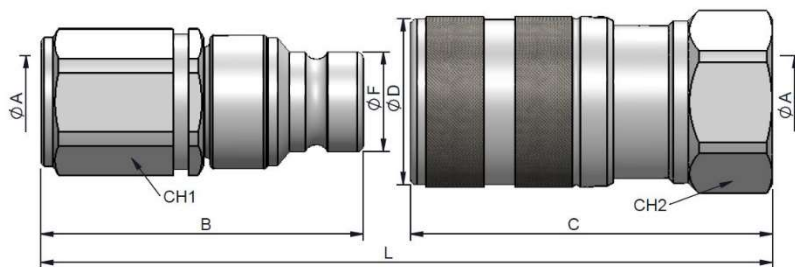

STANDARD MALE MODELS

(S)	ØA	REF.		CH1	B	ØF	L
6.3	1/4" BSP	131.21121AB		22	52.5	16.20	103
	1/4" NPTF	131.21121BB					
	9/16"- 18h UNF	131.21121GD					
	M16X1.5	131.21121ND					
	M18X1.5	131.21121NE					

STANDARD FEMALE MODELS

(S)	ØA	REF.		CH2	C	ØD	L
6.3	1/4" BSP	131.22121AB		27	62	28	103
	1/4" NPTF	131.22121BB					
	9/16"- 18h UNF	131.22121GD					
	M16X1.5	131.22121ND					
	M18X1.5	131.22121NE					

131-21

INTEVA reserves the right to make modifications to its products without prior notice. Any external or internal alterations to our products will automatically void the warranty.





# 131 SERIES CPR

STAINLESS STEEL  
FEMALE THREAD  
BSP / NPTF / DIN 3852

(S) 10 - 3/8"

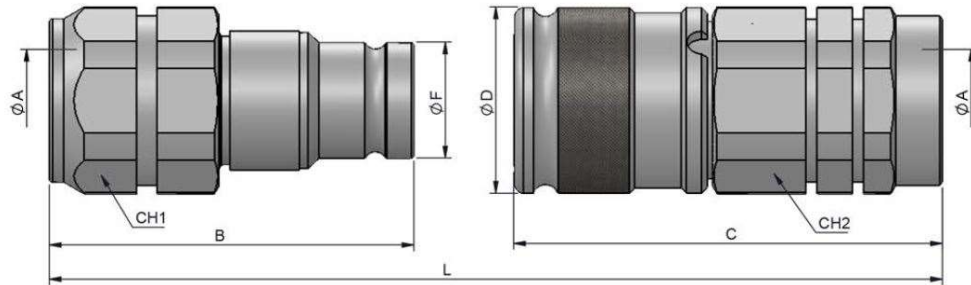

STANDARD MALE MODELS

(S)	ØA	REF.		CH1	B	ØF	L
10	3/8" BSP	131.21122AC		30	62.5	19.80	120
	3/8" NPTF	131.21122BC					
	1/2" BSP	131.21122AD					
	1/2" NPTF	131.21122BD					
	3/4"- 16h UNF	131.21122GF					
	7/8"- 14h UNF	131.21122GH					

STANDARD FEMALE MODELS

(S)	ØA	REF.		CH2	C	ØD	L
10	3/8" BSP	131.22122AC		30	73.5	32	120
	3/8" NPTF	131.22122BC					
	1/2" BSP	131.22122AD					
	1/2" NPTF	131.22122BD					
	3/4"- 16h UNF	131.22122GF					
	7/8"- 14h UNF	131.22122GH					

(S) 12.5 - 1/2"

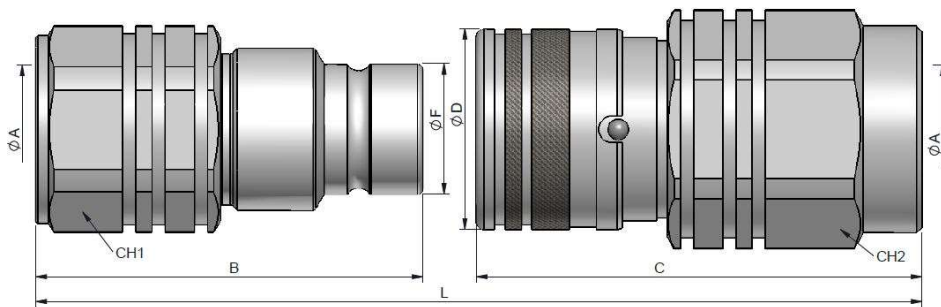

STANDARD MALE MODELS

(S)	ØA	REF.		CH1	B	ØF	L
12.5	1/2" BSP	131.21123AD		36	73	24.50	140
	1/2" NPTF	131.21123BD					
	3/4" BSP	131.21123AE					
	3/4" NPTF	131.21123BE					
	7/8"- 14h UNF	131.21123GH					
	1 1/16"- 12h UN	131.21123GK					

STANDARD FEMALE MODELS

(S)	ØA	REF.		CH2	C	ØD	L
12.5	1/2" BSP	131.22123AD		41	87	38	140
	1/2" NPTF	131.22123BD					
	3/4" BSP	131.22123AE					
	3/4" NPTF	131.22123BE					
	7/8"- 14h UNF	131.22123GH					
	1 1/16"- 12h UN	131.22123GK					

131-22

INTEVA reserves the right to make modifications to its products without prior notice. Any external or internal alterations to our products will automatically void the warranty.



v11



# 131 SERIES CPR

STAINLESS STEEL  
FEMALE THREAD  
BSP / NPTF / DIN 3852

(S) 16 - 5/8"

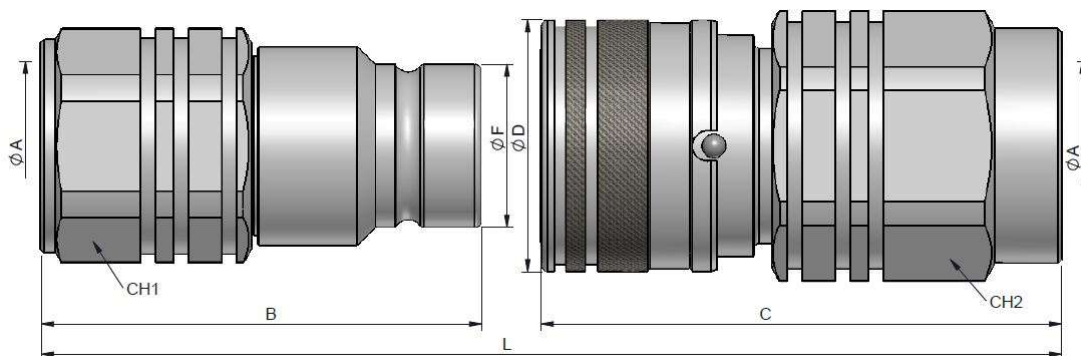

STANDARD MALE MODELS

(S)	ØA	REF.		CH1	B	ØF	L
16	3/4" BSP	131.21124AE		36	73	27	142
	3/4" NPTF	131.21124BE					
	1 1/16" -12h UN	131.21124GK					

STANDARD FEMALE MODELS

(S)	ØA	REF.		CH2	C	ØD	L
16	3/4" BSP	131.22124AE		41	86	42	142
	3/4" NPTF	131.22124BE					
	1 1/16" -12h UN	131.22124GK					

(S) 19 - 3/4"

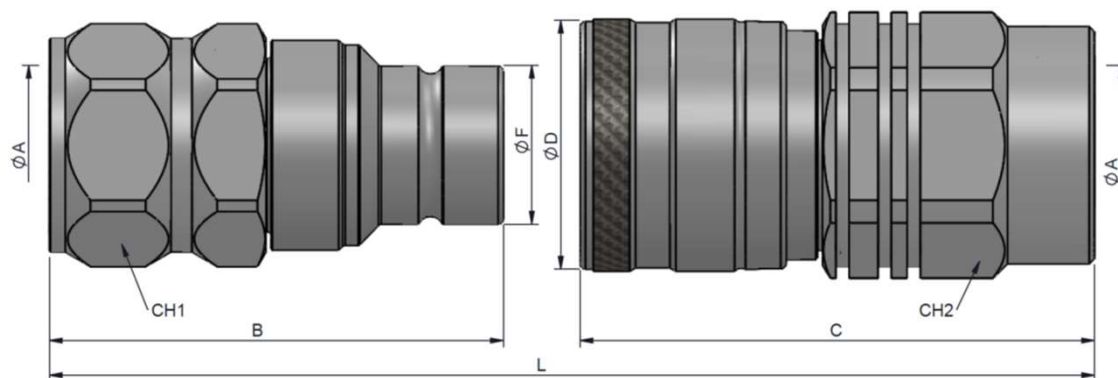

STANDARD MALE MODELS

(S)	ØA	REF.		CH1	B	ØF	L
19	1" BSP	131.21125AF		41	86	30	160
	1" NPTF	131.21125BF					
	1 5/16" - 12h UN	131.21125GO					

STANDARD FEMALE MODELS

(S)	ØA	REF.		CH2	C	ØD	L
19	1" BSP	131.22125AF		46	97.50	48	160
	1" NPTF	131.22125BF					
	1 5/16" - 12h UN	131.22125GO					

131-23

INTEVA reserves the right to make modifications to its products without prior notice. Any external or internal alterations to our products will automatically void the warranty.









# 131 SERIES CPR

STAINLESS STEEL  
FEMALE THREAD  
BSP / NPTF / DIN 3852

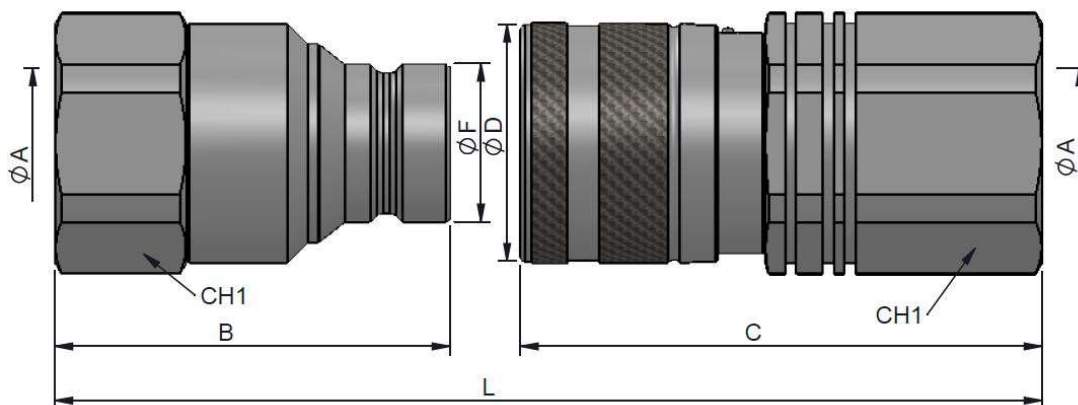
(S) 25 - 1"

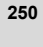

STANDARD MALE MODELS

(S)	ØA	REF.		CH1	B	ØF	L
25	1 1/4" BSP	131.21126AG		55	90	36	178
	1 1/4" NPTF	131.21126BG					

STANDARD FEMALE MODELS

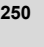
(S)	ØA	REF.		CH2	C	ØD	L
25	1 1/4" BSP	131.22126AG		55	119	54	178
	1 1/4" NPTF	131.22126BG					

(S) 30 - 1 1/2"

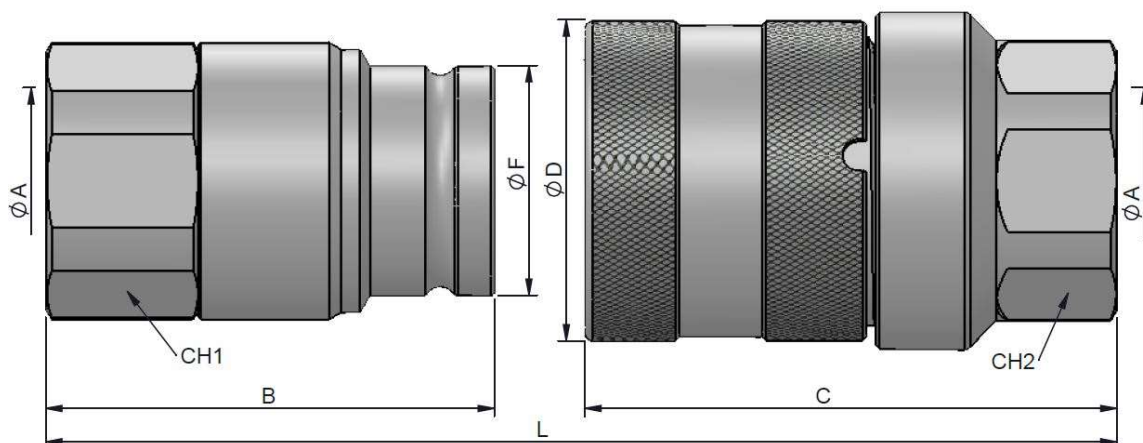

STANDARD MALE MODELS

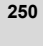
(S)	ØA	REF.		CH1	B	ØF	L
30	1 1/2" BSP	131.21127AH		65	111.5	57	215
	1 1/2" NPTF	131.21127BH					

STANDARD FEMALE MODELS

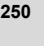
(S)	ØA	REF.		CH2	C	ØD	L
30	1 1/2" BSP	131.22127AH		65	132.20	80	215
	1 1/2" NPTF	131.22127BH					

131-24

INTEVA reserves the right to make modifications to its products without prior notice. Any external or internal alterations to our products will automatically void the warranty.





# 131 SERIES CPR

STAINLESS STEEL  
FEMALE THREAD  
BSP / NPTF / DIN 3852

(S) 45 - 2"

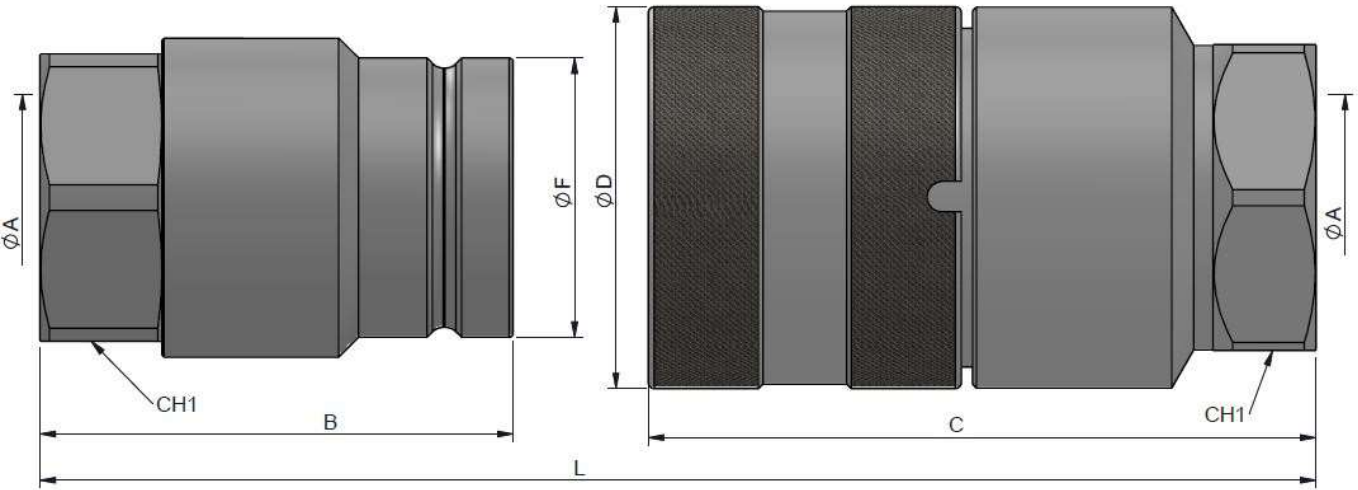

STANDARD MALE MODELS

(S)	ØA	REF.		CH1	B	ØF	L
45	2" BSP	131.21128AI		75	124	73	260

STANDARD FEMALE MODELS

(S)	ØA	REF.		CH2	C	ØD	L
38	2" BSP	131.22128AI		80	175	100	260



# 131 SERIES

## CPR

STAINLESS STEEL

### TECHNICAL DATA

Rated Flow		Min Burst Pressure (Bar)			Max. Working Pressure
	l/m	Male	Female	Coupled	Bar
4	5 l/m	1450	1400	1400	350
6	18 l/m	1450	1400	1400	350
10	45 l/m	1020	1100	1000	250
13	75 l/m	1000	980	1000	250
16	150 l/m	950	970	1000	250
19	200 l/m	950	940	1000	250
25	220 l/m	930	900	1000	250
32	240 l/m	930	890	1000	250
45	288 l/m	700	800	800	200

Test performed according to ISO 18869

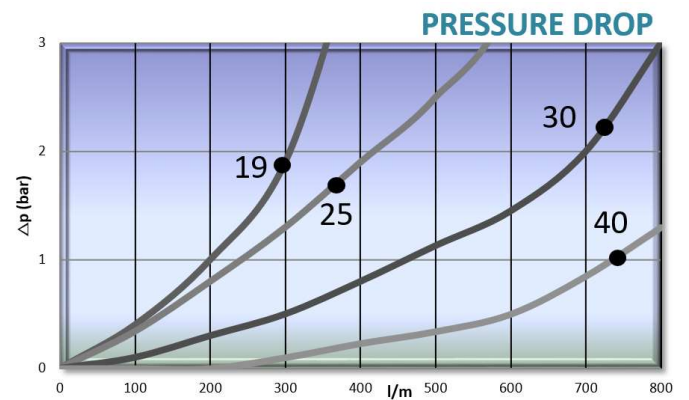
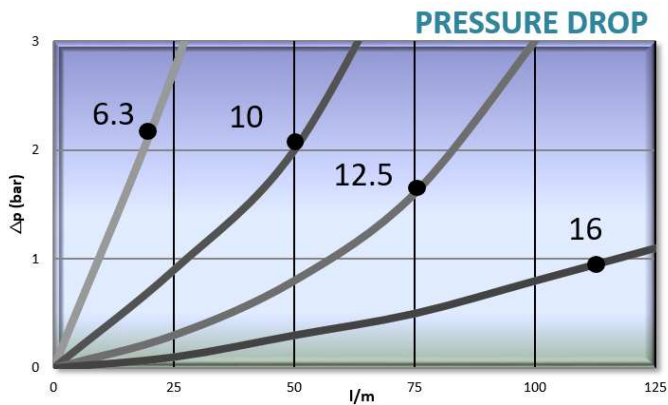

131-26

INTEVA reserves the right to make modifications to its products without prior notice. Any external or internal alterations to our products will automatically void the warranty.



v11



# 131 SERIES CPR

FEMALE FOR UNDERGROUND  
GARBAGE ELEVATORS

Manufactured according to ISO 16028.

## TECHNICAL SPECIFICATIONS

### Features:

Developed for hammer applications and systems with frequent high pulsating pressure.

Nickel plated outer body for a higher corrosion resistance to ensure durability under the most extreme conditions.  
Ergonomically shape for easy connection and disconnection.

Compact flat face that eliminates leaks and contamination of the circuit.

<b>Operating pressure:</b>	Up to 350 Bar	
<b>Materials:</b>	Body:	Carbon Steel EN 10277-3
	O-rings:	NBR / VITON / EPDM
	Back-up-ring:	PTFE
	Springs:	EN 10270-1/SH
	Balls:	AISI 1010/1015
<b>Available Threads:</b>	BSP	
<b>Closing System:</b>	Flat Face	
<b>Connection / Disconnection:</b>	Press to connect / Sleeve Retraction	
<b>Connection Under Pressure:</b>	Not Allowed	

**Available Size:** 3/8"

### Working Temperature (O-rings)

NBR	Viton	EPDM
+100°C	+200°C	+150°C
-30°C	-10°C	-40°C

**Sectors:** Underground garbage elevators

**Applications:** Designed for Hydraulic Oil (Group II-2014/68/EU)

**Interchange:** -

(S) 10 - 3/8"

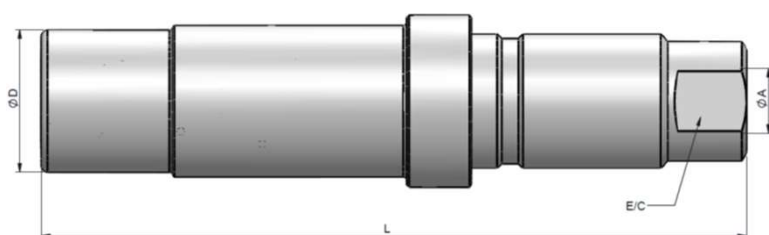

### STANDARD FEMALE MODELS

(S)	ØA	REF.		E/C	ØD	L
10	3/8" BSP	131SB.12112AC	350	24	33	164

## TECHNICAL DATA

Rated Flow	Min Burst Pressure (Bar)			Max. Working Pressure
	Male	Female	Conect.	Bar
45 l/m	1300	1200	1400	350

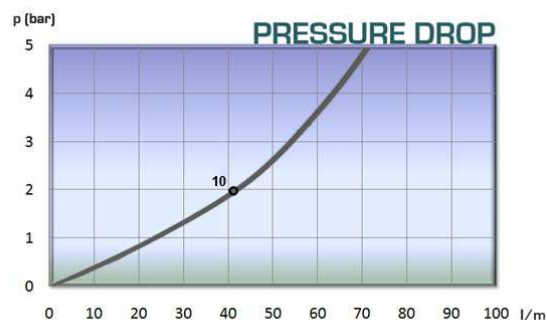

131-27

INTEVA reserves the right to make modifications to its products without prior notice. Any external or internal alterations to our products will automatically void the warranty.





# 131 SERIES CPR

CAPS

INTEVA

Designed to protect female (coupler) and male (nipple) parts while they are disconnected.  
Manufactured according to ISO 16028

## MODEL STRUCTURE / DIMENSIONS

Example:

**131.5313 AA**

Series	Material	Part	Color	Size (S)	Type
131.	5 Plastic	3 Cap Female 4 Cap Male	1 Red	0 04 1/8" 1 6 1/4" 2 10 3/8" 3 13 1/2" 4 16 5/8" 5 19 3/4"	AA

(S) 6 – (S) 19 – PLASTIC

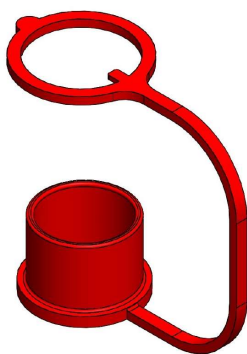

CAP (FEMALE)

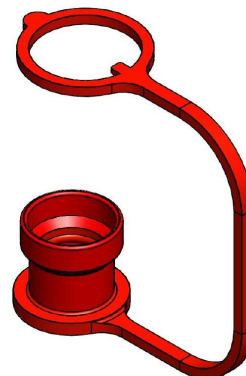

CAP (MALE)

(S)	RED	BLUE	YELLOW	GREEN	BLACK	WHITE
6	131.5311AA	*	*	*	*	*
10	131.5312AA					
13	131.5313AA					
16	131.5314AA					
19	131.5315AA					

\* Available on order

(S)	RED	BLUE	YELLOW	GREEN	BLACK	WHITE
6	131.5411AA	*	*	*	*	*
10	131.5412AA					
13	131.5413AA					
16	131.5414AA					
19	131.5415AA					

**131-28**

INTEVA reserves the right to make modifications to its products without prior notice. Any external or internal alterations to our products will automatically void the warranty.

