



126 SERIES TPL

HIGH FLOW

INTEVA

Available in other materials upon minimum order

TECHNICAL SPECIFICATIONS

Features: High flow rate and reduced pressure drop.
Designed for high pressure applications in cleaning systems.

Operating pressure: Up to 600 Bar

Materials: Body: Carbon Steel EN -10277-3*

O-rings: NBR / VITON

Back-up-ring: PTFE

Springs: EN 10270-1/SH

Balls: AISI 1010/1015

Available Threads: BSP / NPTF*

Closing System: Free Flow (without valve)

Connection: Sleeve Retraction & Press to connect
Disconnection: Sleeve Retraction

Connection Under Pressure: Not Allowed

Available Size: 3/8"

Working Temperature (O-rings)

NBR	Viton	EPDM
+100°C	+200°C	+150°C
-30°C	-10°C	-40°C

Sectors: Industrial, High pressure cleaning systems



Applications: Designed for Hydraulic Oil & Hot Water (Group II- 2014/68/EU)

Interchange: 3/8" TEMA 3800 / KEW

*Others upon request.

MODEL STRUCTURE

Example:

126.12012 AC

Series	Material	Part	Closing	O-rings	Size (S)	Thread
126.	1 Carbon St. 2 SS316 4 Brass 8 Carbon St. Ni. 9 Brass Ni.	1 Male 2 Female	0 Without	0 Without 1 NBR 2 VITON	2 10 3/8"	2 letters (see Table of Threads page 999-1)

126-1

INTEVA reserves the right to make modifications to its products without prior notice. Any external or internal alterations to our products will automatically void the warranty.





126 SERIES TPL HIGH FLOW



(S) 10 - 3/8"

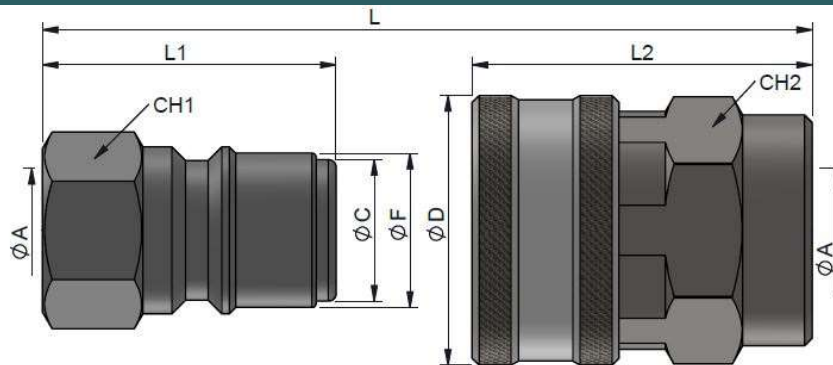

STANDARD MALE MODELS

(S)	ØA	REF.		CH1	L1	ØC	ØF
10	3/8" BSP	126.11012AC		22	38	18	20
	3/8" NPTF	126.11012BC					

STANDARD FEMALE MODELS

(S)	ØA	REF.		CH2	L2	ØD	L
10	3/8" BSP	126.12012AC		30	44	35	58
	3/8" NPTF	126.12012BC					

MODEL STRUCTURE / DIMENSIONS

Example:

125.5372 AA

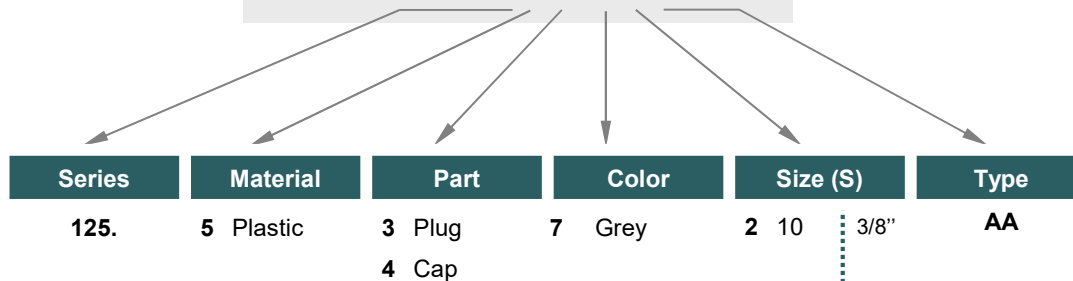

(S) 6 – (S) 25 – PLASTIC

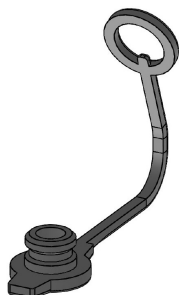

PLUG (COUPLER)

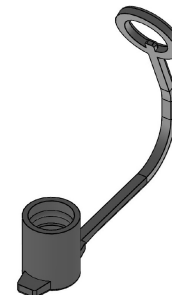

CAP (NIPPLE)

(S)	RED	BLUE	YELLOW	GREEN	BLACK	GREY
10	*	*	*	*	*	125.5372AA

* Not available.

(S)	RED	BLUE	YELLOW	GREEN	BLACK	GREY
10	*	*	*	*	*	125.5472AA

126-2

INTEVA reserves the right to make modifications to its products without prior notice. Any external or internal alterations to our products will automatically void the warranty.

