



# 104 SERIES DIN CARBON STEEL

Size 13 – 1/2" nipples meet ISO 7241 A & ISO 5675

## TECHNICAL SPECIFICATIONS

<b>Operating pressure:</b>	Up to 350 Bar	
<b>Materials:</b>	Body:	Carbon Steel EN 10277-3
	O-rings:	NBR / VITON / EPDM
	Back-up-ring:	PTFE
	Springs:	EN 10270-1/SH
	Balls:	AISI 1010/1015
<b>Available Threads:</b>	BSP / NPTF / ISO 11926 (J1926)*	
<b>Closing System:</b>	Poppet Valve or Ball / C.U.R.P.**	
<b>Connection:</b>	Sleeve Retraction & Press to connect	
<b>Disconnection:</b>	Sleeve Retraction	
<b>Connection Under Pressure:</b>	Not Allowed / Only C.U.R.P. version	

**Available Size:** 1/4" a 1"

### Working Temperature (O-rings)

	NBR	Viton	EPDM
	+100°C	+200°C	+150°C
	-30°C	-10°C	-40°C

### Sectors: Industrial / Agricultural



**Applications:** Designed for Hydraulic Oil (Group II-2014/68/EU)  
**Interchange:** FASTER NV-NS- AEROQUIP FD76 – PARKER 4000 – SNAP-TITE 60

\*Others upon request.

## MODEL STRUCTURE

Example:

**104.11122 AC**

Series	Material	Part	Closing	O-rings	Size (S)	Thread
104.	1 Carbon St.	1 Male	0 Without	0 Without	1 6	1/4"
		2 Female	1 Poppet	1 NBR	2 10	3/8"
			2 Ball	2 VITON	3 13	1/2"
			3 C.U.R.P	3 EPDM	4 20	3/4"
					5 25	1"

2 letters (see Table of Threads page 999-1)

\*\* (S) 13 - 1/2" available only.

**104-1**

INTEVA reserves the right to make modifications to its products without prior notice. Any external or internal alterations to our products will automatically void the warranty.





# 104 SERIES DIN

POPPET VALVE

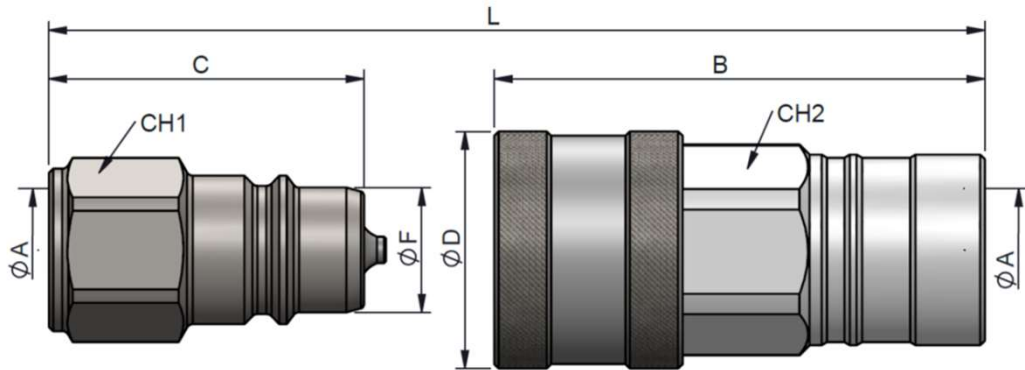

(S) 6 - 1/4"



STANDARD MALE MODELS

(S)	ØA	REF.		CH1	L1	ØF	L
6	1/4" BSP	104.11111AB		19	36	14	72
	1/4" NPTF	104.11111BB					
	9/16"-18h UNF (ORB)	104.11111GD					



STANDARD FEMALE MODELS

(S)	ØA	REF.		CH2	L2	ØD	L
6	1/4" BSP	104.12111AB		22	53.50	27	72
	1/4" NPTF	104.12111BB					
	9/16"-18h UNF (ORB)	104.12111GD					

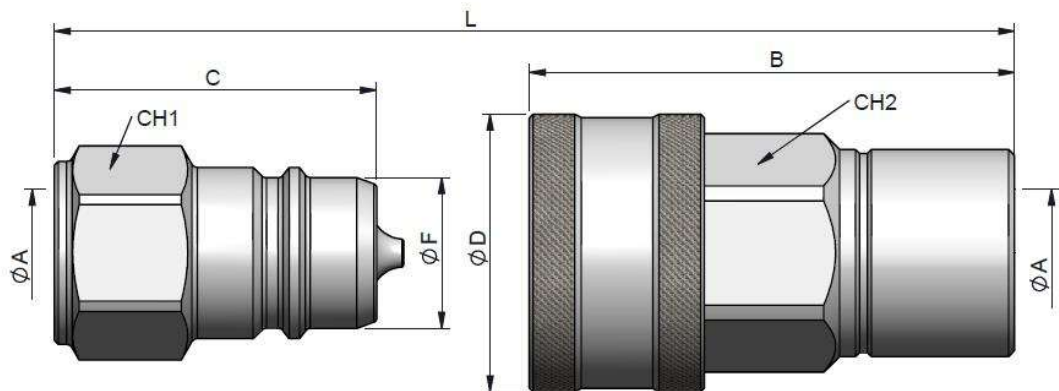

(S) 10 - 3/8"



STANDARD MALE MODELS

(S)	ØA	REF.		CH1	L1	ØF	L
10	3/8" BSP	104.11112AC		24	40.50	19	81
	3/8" NPTF	104.11112BC					

STANDARD FEMALE MODELS

(S)	ØA	REF.		CH2	L2	ØD	L
10	3/8" BSP	104.12112AC		27	61	35	81
	3/8" NPTF	104.12112BC					

L= Total length when Male and Female are connected.

# 104 SERIES DIN

POPPET VALVE

(S) 13 - 1/2"



C.U.R.P. System available  
Allows connection under residual  
pressure.

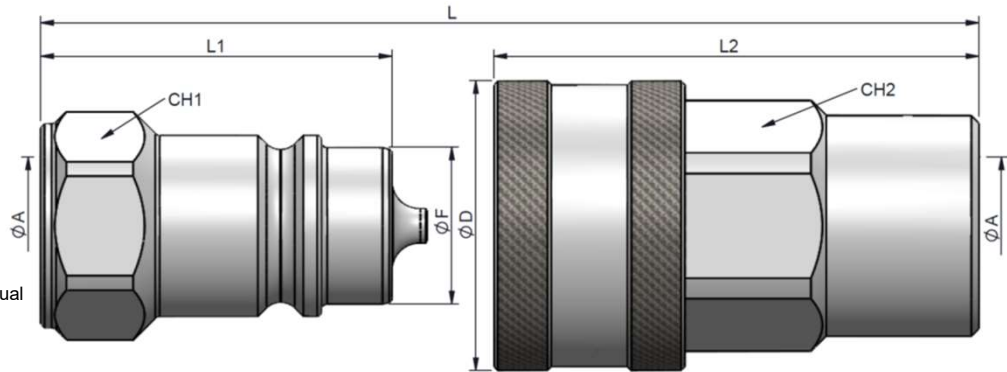

STANDARD MALE MODELS

(S)	ØA	REF.		CH1	L1	ØF	L
13	1/2" BSP	101.11113AD		27/30	46	20.50	87.50
	1/2" NPTF	101.11113BD					
	M22X1.5	101.11113NG		27/30			
	3/4"-16h UNF (ORB)	101.11113GF		27/30			
	7/8"-14h UNF (ORB)	101.11113GH		27/30			

STANDARD FEMALE MODELS

(S)	ØA	REF.		CH2	L2	ØD	L
13	1/2" BSP	101.12113AD		300r	30	63.50	38
	1/2" NPTF	101.12113BD					
	M22X1.5	101.12113NG					
	3/4"-16h UNF (ORB)	101.12113GF					
	7/8"-14h UNF (ORB)	101.12113GH					

(S) 20 - 3/4"

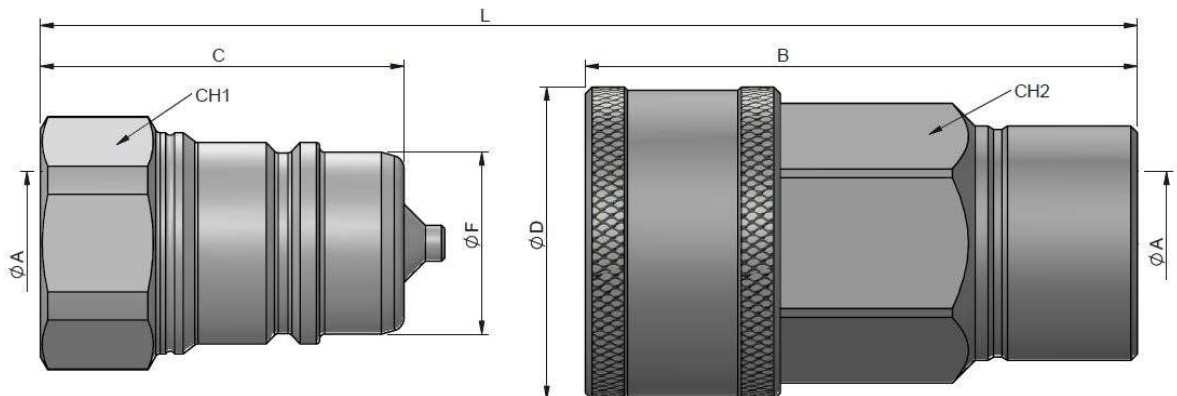

STANDARD MALE MODELS

(S)	ØA	REF.		CH1	L1	ØF	L
19	3/4" BSP	104.11114AE		250	36	56	28
	3/4" NPTF	104.11114BE					

STANDARD FEMALE MODELS

(S)	ØA	REF.		CH2	L2	ØD	L
19	3/4" BSP	104.12114AE		250	38	85	48
	3/4" NPTF	104.12114BE					

L= Total length when Male and Female are connected.

104-3

INTEVA reserves the right to make modifications to its products without prior notice. Any external or internal alterations to our products will automatically void the warranty.





# 104 SERIES DIN

POPPET VALVE



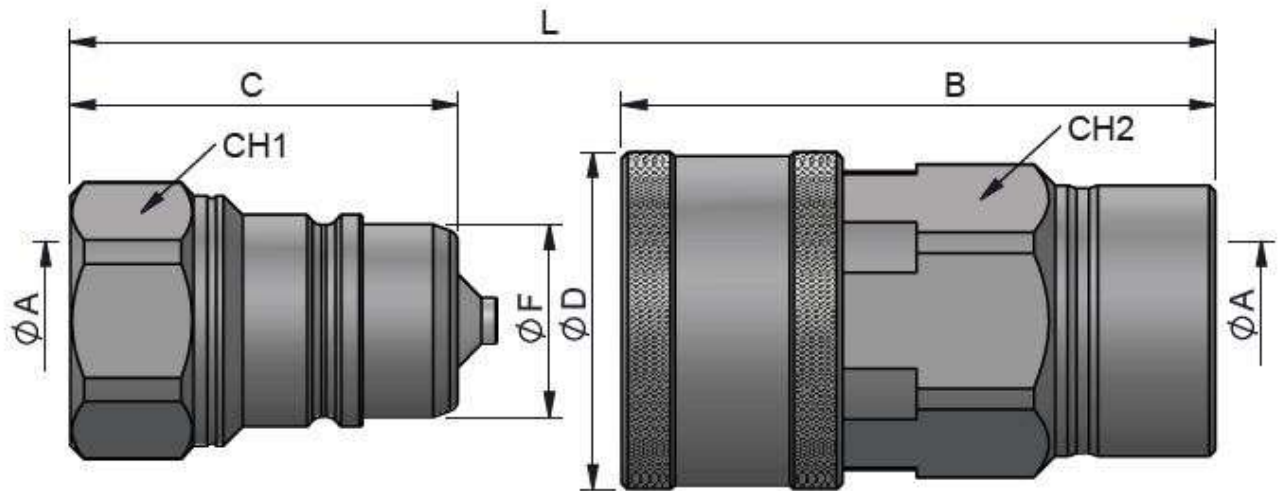

(S) 25 - 1"

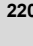

STANDARD MALE MODELS

(S)	ØA	REF.		CH1	L1	ØF	L
25	1" BSP	104.11115AF		41	63	31	126
	1" NPTF	104.11115BF					

STANDARD FEMALE MODELS

(S)	ØA	REF.		CH2	L2	ØD	L
25	1" BSP	104.12112AC		46	96.50	55	126
	1" NPTF	104.12112BC					

L= Total length when Male and Female are connected.





# 104 SERIES DIN BALL VALVE



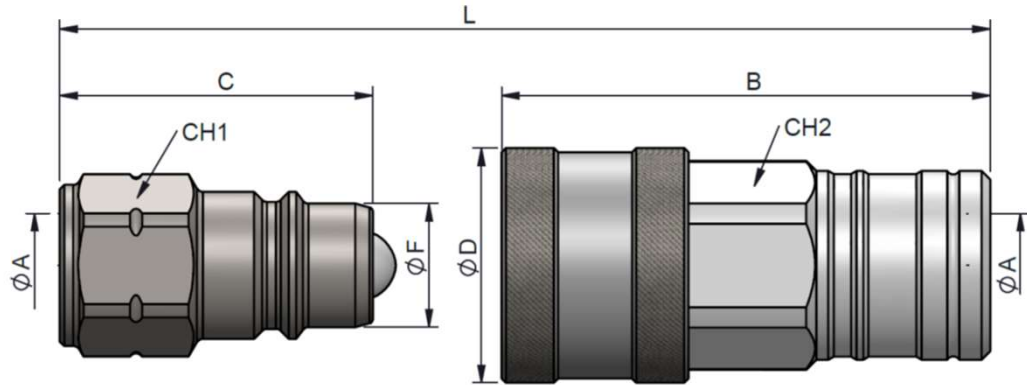

(S) 6 - 1/4"



STANDARD MALE MODELS

(S)	ØA	REF.		CH1	L1	ØF	L
6	1/4" BSP	104.11211AB		19	36	14	72
	1/4" NPTF	104.11211BB					
	9/16"-18h UNF (ORB)	104.11211GD					



STANDARD FEMALE MODELS

(S)	ØA	REF.		CH2	L2	ØD	L
6	1/4" BSP	104.12211AB		22	53.50	27	72
	1/4" NPTF	104.12211BB					
	9/16"-18h UNF (ORB)	104.12211GD					

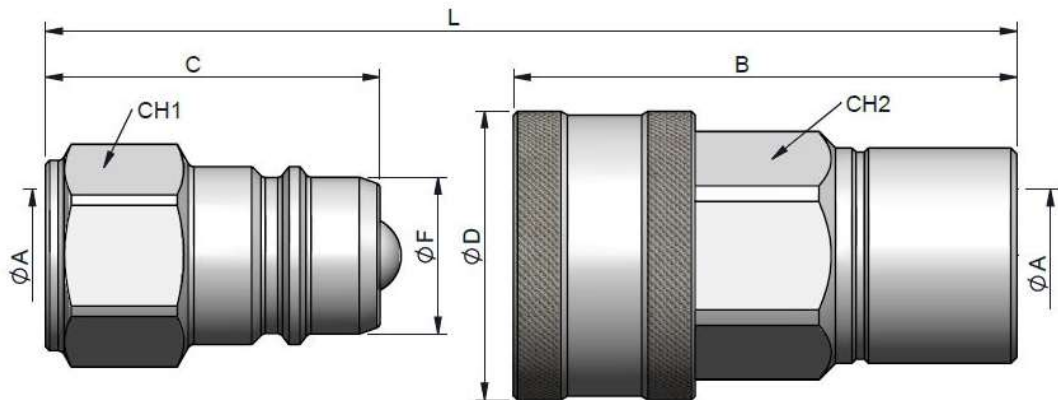

(S) 10 - 3/8"



STANDARD MALE MODELS

(S)	ØA	REF.		CH1	L1	ØF	L
10	3/8" BSP	104.11212AC		24	40.50	19	81
	3/8" NPTF	104.11212BC					

STANDARD FEMALE MODELS

(S)	ØA	REF.		CH2	L2	ØD	L
10	3/8" BSP	104.12212AC		27	61	35	81
	3/8" NPTF	104.12212BC					

.L= Total length when Male and Female are connected.



# 104 SERIES DIN BALL VALVE



(S) 13 - 1/2"

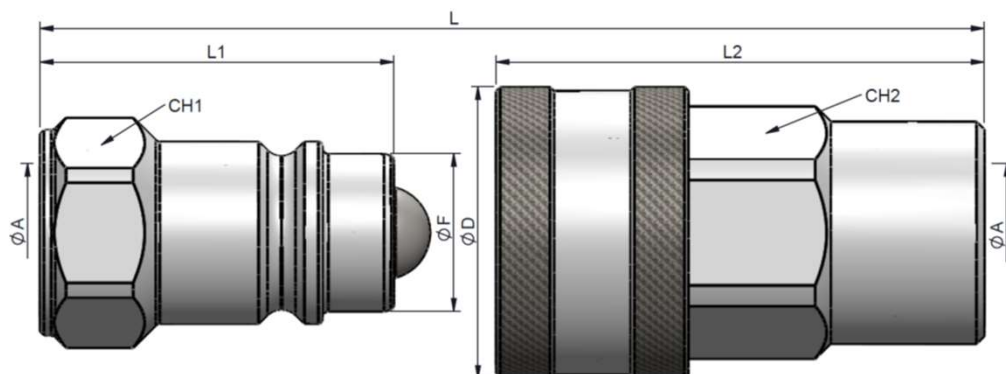

STANDARD MALE MODELS

(S)	ØA	REF.		CH1	L1	ØF	L
13	1/2" BSP	101.11213AD		27/30	46	20.50	87.50
	1/2" NPTF	101.11213BD					
	M22X1.5	101.11213NG		27/30			
	3/4"-16h UNF (ORB)	101.11213GF		27/30			
	7/8"-14h UNF (ORB)	101.11213GH		27/30			

STANDARD FEMALE MODELS

(S)	ØA	REF.		CH2	L2	ØD	L
13	1/2" BSP	101.12213AD		30	63.50	38	87.50
	1/2" NPTF	101.12213BD					
	M22X1.5	101.12213NG					
	3/4"-16h UNF (ORB)	101.12213GF					
	7/8"-14h UNF (ORB)	101.12213GH					

(S) 20 - 3/4"

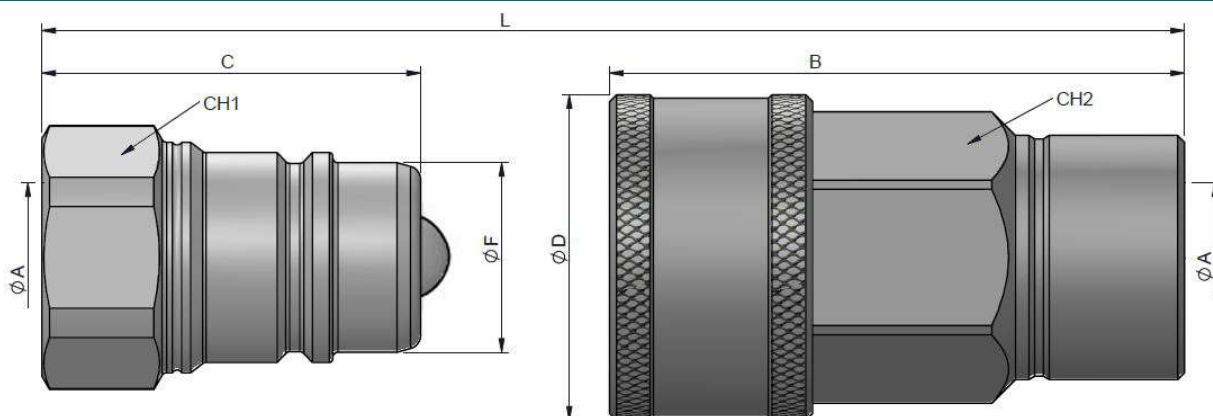

STANDARD MALE MODELS

(S)	ØA	REF.		CH1	L1	ØF	L
19	3/4" BSP	101.11214AE		36	56	29	112
	3/4" NPTF	101.11214BE					

STANDARD FEMALE MODELS

(S)	ØA	REF.		CH2	L2	ØD	L
19	3/4" BSP	101.12214AE		38	83.5	46	112
	3/4" NPTF	101.12214BE					

L= Total length when Male and Female are connected.



# 104 SERIES DIN

BALL VALVE



(S) 25 - 1"

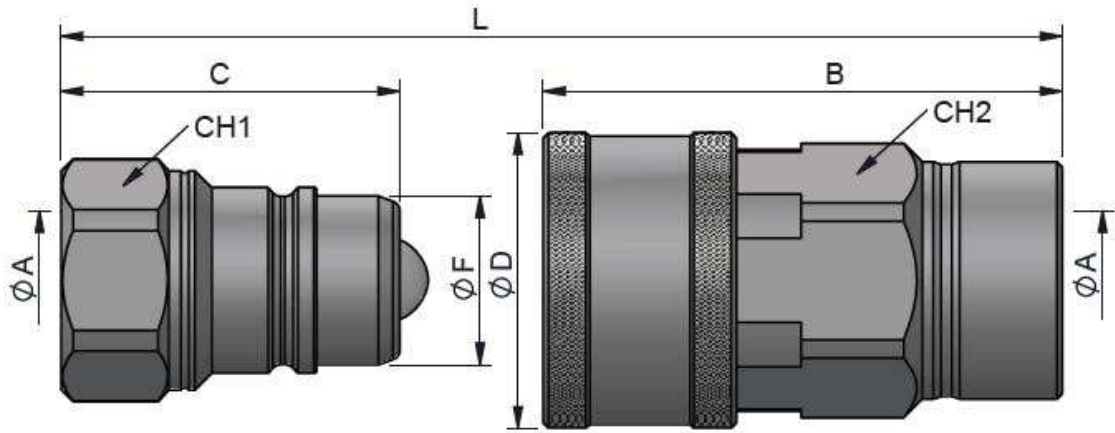

STANDARD MALE MODELS

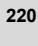
(S)	ØA	REF.		CH1	L1	ØF	L
25	1" BSP	104.11215AF		41	63	31	126
	1" NPTF	104.11215BF					

STANDARD FEMALE MODELS

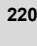
(S)	ØA	REF.		CH2	L2	ØD	L
25	1" BSP	104.12215AF		46	96.50	55	126
	1" NPTF	104.12215BF					

L = Total length when Male and Female are connected.

104-7

INTEVA reserves the right to make modifications to its products without prior notice. Any external or internal alterations to our products will automatically void the warranty.





# 104 SERIES DIN

CARBON STEEL

## TECHNICAL DATA

(S)	Rated Flow	Min. Burst Pressure (Bar)			Max. Working Pressure
		Male	Female	Coupled	
6	15 l/m	1650	1800	1400	350
10	35 l/m	1250	1350	1200	300
13	45 l/m	1200	1300	1200	300
20	74 l/m	1030	1200	1000	250
25	100 l/m	950	980	920	220

Test performed according to ISO 18869

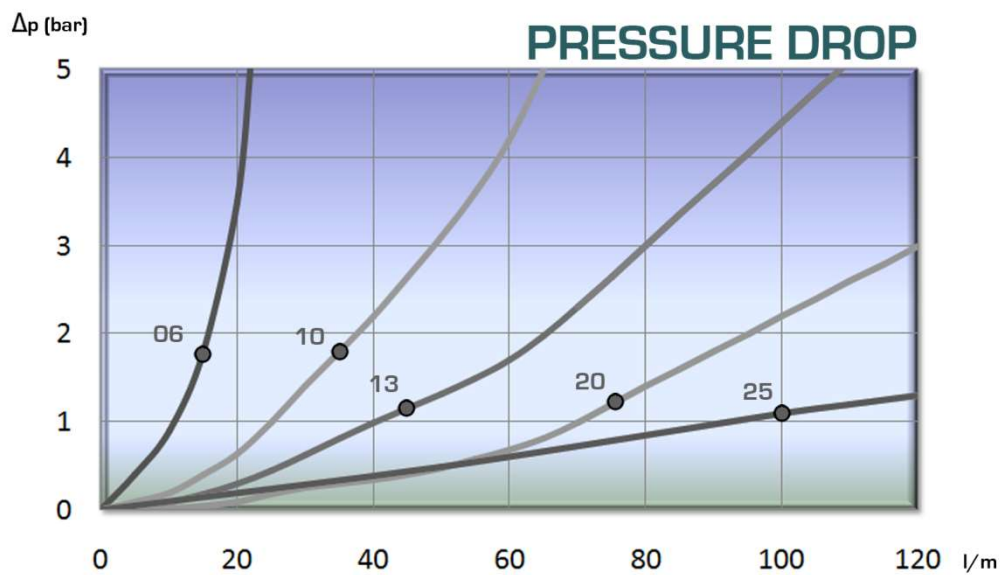

104-8

INTEVA reserves the right to make modifications to its products without prior notice. Any external or internal alterations to our products will automatically void the warranty.





# 104 SERIES DIN

PLUGS  
& CAPS

INTEVA

Designed to protect female (coupler) and male (nipple) parts while they are disconnected.  
Size 13 – 1/2" manufactured according to ISO 7241-A & ISO 5675 norms

## MODEL STRUCTURE / DIMENSIONS

Example:

**104.5353 AA**

Series	Material	Part	Color	Size (S)	Type
101.	5 Plastic	3 Plug	0 Plain Metal	1 6	AA
104.		4 Cap	1 Red	2 10	
			2 Blue	3 13	
			3 Yellow	4 20	
			4 Green	5 25	
			5 Black		
			6 White		

## (S) 6 – (S) 25 – PLASTIC

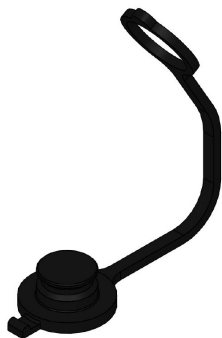

PLUG (COUPLER)



CAP (NIPPLE)

(S)	RED	BLUE	YELLOW	GREEN	BLACK	WHITE
6	*	*	*	*	104.5351AA	*
10	*	*	*	*	104.5352AA	*
13	*	*	*	*	101.5353AA	*
20	*	*	*	*	104.5354AA	*
25	*	*	*	*	104.5355AA	*

(S)	RED	BLUE	YELLOW	GREEN	BLACK	WHITE
6	*	*	*	*	104.5451AA	*
10	*	*	*	*	104.5452AA	*
13	*	*	*	*	101.5453AA	*
20	*	*	*	*	104.5454AA	*
25	*	*	*	*	104.5455AA	*

\* Not available. Only size 13 - 1/2" on minimum order.

104-9

INTEVA reserves the right to make modifications to its products without prior notice. Any external or internal alterations to our products will automatically void the warranty.

