



101 SERIES

ISO-A CARBON STEEL

Manufactured according to ISO 7241-A
(1/2" and 3/4" conform to ISO 5675)

TECHNICAL SPECIFICATIONS

Operating pressure:	Up to 350 Bar
Materials:	Body: Carbon Steel EN 10277-3 O-rings: NBR / VITON / EPDM Back-up-ring: PTFE Springs: EN 10270-1/SH Balls: AISI 1010/1015
Available Threads:	BSP / NPTF / ISO 11926 (J1926)*
Closing System:	Poppet Valve or Ball / C.U.R.P.**
Connection:	Sleeve Retraction & Press to connect
Disconnection:	Sleeve Retraction
Connection Under Pressure:	Not Allowed / Only C.U.R.P. version**

Available Size: 1/4" a 2"

Working Temperature (O-rings)

NBR	Viton	EPDM
+100°C	+200°C	+150°C
-30°C	-10°C	-40°C

Sectors: Industrial / Agricultural



Applications: Designed for Hydraulic Oil (Group II-2014/68/EU)

Interchange: FASTER ANV - AEROQUIP FD56
PARKER 6600 - SNAP-TITE 61

**Others upon request.*

MODEL STRUCTURE

Example:

101.11112 BC

Series	Material	Part	Closing	O-rings	Size (S)	Thread
101.	1 Carbon St. 2 SS316 3 SS303 4 Brass	1 Male 2 Female	0 Without 1 Poppet 2 Ball 3 C.U.R.P*	0 Without 1 NBR 2 VITON 3 EPDM	1 6 1/4" 2 10 3/8" 3 13 1/2" 4 20 3/4" 5 25 1" 6 32 1 1/4" 7 40 1 1/2" 8 50 2"	2 letters (see Table of Threads page 999-1)

** Size 13 - 1/2" available only.

101-1

INTEVA reserves the right to make modifications to its products without prior notice. Any external or internal alterations to our products will automatically void the warranty.





101 SERIES

ISO-A CARBON STEEL

(S) 6 - 1/4"

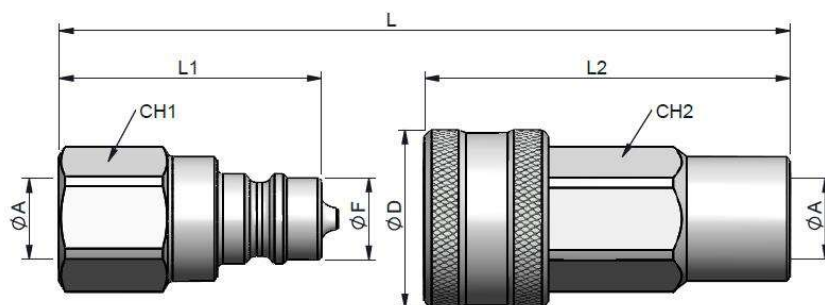

STANDARD MALE MODELS

(S)	ØA	REF.		CH1	L1	ØF	L
6	1/4" BSP	101.11111AB		350	19	12	76
	1/4" NPTF	101.11111BB					

STANDARD FEMALE MODELS

(S)	ØA	REF.		CH2	L2	ØD	L
6	1/4" BSP	101.12111AB		350	19	53	26
	1/4" NPTF	101.12111BB					

(S) 10 - 3/8"

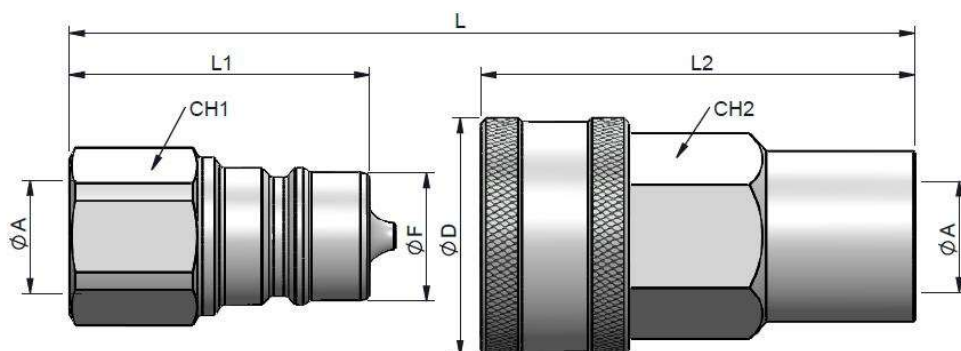

STANDARD MALE MODELS

(S)	ØA	REF.		CH1	L1	ØF	L
10	3/8" BSP	101.11112AC		300	22	17	81
	3/8" NPTF	101.11112BC					
	3/8" BSPT	101.11112DC					
	9/16" 18h UNF (ORB)	101.11112GC					

STANDARD FEMALE MODELS

(S)	ØA	REF.		CH2	L2	ØD	L
10	3/8" BSP	101.12112AC		300	24	58.50	32
	3/8" NPTF	101.12112BC					
	3/8" BSPT	101.12112DC					
	9/16" 18h UNF (ORB)	101.12112GC					

L= Total length when Male and Female are connected.

101-2

INTEVA reserves the right to make modifications to its products without prior notice. Any external or internal alterations to our products will automatically void the warranty.





101 SERIES

ISO-A CARBON STEEL

(S) 13 - 1/2"

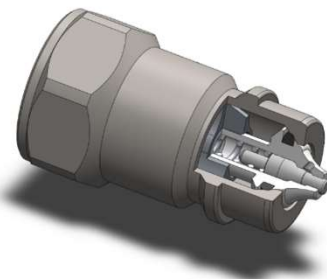
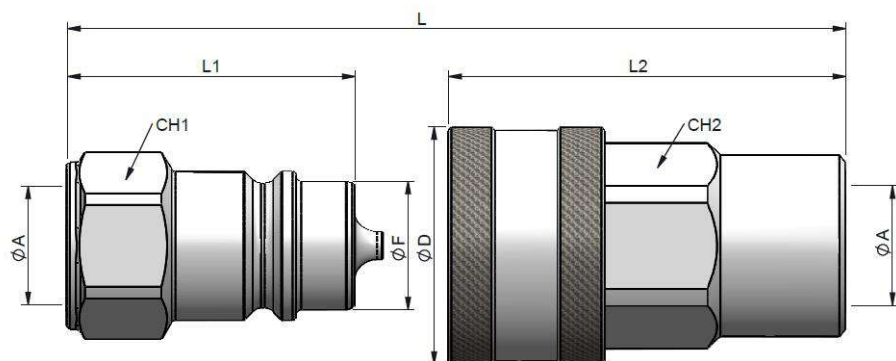

C.U.R.P. System available
Allows connection under
residual pressure.

STANDARD MALE MODELS

(S)	ØA	REF.		CH1	L1	ØF	L
13	1/2" BSP	101.11113AD	300	27/30	46	20.50	87.50
	1/2" NPTF	101.11113BD					
	M22X1.5	101.11113NG		27/30			
	3/4"-16h UNF (ORB)	101.11113GF		27/30			
	7/8"-14h UNF (ORB)	101.11113GH		27/30			

STANDARD FEMALE MODELS

(S)	ØA	REF.		CH2	L2	ØD	L
13	1/2" BSP	101.12113AD	300	30	63.50	38	87.50
	1/2" NPTF	101.12113BD					
	M22X1.5	101.12113NG					
	3/4"-16h UNF (ORB)	101.12113GF					
	7/8"-14h UNF (ORB)	101.12113GH					

(S) 20 - 3/4"

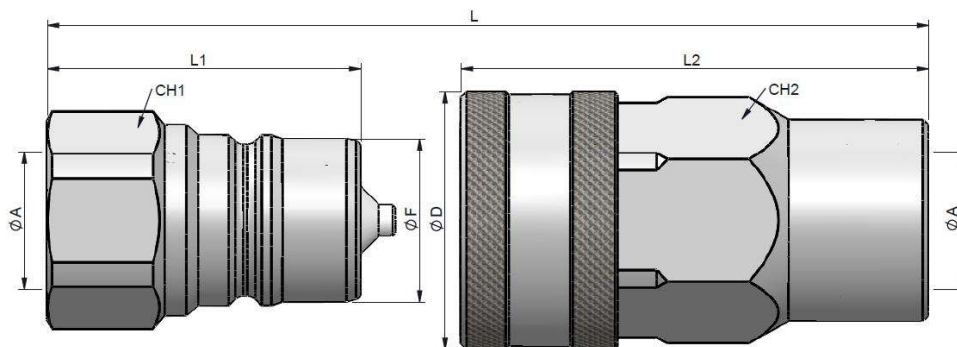

STANDARD MALE MODELS

(S)	ØA	REF.		CH1	L1	ØF	L
20	3/4" BSP	101.11114AE	250	36	56	29	112
	3/4" NPTF	101.11114BE					
	1 1/16"-12h UN (ORB)	101.11114GK					

STANDARD FEMALE MODELS

(S)	ØA	REF.		CH2	L2	ØD	L
20	3/4" BSP	101.12114AE	250	38	83.5	46	112
	3/4" NPTF	101.12114BE					
	1 1/16"-12h UN (ORB)	101.12114GK					

L= Total length when Male and Female are connected.

101-3

INTEVA reserves the right to make modifications to its products without prior notice. Any external or internal alterations to our products will automatically void the warranty.







101 SERIES

ISO-A CARBON STEEL

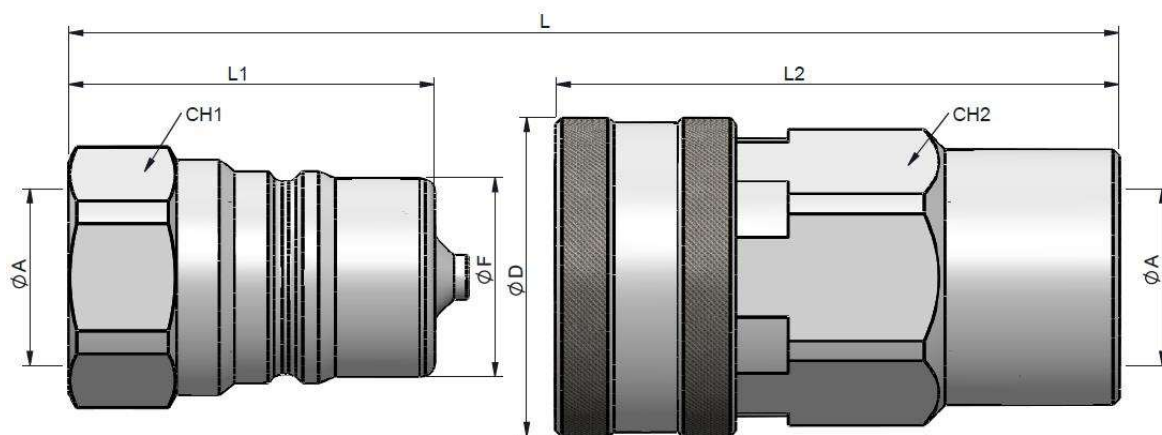

(S) 25 - 1"



STANDARD MALE MODELS

(S)	ØA	REF.		CH1	L1	ØF	L
25	1" BSP	101.11115AF		41	63	34	126
	1" NPTF	101.11115BF					
	1 5/16"-12h UN (ORB)	101.11115GO					



STANDARD FEMALE MODELS

(S)	ØA	REF.		CH2	L2	ØD	L
25	1" BSP	101.12115AF		46	97	55	126
	1" NPTF	101.12115BF					
	1 5/16"-12h UN (ORB)	101.12115GO					

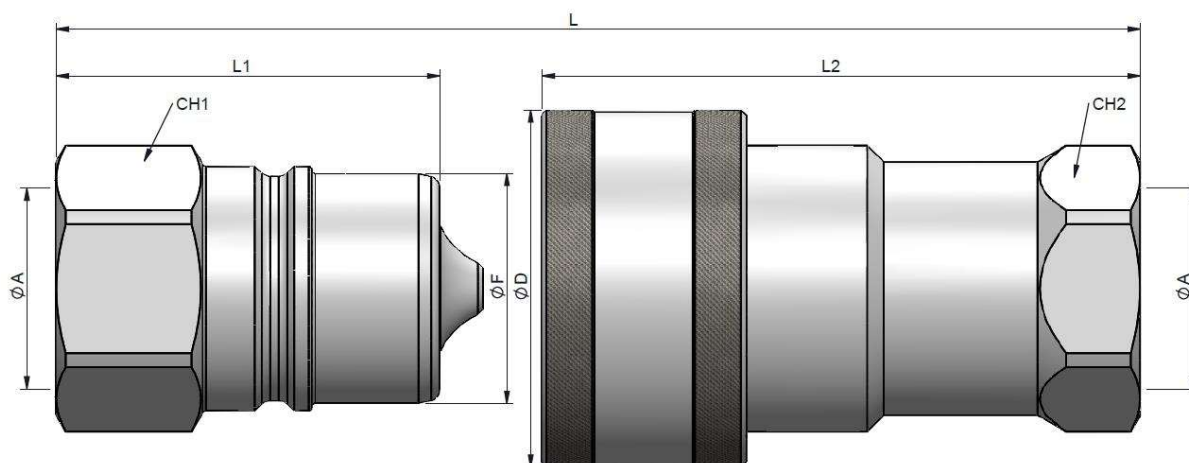

(S) 32 - 1 1/4"



STANDARD MALE MODELS

(S)	ØA	REF.		CH1	L1	ØF	L
32	1 1/4" BSP	101.11116AG		50	75	45	150
	1 1/4" NPTF	101.11116BG					

STANDARD FEMALE MODELS

(S)	ØA	REF.		CH1	L1	ØF	L
32	1 1/4" BSP	101.12116AG		50	117	70	150
	1 1/4" NPTF	101.12116BG					

L= Total length when Male and Female are connected.

101-4

INTEVA reserves the right to make modifications to its products without prior notice. Any external or internal alterations to our products will automatically void the warranty.





101 SERIES

ISO-A CARBON STEEL

(S) 40 - 1 1/2"

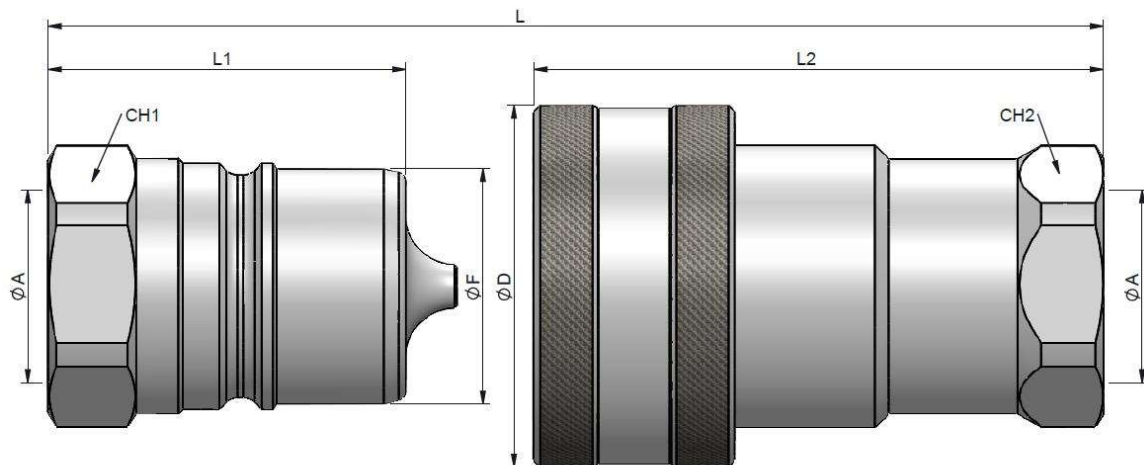

STANDARD MALE MODELS

(S)	ØA	REF.		CH1	L1	ØF	L
40	1 1/2" BSP	101.11117AH		60	83.5	55	167
	1 1/2" NPTF	101.11117BH					

STANDARD FEMALE MODELS

(S)	ØA	REF.		CH2	L2	ØD	L
40	1 1/2" BSP	101.12117AH		60	133	84.50	167
	1 1/2" NPTF	101.12117BH					

(S) 50 - 2"

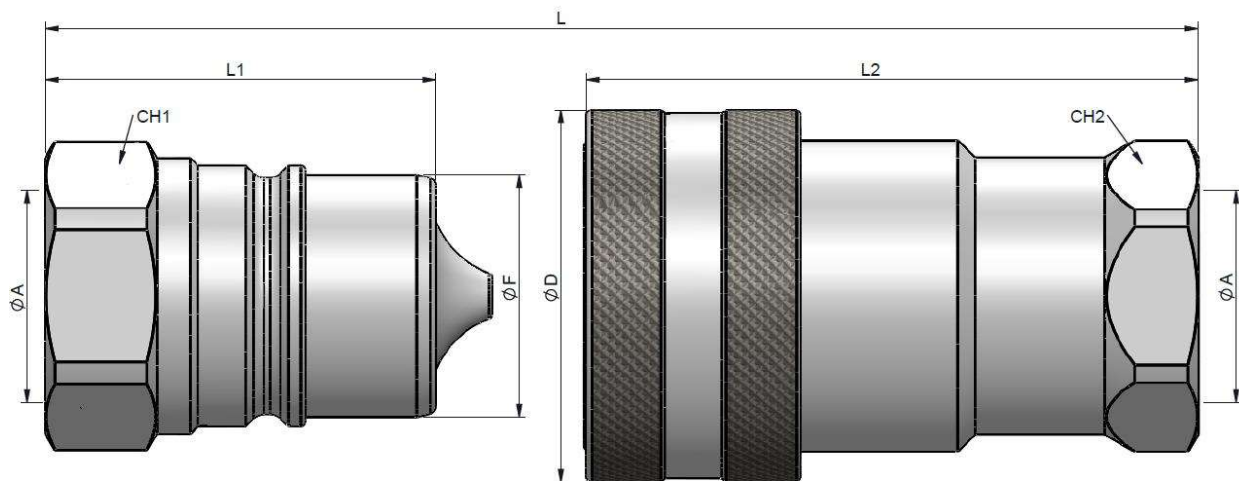

STANDARD MALE MODELS

(S)	ØA	REF.		CH1	L1	ØF	L
50	2" BSP	101.11118AI		75	105	65	210
	2" NPTF	101.11118BI					

STANDARD FEMALE MODELS

(S)	ØA	REF.		CH2	L2	ØD	L
50	2" BSP	101.12118AI		75	165	100	210
	2" NPTF	101.12118BI					

L= Total length when Male and Female are connected.

101-5

INTEVA reserves the right to make modifications to its products without prior notice. Any external or internal alterations to our products will automatically void the warranty.





101 SERIES

ISO-A CARBON STEEL

TECHNICAL DATA

(S)	Rated Flow	Min. Burst Pressure (Bar)			Max. Working Pressure
		Male	Female	Coupled	
6	15 l/min	1650	1800	1400	350
10	35 l/min	1250	1350	1200	300
13	45 l/min	1200	1300	1200	300
20	74 l/min	1030	1200	1000	250
25	100 l/min	950	980	920	230
32	118 l/min	800	950	920	230
40	410 l/min	750	850	800	200
50	860 l/min	620	650	520	130

Test performed according to ISO 18869

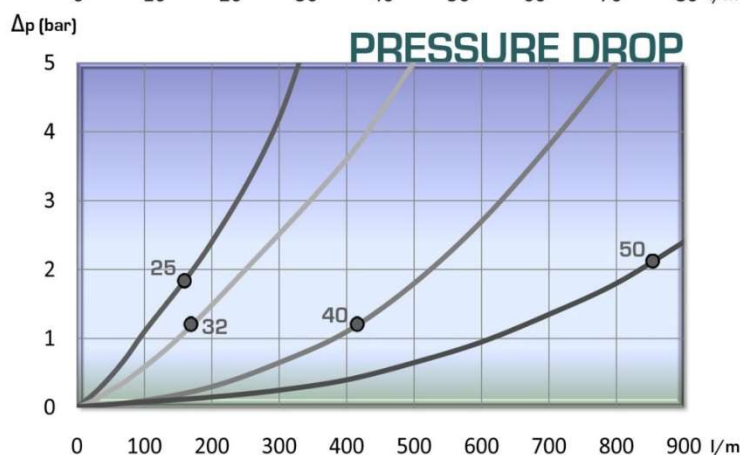
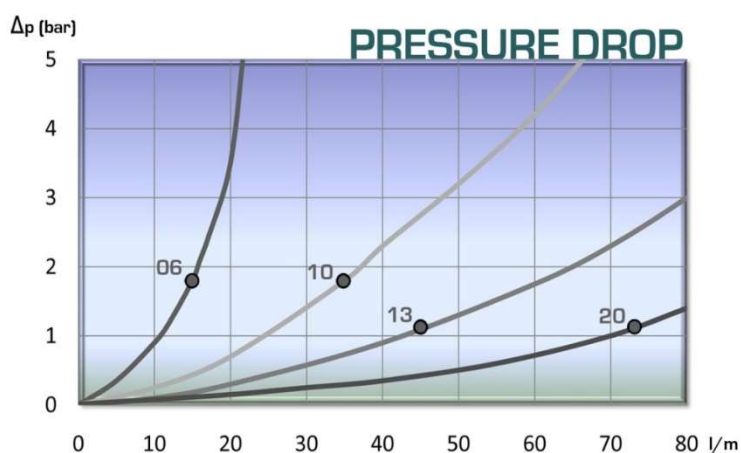



101 SERIES

ISO-A

STAINLESS STEEL
BRASS

Manufactured according to ISO 7241-A
(Size 1/2" according to ISO 5675 requirements)

TECHNICAL SPECIFICATIONS

Operating pressure:	Up to 280 Bar	
Materials:	Body:	SS303 / SS316 / BRASS
	O-rings:	NBR / VITON / EPDM
	Back-up-ring:	PTFE
	Springs:	EN 10270-1/SH
	Balls:	AISI 1010/1015/SS316
Available Threads:	BSP / NPTF / ISO 11926 (J1926)*	
Closing System:	Poppet Valve or Ball	
Connection:	Sleeve Retraction & Press to connect	
Disconnection:	Sleeve Retraction	
Connection Under Pressure:	Not Allowed	

Available Size: 1/4" a 2"

Working Temperature (O-rings)

NBR	Viton	EPDM
+100°C	+200°C	+150°C
-30°C	-10°C	-40°C

Sectors: Industrial / Agricultural



Applications: Designed for Hydraulic Oil (Group II-2014/68/EU)
Interchange: FASTER ANV - AEROQUIP FD56
 PARKER 6600 - SNAP-TITE 61

*Others upon request.

MODEL STRUCTURE

Example:

101.21123 AD

Series	Material	Part	Closing	O-rings	Size (S)	Thread
101.	1 Carbon St.	1 Male	0 Without	0 Without	1 6	1/4"
	2 SS316	2 Female	1 Poppet	1 NBR	2 10	3/8"
	3 SS303		2 Ball	2 VITON	3 13	1/2"
	4 Brass			3 EPDM	4 20	3/4"
					5 25	1"
					6 32	1 1/4"
					7 40	1 1/2"
					8 50	2"

101-7

INTEVA reserves the right to make modifications to its products without prior notice. Any external or internal alterations to our products will automatically void the warranty.





101 SERIES

ISO-A SS316

(S) 6 - 1/4"

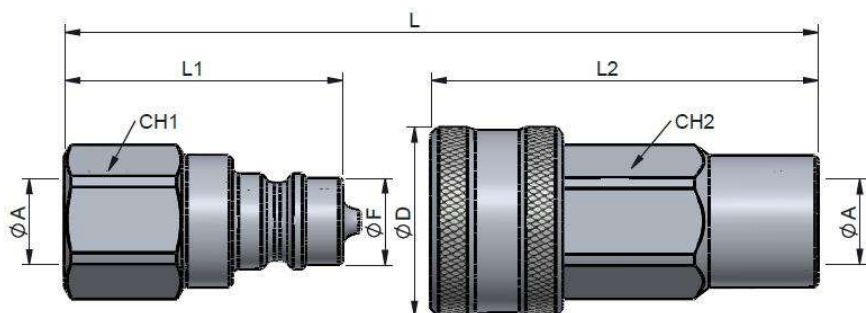

STANDARD MALE MODELS

(S)	ØA	REF.		CH1	L1	ØF	L
6	1/4" BSP	101.21121AB		19	38	12	76
	1/4" NPTF	101.21121BB					

STANDARD FEMALE MODELS

(S)	ØA	REF.		CH2	L2	ØD	L
6	1/4" BSP	101.22121AB		19	53	26	76
	1/4" NPTF	101.22121BB					

(S) 10 - 3/8"

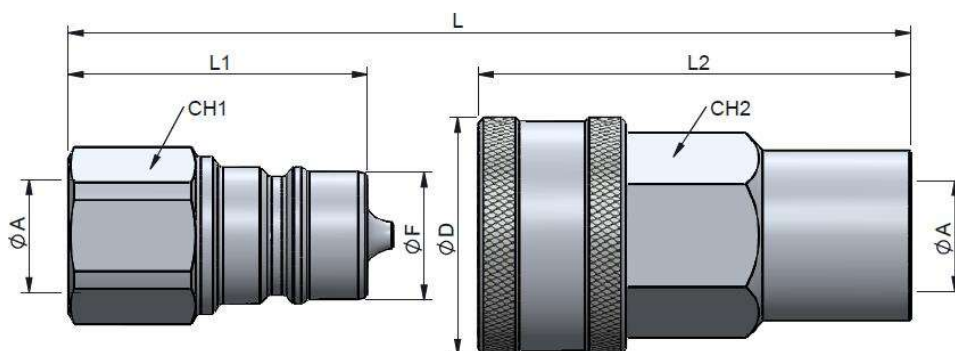

STANDARD MALE MODELS

(S)	ØA	REF.		CH1	L1	ØF	L
10	3/8" BSP	101.21122AC		22	40.5	17	81
	3/8" NPTF	101.21122BC					
	3/8" BSPT	101.21122DC					
	9/16"-18h UNF (ORB)	101.21122GC					

STANDARD FEMALE MODELS

(S)	ØA	REF.		CH2	L2	ØD	L
10	3/8" BSP	101.22122AC		24	58.50	32	81
	3/8" NPTF	101.22122BC					
	3/8" BSPT	101.22122DC					
	9/16"-18h UNF (ORB)	101.22122GC					

L= Total length when Male and Female are connected.

101-8

INTEVA reserves the right to make modifications to its products without prior notice. Any external or internal alterations to our products will automatically void the warranty.





101 SERIES

ISO-A SS316

(S) 13 - 1/2"

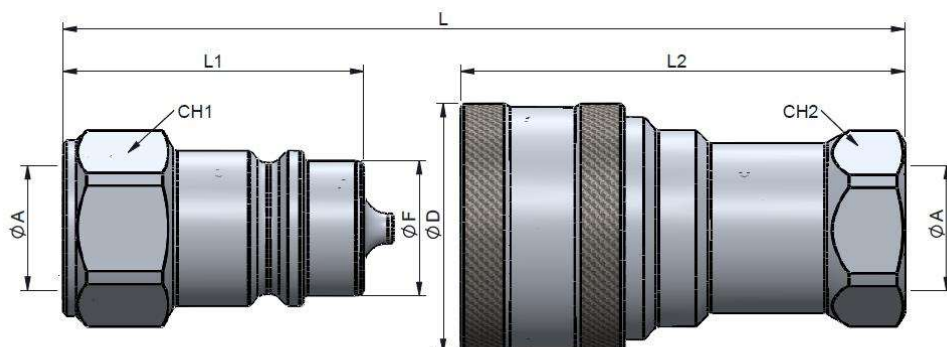

STANDARD MALE MODELS

(S)	ØA	REF.		CH1	L1	ØF	L
13	1/2" BSP	101.21123AD		27/30	46	20.50	87.50
	1/2" NPTF	101.21123BD					
	M22X1.5	101.21123NG		27/30			
	3/4"-16h UNF (ORB)	101.21123GF		27/30			
	7/8"-14h UNF (ORB)	101.21123GH		27/30			

STANDARD FEMALE MODELS

(S)	ØA	REF.		CH2	L2	ØD	L
13	1/2" BSP	101.22123AD		30	63.50	38	87.50
	1/2" NPTF	101.22123BD					
	M22X1.5	101.22123NG					
	3/4"-16h UNF (ORB)	101.22123GF					
	7/8"-14h UNF (ORB)	101.22123GH					

(S) 20 - 3/4"

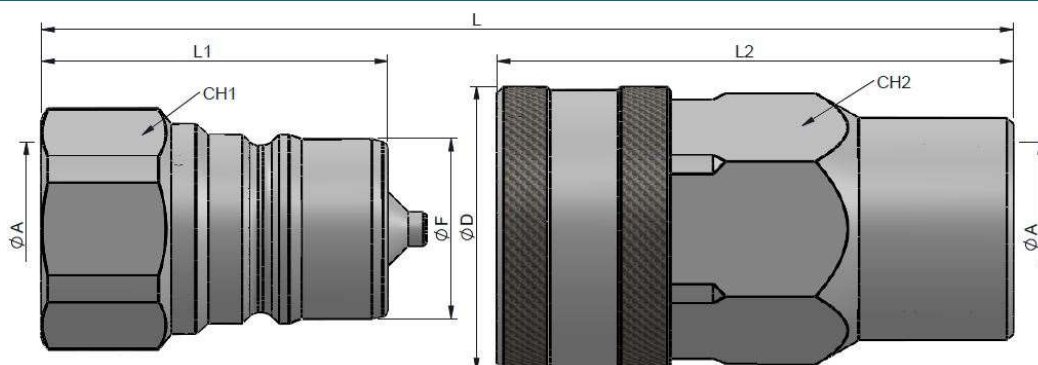

STANDARD MALE MODELS

(S)	ØA	REF.		CH1	L1	ØF	L
20	3/4" BSP	101.21124AE		36	56	29	112
	3/4" NPTF	101.21124BE					
	1 1/16"- 12h UN (ORB)	101.21124GK					

STANDARD FEMALE MODELS

(S)	ØA	REF.		CH2	L2	ØD	L
20	3/4" BSP	101.22124AE		38	83.5	46	112
	3/4" NPTF	101.22124BE					
	1 1/16"- 12h UN (ORB)	101.22124GK					

L= Total length when Male and Female are connected.



101 SERIES

ISO-A SS316

(S) 25 - 1"

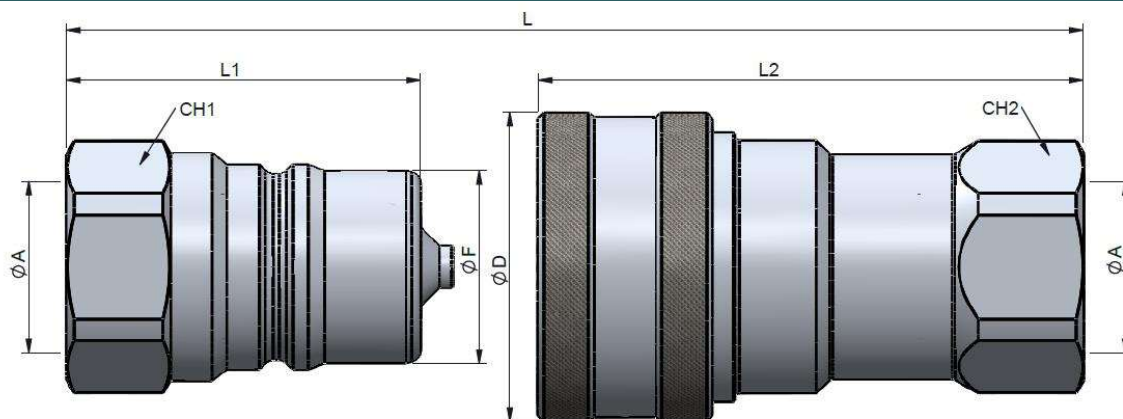

STANDARD MALE MODELS

(S)	ØA	REF.		CH1	L1	ØF	L
25	1" BSP	101.21125AF		41	63	34	126
	1" NPTF	101.21125BF					
	1 5/16"-12h UN (ORB)	101.21125GO					

STANDARD FEMALE MODELS

(S)	ØA	REF.		CH2	L2	ØD	L
25	1" BSP	101.22125AF		46	97	55	126
	1" NPTF	101.22125BF					
	1 5/16"-12h UN (ORB)	101.22125GO					

(S) 32 - 1 1/4"

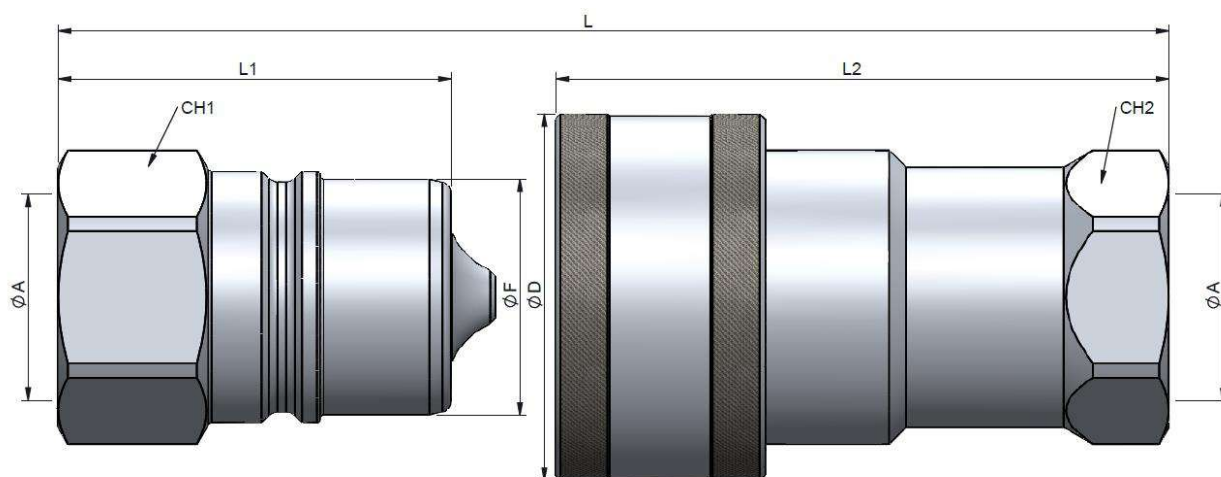

STANDARD MALE MODELS

(S)	ØA	REF.		CH1	L1	ØF	L
32	1 1/4" BSP	101.21126AG		50	75	45	150
	1 1/4" NPTF	101.21126BG					

STANDARD FEMALE MODELS

(S)	ØA	REF.		CH2	L2	ØD	L
32	1 1/4" BSP	101.22126AG		50	117	70	150
	1 1/4" NPTF	101.22126BG					

L= Total length when Male and Female are connected.

101-10

INTEVA reserves the right to make modifications to its products without prior notice. Any external or internal alterations to our products will automatically void the warranty.







101 SERIES

ISO-A SS316

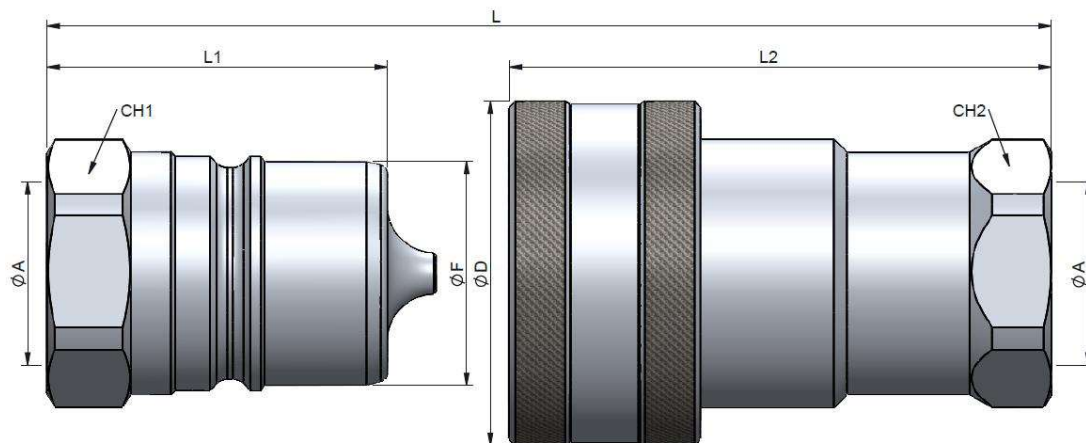

(S) 40 - 1 1/2"



STANDARD MALE MODELS

(S)	ØA	REF.		CH1	L1	ØF	L
40	1 1/2" BSP	101.21127AH		60	83	55	167
	1 1/2" NPTF	101.21127BH					



STANDARD FEMALE MODELS

(S)	ØA	REF.		CH2	L2	ØD	L
40	1 1/2" BSP	101.22127AH		60	133	84.50	167
	1 1/2" NPTF	101.22127BH					

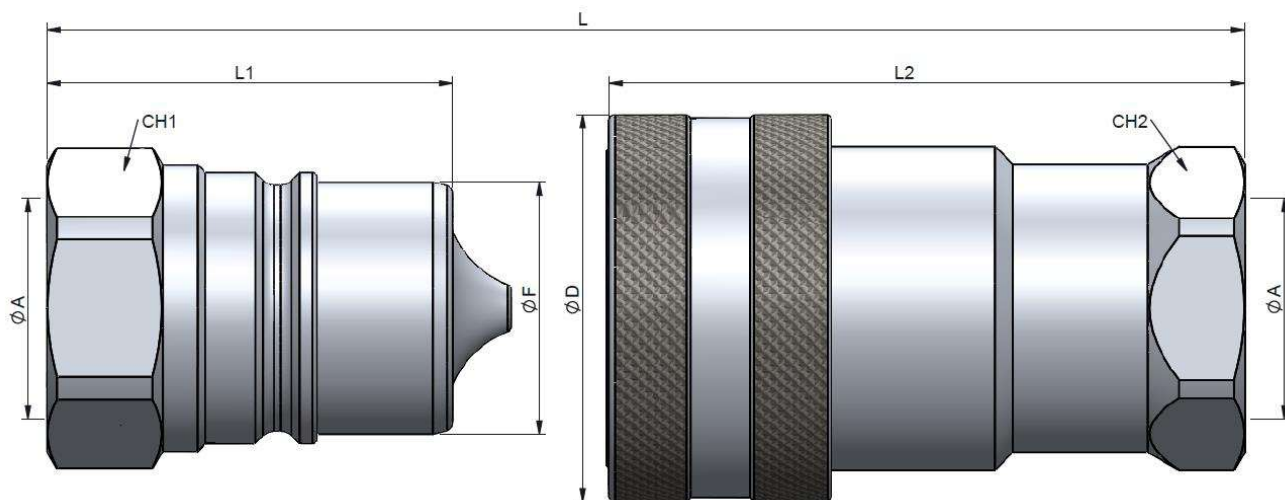

(S) 50 - 2"



STANDARD MALE MODELS

(S)	ØA	REF.		CH1	L1	ØF	L
50	2" BSP	101.21128AI		75	105	65	210
	2" NPTF	101.21128BI					

STANDARD FEMALE MODELS

(S)	ØA	REF.		CH2	L2	ØD	L
50	2" BSP	101.22128AI		75	165	100	210
	2" NPTF	101.22128BI					

L= Total length when Male and Female are connected.

101-11

INTEVA reserves the right to make modifications to its products without prior notice. Any external or internal alterations to our products will automatically void the warranty.





101 SERIES

ISO-A SS316

INTEVA

TECHNICAL DATA

(S)	Rated Flow	Min Burst Pressure (Bar)			Max. Working Pressure
		Male	Female	Coupled	
6	15 l/min	1150	1200	1250	280
10	35 l/min	16.30	1075	1200	260
13	45 l/min	1050	1150	1200	260
20	74 l/min	855	875	900	210
25	100 l/min	850	875	900	210
32	118 l/min	500	500	650	140
40	410 l/min	480	500	600	120
50	860 l/min	405	415	550	100

Test performed according to ISO 18869

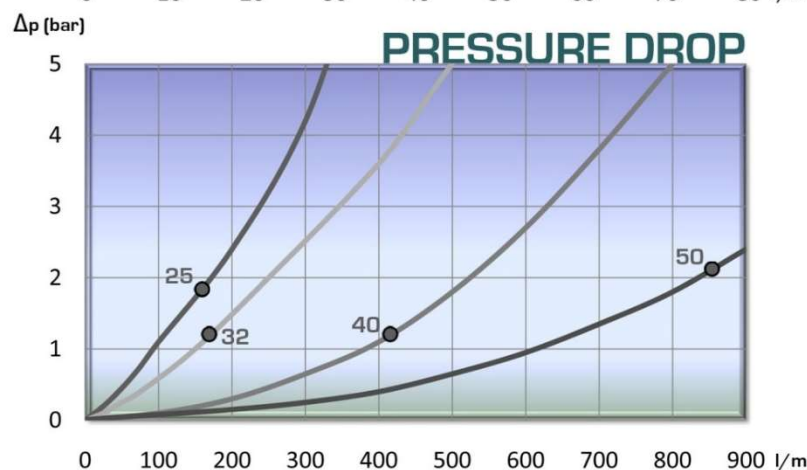
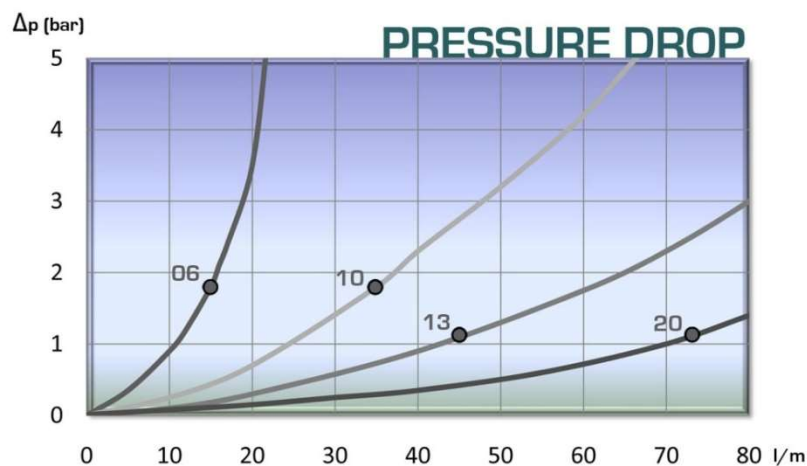

101-12

INTEVA reserves the right to make modifications to its products without prior notice. Any external or internal alterations to our products will automatically void the warranty.





101 SERIES ISO-A PLUGS & CAPS



Designed to protect female (coupler) and male (nipple) parts while they are disconnected.
Manufactured according to ISO 7241-A norm (Size 13 - ISO 5675)

MODEL STRUCTURE / DIMENSIONS

Example:

101.5313 AA

Series	Material	Part	Color	Size (S)	Type
101.	5 Plastic	3 Plug	0 Plain Metal	1 6	AA
	6 Aluminum	4 Cap	1 Red	2 10	
		5 Parking	2 Blue	3 13	
			3 Yellow	4 20	
			4 Green	5 25	
			5 Black		
			6 White		

* Other materials on request.

(S) 6 – (S) 25 – PLASTIC

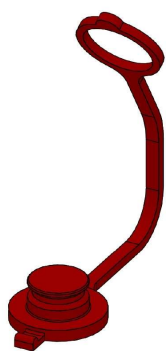

PLUG (COUPLER)

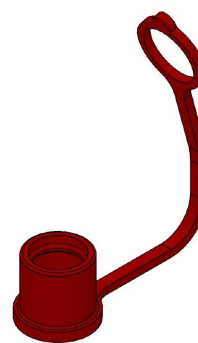

CAP (NIPPLE)

(S)	RED	BLUE	YELLOW	GREEN	BLACK	WHITE
6	101.5311AA	*	*	*	*	*
10	101.5312AA	*	*	*	*	*
13	101.5313AA	*	*	*	*	*
20	101.5314AA	*	*	*	*	*
25	101.5315AA	*	*	*	*	*

* Not available. Only (S) 13 - 1/2" on minimum request.

(S)	RED	BLUE	YELLOW	GREEN	BLACK	WHITE
6	101.5411AA	*	*	*	*	*
10	101.5412AA	*	*	*	*	*
13	101.5413AA	*	*	*	*	*
20	101.5414AA	*	*	*	*	*
25	101.5415AA	*	*	*	*	*

101-13

INTEVA reserves the right to make modifications to its products without prior notice. Any external or internal alterations to our products will automatically void the warranty.





101 SERIES

ISO-A CAPS, PLUGS & PARKINGS

Designed to protect female (coupler) and male (nipple) parts while they are disconnected.
Manufactured according to ISO 7241-A norm.

(S) 32 – (S) 50 – ALUMINUM

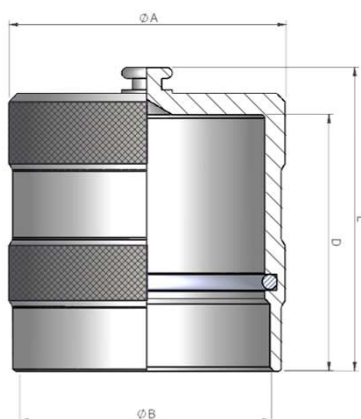

CAP (NIPPLE)

(S)	ØA	REF.	ØB	L	D
32	59	101.6406AA	48	66	55
40	64.8	101.6407AA	57.8	71	60
50	80	101.6408AA	70.2	80	75

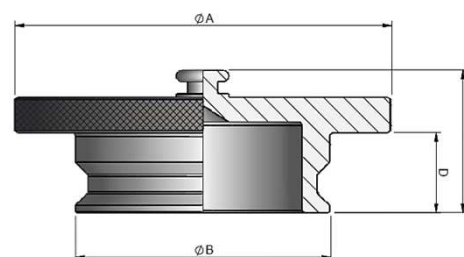

PLUG (COUPLER)

(S)	ØA	REF.	ØB	L	D
32	69.5	101.6306AA	47.7	30	16
40	84.8	101.6307AA	57.5	32	18
50	100	101.6308AA	69.8	33	25

(S) 13 – CARBON STEEL

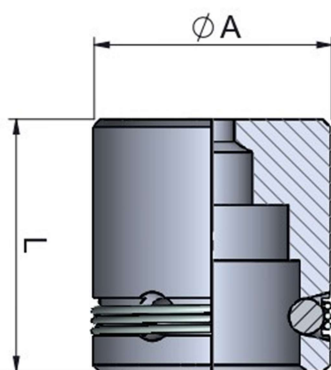

PARKING 3B

(S)	ØA	REF.	L
13	32	101.1533AA	34

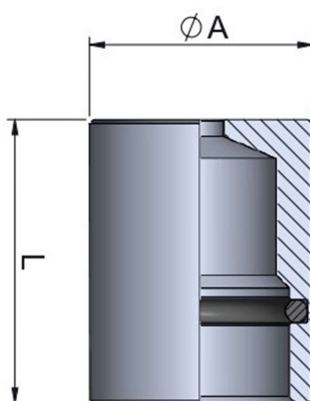

PARKING 1T

(S)	ØA	REF.	L
13	30	101.1533AC	38

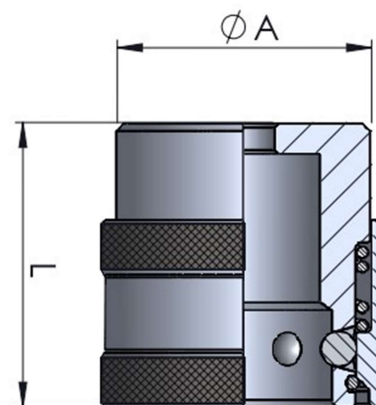

PARKING 6B

(S)	ØA	REF.	L
13	34	101.1533AA	38